

CERTIFIED RECORD OF LAND CORNER MONUMENTATION

HISTORY OF ORIGINAL CORNER ESTABLISHED:

Corner was originally established under GLO contract number No. 103, dated September 3, 1963, executed David P. Thompson. Surveyor General field notes state:

Set post 1/4 sec. corner in mound of earth with charred stake. Pins, trenches as per instructions.

Survey for Union County Road Petition 581 (Wright Road), dated August 1904, executed by Arthur Curtis calls to a rock marked R.T. at this 1/4 corner position.

T 3 S R 39 E J-03

	S	18

DESCRIPTION OF CORNER EVIDENCE FOUND:

None. Position falls at the intersection of Gekeler Lane and Wright road.

SEE SURVEY NUMBER 018-2025

DESCRIPTION OF MONUMENT AND ACCESSORIES I ESTABLISHED TO REHABILITATE THE MONUMENT AT THE ORIGINAL LOCATION OF THIS CORNER:

At the intersection of Gekeler and Wright Roads, I set a 5/8" x 30" iron pin, with 3" brass cap, marked as shown below, 30" in the ground and encased in a 4" diam. concrete plug set in the asphalt road surface, from which:

NEW BEARING OBJECTS:

- A 5/8" x 30" iron pin bears North 65°29' East, a distance of 34.06 feet, with 1 ½" aluminum cap marked UNION COUNTY SURVEYOR NE RP.
- A 5/8" x 30" iron pin bears South 17°35' East, a distance of 65.70 feet, with 1 ½" aluminum cap marked UNION COUNTY SURVEYOR SE RP.
- A 5/8" x 30" iron pin bears South 20°07' West, a distance of 51.98 feet, with 1 ½" aluminum cap marked UNION COUNTY SURVEYOR SW RP.
- A 5/8" x 30" iron pin bears North 53°41' West, a distance of 37.11 feet, with 1 ½" aluminum cap marked UNION COUNTY SURVEYOR NW RP.

Fence corner bears approx. 30 feet North from which fences run North and East along the right of way.

I hereby certify that the corner was monumented on April 1, 2025

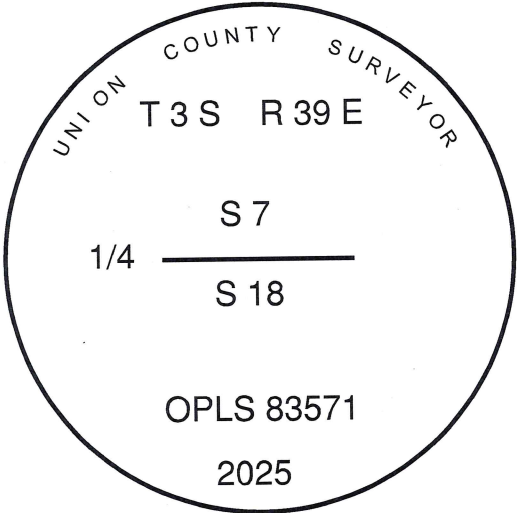

REGISTERED
PROFESSIONAL
LAND SURVEYOR



OREGON
June 2, 2010

JEFFREY S. HSU
83571

Renewal Date: June 30, 2025

I used RTK GPS in the establishment of the accessories. Bearing and distances are to the center of the aluminum caps. Basis of bearings is as per Survey Number 018-2025.

UNION COUNTY
SURVEYOR

Date Received 4/28/25

Date Filed 4/28/25

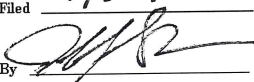
Filed By 

File Number 001-2025R

HORIZONTAL CONTROL DATA
UNION COUNTY, OREGON
OREGON STATE PLANE, NORTH ZONE (3601)

STA NAME: 2025005

QUARTER CORNER COMMON TO SECTIONS 7 AND 18

TWP. 3 S RGE. 39 E

GEODETIC COORD: NAD 83(91)

DATE TIED: April 1, 2025

LAT: 45 ° 18 ' 41.13148 " N

SURVEYOR: JEFFREY S. HSU
OPLS 83571

LONG: 117 ° 59 ' 2.38119 " W

FIRM: BAGETT, GRIFFITH, & BLACKMAN
2006 ADAMS AVENUE
LAGRANDE, OR 97850
(541) 963-6092

SP. COOR: NAD 83(91)

N: 609710.828 INT FT.

E: 8849243.375 INT FT.

TYPE: GPS

THETA: 1 ° 47 ' 3.5 "

ORDER: SECOND CLASS: 1

SCALE FACTOR: 0.999897676

ELEV: 2700.65 US FT.

ELEV: DATUM: NGVD 29

COMMENTS:

3" Brass Cap marked as shown in center of road

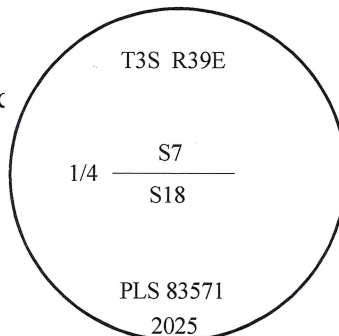

Renewal Date: June 30, 2025

1 METER = 3.280833333... US FEET = 39.37 INCHES

1 METER = 3.280839895 INT'L FEET OR 1 INCH = 2.54 CM

TO CALCULATE ELEVATION FACTOR (IN THE NORTH AMERICAN CONTINENT)

DIVIDE 20,906,000 BY (20,906,000 + ELLIPSOID ELEV. IN FEET)

GEOID MODEL : 2012B