

UNION COUNTY SURVEYOR

CERTIFIED RECORD OF LAND CORNER MONUMENTATION

HISTORY OF ORIGINAL CORNER ESTABLISHMENT:

Corner originally established by David P. Thompson, under GLO Contract Number 103, dated September 3, 1863. Surveyor General record states:
Set Post for corner

An 18" Pine bears N 62°E, 77 lks.
A 24" Pine bears N 66° W, 16 lks.

No record of subsequent monumentation found in the Union County monumentation records

DESCRIPTION OF CORNER EVIDENCE FOUND:

No original evidence found

See Survey Number 026-2002

DESCRIPTION OF MONUMENT AND ACCESSORIES I ESTABLISHED TO PERPETUATE THE ORIGINAL LOCATION OF THIS CORNER:

At the proportioned position, I set a 2½"x30" Aluminum Cap, marked as shown, 25 inches in the ground, and raised a mound of stone with a 2 foot base to the top of the cap, from which
NEW BEARING TREES:

A 10" diameter Ponderosa Pine bears North 41° East, a distance of 48.97 feet marked 1/4 S33 BT.

A 9" diameter Western Larch bears South 57° East, a distance of 14.20 feet, marked 1/4 S 33 BT

A 10" diameter Douglas Fir bears South 48° West, a distance of 59.07 feet, marked 1/4 S32 BT

A 16" diameter Ponderosa Pine bears North 51° West, a distance of 42.00 feet, marked 1/4 S32 BT.

I hereby certify that the corner was monumented on July 12, 2002
Witness: Norbert Volny and Greg Blackman Jr.

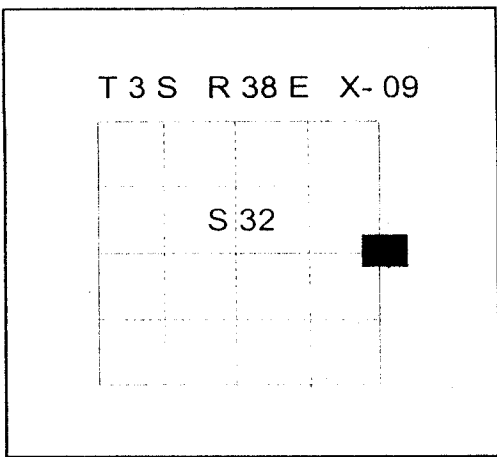

REGISTERED
PROFESSIONAL
LAND SURVEYOR

Gregory T. Blackman

OREGON
JULY 13, 1973

GREGORY T. BLACKMAN
991

Renewal Date: December 31, 2003

BAGETT - GRIFFITH & BLACKMAN

T 3 S R 38 E

1/4

S 32 | S 33

2002

OPLS 991

**UNION COUNTY
SURVEYOR**

Date Received 7/19/02

Date Filed 7/19/02

Filed By R. ROBINSON DEWITT

File Number 013-2002R

I used a steel tape and magnetic compass in the establishment of the new accessories. I used 18° East declination, the distances are to a 60d spike driven into the right side of the root crown of the bearing tree. I attached a brass washer marked OPLS 991 to the BT blaze.

HORIZONTAL CONTROL DATA

UNION COUNTY, OREGON

OREGON STATE PLANE, NORTH ZONE (3601)

STA NAME: 2017022

1/4 SECTION CORNER COMMON TO SECTIONS 32 AND 33

TWP. 3 S RGE. 38 E.

GEODETIC COORD: NAD 83(91)

DATE TIED: October 20, 2017

LAT: 45 ° 15 ' 37.08005 " N

SURVEYOR: RICK G. ROBINSON
OPLS 2219

LONG: 118 ° 4 ' 33.05660 " W

FIRM: BAGETT, GRIFFITH, & BLACKMAN
2006 ADAMS AVENUE
LAGRANDE, OR 97850
(541) 963-6092

SP. COOR: NAD 83(91)

N: 590357.266 INT FT.

E: 8826183.893 INT FT.

TYPE: GPS

THETA: 1 ° 43 ' 9.02622819 "

ORDER: SECOND CLASS: 1

SCALE FACTOR: 0.9998958561

ELEV: 4659.44 US FT.

ELEV: DATUM: NGVD 29

COMMENTS:

2 1/2" aluminum pipe with 2 1/2" aluminum cap marked as shown, set in mound of stone.

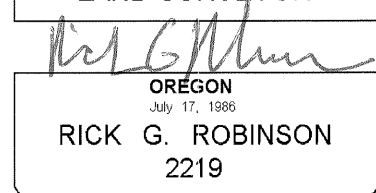
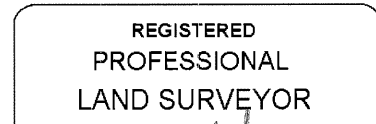
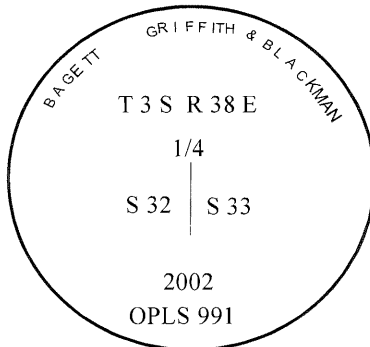

Renewal Date: December 31, 2018

1 METER = 3.2808333333... US FEET = 39.37 INCHES

1 METER = 3.280839895 INT'L FEET OR 1 INCH = 2.54 CM

TO CALCULATE ELEVATION FACTOR (IN THE NORTH AMERICAN CONTINENT)

DIVIDE 20,906,000 BY (20,906,000 + ELLIPSOID ELEV. IN FEET)