

CERTIFIED RECORD OF LAND CORNER MONUMENTATION

HISTORY OF ORIGINAL CORNER ESTABLISHMENT:

Corner originally established by David P. Thompson under GLO contract number 103, dated September 3, 1863 Surveyor General record states: Set Stone 24x18x15 in for corner to secs 21, 22, 27 and 28. Near small spring.

Corner ties by A.H. McLain in Surveys 28, 29 and 141. Monument not described.

Corner was not found by Howard Perry in Survey Number 28-80.

Norm Paullus Jr. finds 25"x18"x15" stone in Survey Number 007-1996. Does not bring to county standard.

No record of subsequent monumentation found in Union County survey records.

T 3 S R 38 E R-13

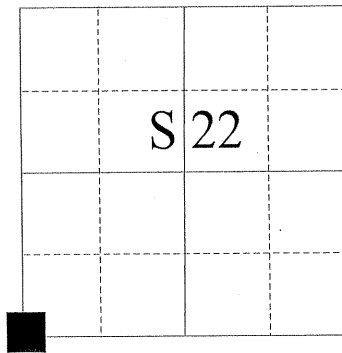

DESCRIPTION OF CORNER EVIDENCE FOUND:

At position determined by retracement of Survey Number 007-1996, I find an unnatural depression in the ground 2 feet West of an existing fence corner from which fencelines run North, South and East. A stone of matching size falls in a mound used as a brace for a gate, posts for said gate appear to indicate recent construction. No marks could be found on the stone.

DESCRIPTION OF MONUMENT AND ACCESSORIES I ESTABLISHED TO PERPETUATE THE ORIGINAL LOCATION OF THIS CORNER:

At the position of the depression, I set a 2 1/2" x 30" aluminum pipe monument, with 2 1/2" aluminum cap marked as shown below, 28 inches in the ground, with collar of stone 2 ft. diam., from which:

A 5/8" x 30" iron pin bears North 68°20' East, a distance of 7.61 feet with 1 1/2" aluminum cap marked UNION COUNTY SURVEYOR E RP.

A 5/8" x 30" iron pin bears South 9°38' East, a distance of 13.90 feet, with 1 1/2" aluminum cap marked UNION COUNTY SURVEYOR S RP.

A 5/8" x 30" iron pin bears South 86°59' West, a distance of 19.91 feet, with 1 1/2" aluminum cap marked UNION COUNTY SURVEYOR W RP.

A 5/8" x 30" iron pin bears North 18°36' West, a distance of 20.84 feet, with 1 1/2" aluminum cap marked UNION COUNTY SURVEYOR N RP.

I hereby certify that the above corner point was monumented on April 3, 2014.

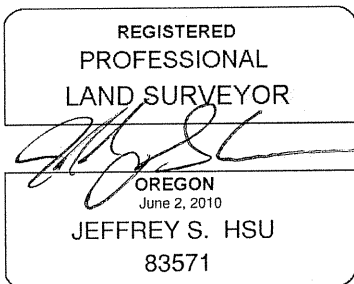

Renewal Date: June 30, 2015

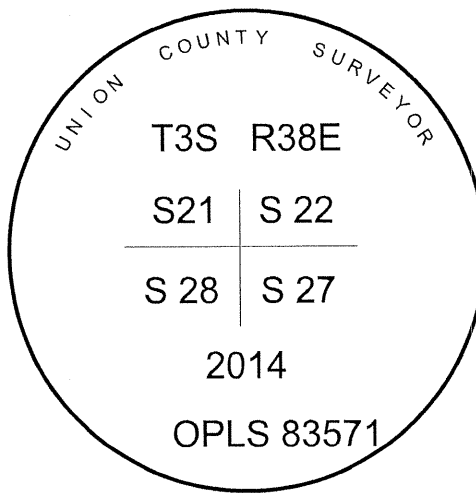

UNION COUNTY SURVEYOR stamp with fields: Date Received 4/11/14, Date Filed 4/11/14, Filed By [Signature], File Number 013-2014R

I used a Leica RTK GPS in the establishment of the accessories. Basis of bearings is as per Survey Number 040-2003. Bearings and distances are to the center of the aluminum cap.

HORIZONTAL CONTROL DATA

UNION COUNTY, OREGON

OREGON STATE PLANE, NORTH ZONE (3601)

STA NAME: 201409

SECTION CORNER COMMON TO SECTIONS 21, 22, 27 and 28

TWP. 3 S. RGE. 38 E.

GEODETIC COORD: NAD 83(91)

DATE TIED: April 3, 2014

LAT: 45 ° 16 ' 55.68502 " N

SURVEYOR: RICK G. ROBINSON
OPLS 2219

LONG: 118 ° 3 ' 20.18290 " W

FIRM: BAGETT, GRIFFITH, & BLACKMAN
2006 ADAMS AVENUE
LAGRANDE, OR 97850
(541) 963-6092

SP. COOR: NAD 83(91)

N: 598471.255 INT FT.

E: 8831152.860 INT FT.

TYPE: GPS

THETA: 1 ° 44 ' 0.70723706 "

ORDER: SECOND CLASS: 1

SCALE FACTOR: 0.9998965361

ELEV: 2902.75 US FT.

ELEV: DATUM: NGVD 29

COMMENTS:

Corner falls on East slope 2 ft. West
of an existing fence corner

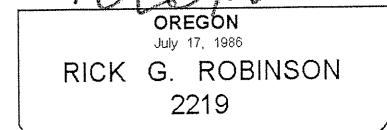
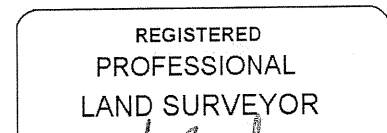
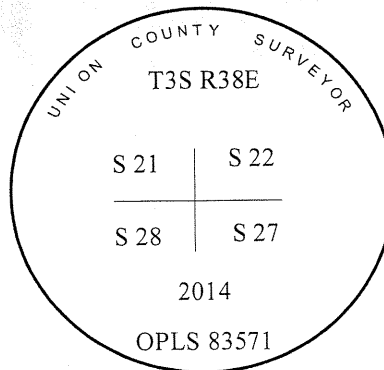

Renewal Date: December 31, 2014

1 METER = 3.2808333333... US FEET = 39.37 INCHES

1 METER = 3.280839895 INT'L FEET OR 1 INCH = 2.54 CM

TO CALCULATE ELEVATION FACTOR (IN THE NORTH AMERICAN CONTINENT)

DIVIDE 20,906,000 BY (20,906,000 + ELLIPSOID ELEV. IN FEET)