

CERTIFIED RECORD OF LAND CORNER MONUMENTATION

L-13

History of original corner establishment:

Corner originally established in 1863 under GLO contract number 103, dated September 3, 1863

Surveyor General record states:

Set post and mound of earth for 1/4 sec. cor. to sections 15 & 16

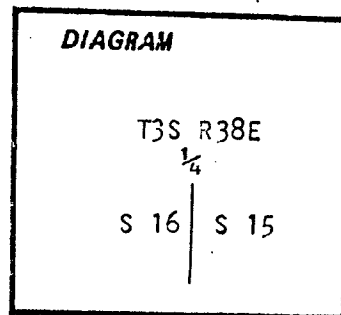

Description of corner evidence found:

NONE

Description of monument and accessories I established to perpetuate the original location of this corner:

At proportionate distance, I set a 2 1/2 inch x 30 inch aluminum pipe with aluminum cap marked as shown, set flush with the ground.

Set steel fence post North 9.9 feet

East-West fenceline is 12 feet North of corner

Corner set September 1, 1983

Witness: Greg Blackman

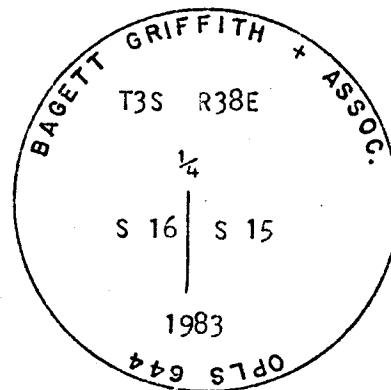

REGISTERED PROFESSIONAL LAND SURVEYOR

Duane I. Griffith

OREGON
JULY 10, 1984
DUANE I. GRIFFITH
644

I used a steel tape and magnetic compass in the establishment of accessories. I used 20° East magnetic declination, and distances to the new BTs are to the center of the tree. I placed a brass washer marked OPLS 644 by the BT blaze of new BTs.

Office of..... County of.....
State of....., I hereby certify that the within instrument was filed in this office
for record on the..... day of....., 19.....

(COUNTY OFFICIAL)

(DEPUTY)

Form R6-7100-57 (9/71)

UNION COUNTY SURVEYOR

Date Received 9-6-83

★ OPO-708-276

Date Filed 9-12-83

By G. LANGLITZ, DEPUTY

File No. 330-83 R

UNION COUNTY SURVEYOR

CERTIFIED RECORD OF LAND CORNER MONUMENTATION

History of original corner establishment:
Corner originally established by David T. Thompson under GLO contract Number 103, dated September 3, 1863. Surveyor General record states: Set post, in mound of earth.

Monumentation Record 330-83R states setting a 2½" x 30" aluminum pipe monument as per survey 31-83.

Survey 9-85 calls finding aluminum monument as per survey 31-83.

No record of subsequent monumentation found in Union County survey records.

Description of corner evidence found:

Found aluminum pipe monument as per survey 31-83 torn from the ground.

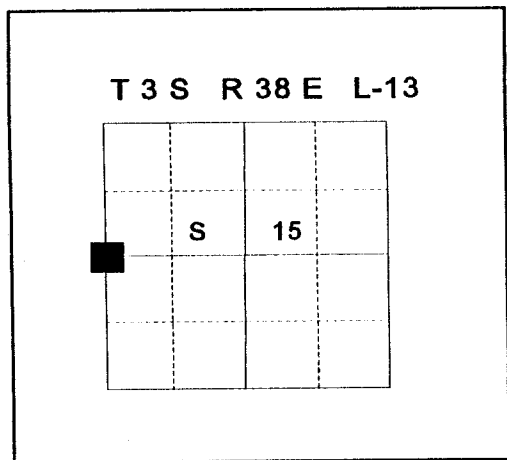

Description of monument and accessories I established to perpetuate the original location of this corner:

At the corner position as per survey 31-81 I set a 2½" x 30" aluminum pipe with 2½" aluminum cap marked as shown below, 36" in the ground, from which:

- A 60d spike driven into the SE side of a 46" triple boled cottonwood tree bears N80°E, 21.45 feet.
- A 5/8"x30" rebar with 1½" aluminum cap bears S21°E, 22.41 feet, marked UNION COUNTY SURVEYOR SE RP.
- A 5/8"x30" rebar with 1½" aluminum cap bears S51°W, 31.78 feet, marked UNION COUNTY SURVEYOR SW RP.
- A 5/8"x30" rebar with 1½" aluminum cap bears N33°W, 14.12 feet, marked UNION COUNTY SURVEYOR NW RP.

I hereby certify that the corner was monumented on March 26, 1996.
Witness: Mark Durbin, Jeff Madsen

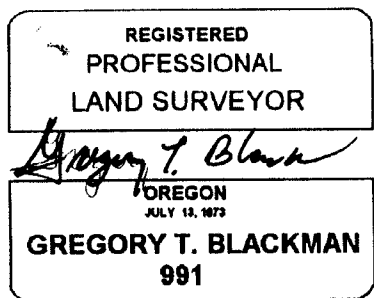

Personal Date: December, 31 1997

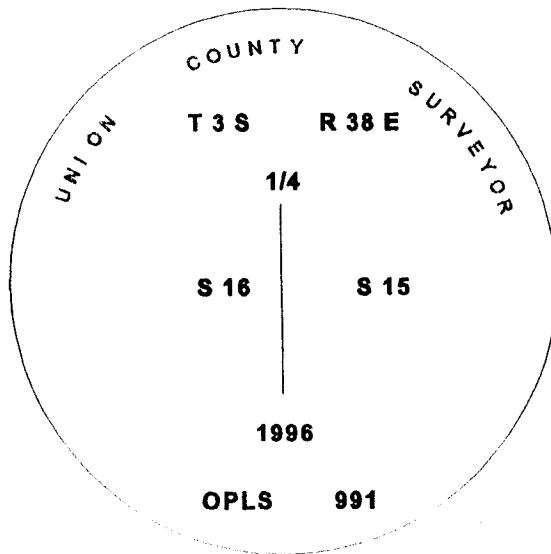

UNION COUNTY SURVEYOR

Date Received 4-22-96

Date Filed 4-22-96

Filed By A. Peterson, Deputy

File Number 053-1996 R

I used a steel tape and magnetic compass in the establishment of the new accessories. I used 17° East declination.

HORIZONTAL CONTROL DATA

OREGON STATE PLANE, NORTH ZONE (3601)

LaGRANDE & ISLAND CITY, UNION COUNTY OREGON

STA. NAME: 9640

QUARTER CORNER TO: 16 / 15

TWP.3S, RGE.38E, W.M.

DATE FD.: MARCH, 1996

SURVEYOR: WALTER L. CASWELL
PLS 737

FIRM: EAGLE GPS SURVEY CORP
6110 S.W. LOMBARD AVE.
BEAVERTON, OR. 97008
(503) 643-1073

TYPE: GPS

ORDER: SECOND CLASS: 2

GEODETIC COOR: NAD 83(91)

LAT: 45°18'14.25433" N

LONG: 118°03'19.36630" W

SP. COOR: NAD 83(91)

N: 606426.416 INT.FT.

E: 8830970.484 INT.FT.

THETA: 1°44'01.286"

SCALE FACTOR: 0.999897361

ELEV: 2727.052 US.FT.

ELEV. DATUM: NGVD 29

DIRECTIONS "TO REACH"

VOID
CORNER RESET
SEE 201423

REGISTERED
PROFESSIONAL
LAND SURVEYOR

Walter L. Caswell

OREGON
JULY 8, 1966
WALTER L. CASWELL
737

EXPIRES 12/31/97

1 meter = 3.280833... U.S. Feet = 39.37 inches exactly
1 meter = 3.280839895 Intl. Feet or 1 inch = 2.54cm. exactly
To Calculate Elevation Factor (in the North American Continent)
Divide 20,906,000 by (20,906,000 + Ellipsoid Elev. in Feet)

JOB 96-007

SHEET 62 OF 66

CERTIFIED RECORD OF LAND CORNER MONUMENTATION

L-13
T 3 S R 38 E

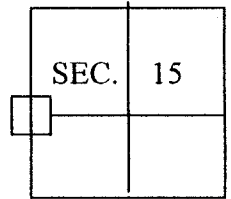

History of original corner establishment:

Corner was originally established by David T. Thompson under GLO contract Number 103, dated September 3, 1863. Surveyor General record states: set post, in mound of earth.

Monumentation Record 330-83R states setting a 2 1/2"x30" aluminum monument as per survey 31-83.

Union County Surveyor found this monument torn from the ground in 1996 where a 2 1/2"x30" aluminum pipe with a 2 1/2" aluminum cap, set 36" in the ground, was set at the corner position as per survey 31-83. In addition, four reference monuments were established. Refer to file number 053-1996R for detailed information regarding references set.

No record of subsequent monumentation found in Union County survey records.

Description of corner evidence found:

"Land Corner Monumentation" data sheet, file number 053-1996, indicates driving a 60d spike in a cottonwood tree for the NE RP. Trees throughout this area have since been cut, piled up and partially burned. The location of the NW RP, a set pin and cap, and the 1/4 corner itself, also falls within this same disturbed area. No evidence of these monuments were found and appears to have been destroyed during the tree cutting operation. The SW and SE references were found being in sound and undisturbed condition.

Description of monument and accessories established to perpetuate the original location of this corner:

No monuments or accessories were set during this visit. This is being submitted as a "Report of Condition" only.

UNION COUNTY SURVEYOR

Date Received 12/9/02

Date Filed 12/31/02

By [Signature]

File No. 042-2002R

REGISTERED PROFESSIONAL LAND SURVEYOR

[Signature]

OREGON
JULY 10, 1996
CURTIS B. STOCKHOFF
#2765

EXPIRES JUNE 30, 2004

Office of County of

State of I hereby certify that the within instrument was filed in this office for record on the

..... day of, 19.....

..... by
(County Official) (Deputy)

UNION COUNTY SURVEYOR

CERTIFIED RECORD OF LAND CORNER MONUMENTATION

HISTORY OF ORIGINAL CORNER ESTABLISHMENT:

Corner originally established by David T. Thompson under GLO contract Number 103, dated September 3, 1863. Surveyor General record states: Set post, in mound of earth.

Monumentation Record 330-83R states setting a 2½" x 30" aluminum pipe monument as per survey 31-83.

Survey 9-85 calls finding aluminum monument as per survey 31-83.

Monumentation Record 053-1996R states the monument was torn from the ground and set 2½" x 30" aluminum pipe with 2½" aluminum cap from which: A 60d spike driven into the SE side of a 46" triple boled cottonwood tree bears N80°E, 21.45 feet. A 5/8"x30" rebar with 1½" aluminum cap bears S21° E, 22.41 feet, marked UNION COUNTY SURVEYOR SE RP. A 5/8"x30" rebar with 1½" aluminum cap bears S51° W, 31.78 feet, marked UNION COUNTY SURVEYOR SW RP.

A 5/8"x30" rebar w/ 1½" alum. cap bears N33°W, 14.12 feet, marked UNION COUNTY SURVEYOR NW RP. In 1996, the corner was found and the position documented by GPS observation #9640 by Walter L. Caswell. Monument Record 042-2002R could find no evidence of the corner monument or Northerly references. The Southerly references were found.

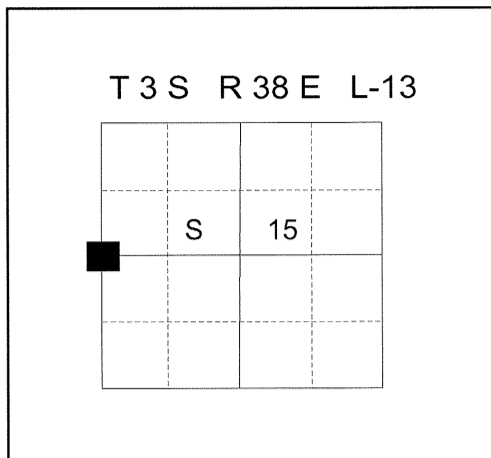

No record of subsequent monumentation found in Union County survey records.

DESCRIPTION OF CORNER EVIDENCE FOUND:

Found Southerly references of monumentation record 053-1996R

DESCRIPTION OF MONUMENT AND ACCESSORIES I ESTABLISHED TO PERPETUATE THE ORIGINAL LOCATION OF THIS CORNER:

At the corner position as located and documented by GPS observation 9640. I set a 2½" x 30" aluminum pipe with 2½" aluminum cap marked as shown below, 40" in the ground, from which:

New References:

A 5/8"x30" iron pin with 1½" aluminum cap bears North 59°24' East, 25.50 feet, marked UNION COUNTY SURVEYOR NE RP set in East-West fence line.

A 5/8"x30" iron pin with 1½" aluminum cap bears North 47°26' West, 20.15 feet, marked UNION COUNTY SURVEYOR NW RP set in East-West fence line.

(References from monumentation record 053-1996R)

A 5/8"x30" iron pin with 1½" aluminum cap bears South 19°16' East, 22.59 feet, marked UNION COUNTY SURVEYOR SE RP.

A 5/8"x30" iron pin with 1½" aluminum cap bears South 48°45' West, 32.39 feet, marked UNION COUNTY SURVEYOR SW RP.

I hereby certify that the corner was perpetuated on October 7, 2014

Witness: Thomas J. Kopp

REGISTERED
PROFESSIONAL
LAND SURVEYOR

OREGON
July 17, 1986
RICK G. ROBINSON
2219

Renewal Date: December 31, 2014

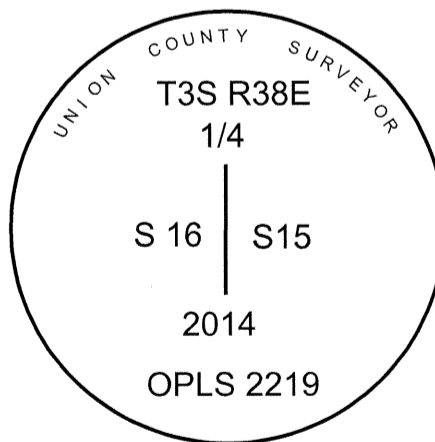

UNION COUNTY SURVEYOR

Date Received 10/9/14

Date Filed 10/9/14

Filed By [Signature]

File Number 056-2014R

I used a Leica Viva GS14 GPS unit in the establishment of the new accessories. I used the same basis of bearing as Union County Partition Plat Number 20140006T.

HORIZONTAL CONTROL DATA

UNION COUNTY, OREGON

OREGON STATE PLANE, NORTH ZONE (3601)

STA NAME: 201423

1/4 SECTION CORNER COMMON TO SECTIONS 15 AND 16

TWP. 3 S. RGE. 38 E.

GEODETIC COORD: NAD 83(91)

DATE TIED: October 7, 2014

LAT: 45 ° 18 ' 14.25453 " N

SURVEYOR: RICK G. ROBINSON
OPLS 2219

LONG: 118 ° 3 ' 19.36701 " W

FIRM: BAGETT, GRIFFITH, & BLACKMAN
2006 ADAMS AVENUE
LAGRANDE, OR 97850
(541) 963-6092

SP. COOR: NAD 83(91)

N: 606426.434 INT FT.

E: 8830970.433 INT FT.

TYPE: GPS

THETA: 1 ° 44 ' 1.28585975 "

ORDER: SECOND CLASS: 1

SCALE FACTOR: 0.9998973607

ELEV: 2726.63 US FT.

ELEV: DATUM: NGVD 29

COMMENTS:

Corner monument is set 12" below ground
in field 9+/- ft. South of E-W fenceline

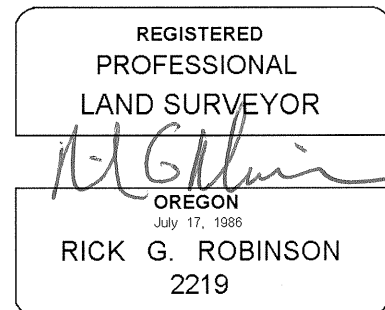
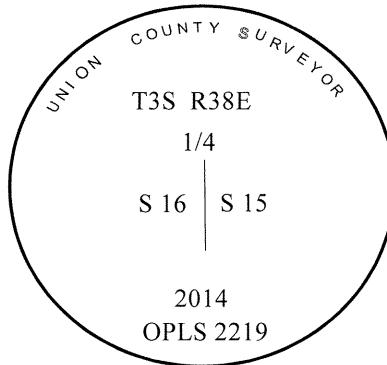

Renewal Date: December 31, 2014

1 METER = 3.2808333333... US FEET = 39.37 INCHES

1 METER = 3.280839895 INT'L FEET OR 1 INCH = 2.54 CM

TO CALCULATE ELEVATION FACTOR (IN THE NORTH AMERICAN CONTINENT)

DIVIDE 20,906,000 BY (20,906,000 + ELLIPSOID ELEV. IN FEET)