

CERTIFIED RECORD OF LAND CORNER MONUMENTATION

HISTORY OF ORIGINAL CORNER ESTABLISHMENT:

Corner originally established by David P. Thompson under GLO contract number 103, dated September 3, 1863 Surveyor General record states:

Set post for 1/4 cor in mound of stone.

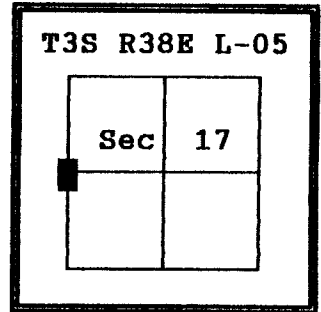

DIAGRAM

No record of subsequent monumentation found in Union County survey records.

DESCRIPTION OF CORNER EVIDENCE FOUND:

NONE

There is a north-south fence line 9 feet West.

See Map of Survey No. 022-1993.

DESCRIPTION OF MONUMENT AND ACCESSORIES I ESTABLISHED TO PERPETUATE THE ORIGINAL LOCATION OF THIS CORNER:

At proportionate position as determined by survey I set a 2 1/2" x 36" aluminum pipe with aluminum cap marked as shown, 25 inches in the ground, from which:

A 30" Ponderosa Pine bears N 87° E, 38.56 feet, marked 1/4 S17 BT

A 5/8" x 30" rebar bears N 33°W, 13.46 feet, with 2" aluminum cap marked "UNION COUNTY SURVEYOR NW RP

A 38" X 23" X 18" Basalt rock bears S 39°W, 11.49 feet, marked X BO

A 13" Ponderosa Pine bears N 18°E, 71.95 feet, marked X BT

Set steel fence post 5'± East with Land Corner Monument sign.

Raised a mound of stone 3 foot base to top of cap.

I hereby certify that the above corner point was perpetuated as hereon described on June 21, 1993.

Witnesses: Jeff Petersen
Jim Bennett
Pete Crabtree

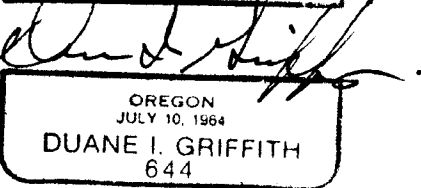
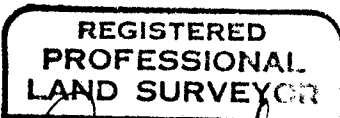
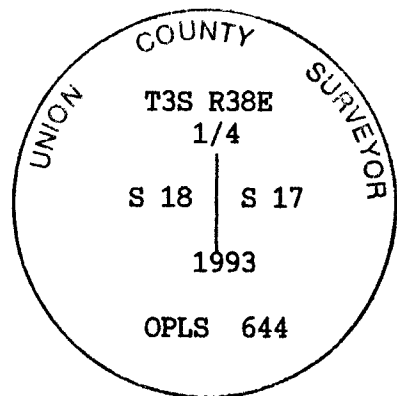

UNION COUNTY SURVEYOR

Date Received 6-30-93

Date Filed 6-30-93

By R. ROBINSON, DEPUTY

File No. 020-1993R

I used a steel tape and magnetic compass in the establishment of new accessories. I used 20° East magnetic declination and the distances are to a 60d spike driven in the right side at the root crown.

HORIZONTAL CONTROL DATA

UNION COUNTY, OREGON
OREGON STATE PLANE, NORTH ZONE (3601)

STA. NAME: 9315

QUARTER CORNER: 18 / 17

TWP. 3 S. RGE. 38 E.

DATE SET: OCT. 1993

SURVEYOR: WALTER L. CASWELL
PLS 737

FIRM: EAGLE GPS SURVEY CORP
13545 NW SCIENCE PARK
PORTLAND, OR. 97229
(503) 643-1073

GEODETIC COOR: NAD 83(91)

LAT: 45°18'14.64117" N

LONG: 118°05'47.81528" W

SP. COOR: NAD 83(91)

N: 606147.305 INT.FT.

E: 8820364.691 INT.FT.

THETA: 1°42'16.008"

TYPE: GPS

SCALE FACTOR: 0.999897365

ORDER: SECOND CLASS: 1

ELEV: 3142.71 US.FT.

ELEV. DATUM: NGVD 29

DIRECTIONS "TO REACH": FROM GEKELER LANE ("C" STREET) AND SECOND STREET GO SOUTH ON SECOND STREET 0.2 MILES TO TWO "DEAD END" SIGNS WHERE THE ROAD TURNS TO GRAVEL. CONTINUE 0.25 MI. SOUTHERLY UP THE ROAD TO A WATER RESERVOIR AND A GATE. GO THROUGH THE GATE AND ACROSS A FAIRLY FLAT PASTURE-LIKE AREA AND YOU WILL COME TO ANOTHER GATE. GO THROUGH THE GATE AND CONTINUE UPHILL. AT ABOUT 0.2 MILES FROM THE SECOND GATE THE ROAD WILL LEVEL OUT FOR A BIT AS IT GOES THROUGH SOMETHING LIKE A SMALL CLEARING. STOP HERE. A FENCE SHOULD NOW BE VISIBLE TO YOUR LEFT. A "LAND SURVEY MONUMENT" SIGN AND A BEARING SHOULD ALSO BE VISIBLE JUST ON THE OTHER SIDE OF THE FENCE. THE MONUMENT IS A 5/8" IRON ROD WITH A 2 1/2" ALUMINUM CAP ABOUT 6 FEET TO THE EAST OF THE FENCE.

REGISTERED
PROFESSIONAL
LAND SURVEYOR

Walter L. Caswell
OREGON
JULY 8, 1966
WALTER L. CASWELL
737

EXPIRES 12/31/95

1 METER = 3.280833333333... U.S. FEET = 39.37 INCHES
1 METER = 3.280839895 INT'L FEET OR 1 INCH = 2.54 CM.
TO CALCULATE ELEVATION FACTOR (IN THE NORTH AMERICAN CONTINENT)
DIVIDE 20,906,000 BY (20,906,000 + ELLIPSOID ELEV. IN FEET)
SHEET 16 OF 37

HISTORY OF ORIGINAL CORNER ESTABLISHMENT:

Corner originally established by David P. Thompson under GLO contract number 103, dated September 3, 1863 Surveyor General record states:
Set post for 1/4 cor in mound of stone.

T 3 S R 38 E L - 05

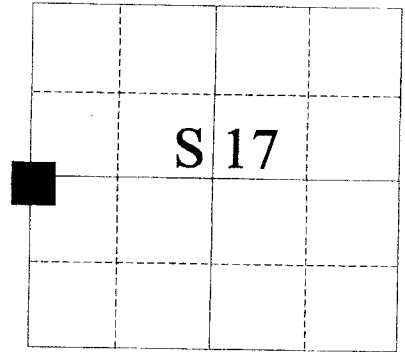

Corner proportioned in by Survey No. 022-1993 states:

- At proportionate position as determined by survey I set a 2½" x 36" aluminum pipe with aluminum cap marked as shown, 25 inches in the ground, from which:
 - A 30" Ponderosa Pine bears N 87° E, 38.56 feet, marked "1/4 S17 BT"
 - A 5/8" x 30" rebar bears N 33°W, 13.46 feet, with 2" aluminum cap marked "UNION COUNTY SURVEYOR NW RP"
 - A 38" X 23" X 18" Basalt rock bears S 39°W, 11.49 feet, marked "X BO"
 - A 13" Ponderosa Pine bears N 18°E, 71.95 feet, marked "X BT"
- Set steel fence post 5'± East with Land Corner Monument sign.
- Raised a mound of stone 3 foot base to top of cap.

No record of subsequent monumentation found in Union County survey records.

DESCRIPTION OF CORNER EVIDENCE FOUND:

Found monument and all accessories set by Survey No. 022-1993. Monument is away from true position as shown on Survey No. 020-2000

See Survey No. 020-2000

DESCRIPTION OF MONUMENT AND ACCESSORIES I ESTABLISHED TO PERPETUATE THE ORIGINAL LOCATION OF THIS CORNER:

At proportionate position as determined by Survey No. 020-2000 I reset a 2½" x 30" aluminum pipe with brass cap marked as shown, 26 inches in the ground, from which:

- A 31" Ponderosa Pine bears S 86° E, 40.90 feet, marked "1/4 S17 BT"
- A 5/8" x 30" rebar bears N 52°W, 7.44 feet, with 2" aluminum cap marked "UNION COUNTY SURVEYOR NW RP"
- A 38" X 23" X 18" Basalt rock bears S 17°W, 15.03 feet, marked "X BO"
- A 13" Ponderosa Pine bears N 19°E, 66.65 feet to "X", marked "X BT"

Set steel fence post 10'± Southeast with Land Corner Monument sign.
Raised a mound of stone 3 foot base to top of cap.

I hereby certify that the above corner point was perpetuated as hereon described on April 5, 2000.

Witnesses: Norbert W. Volny
Gregory T. Blackman Jr.

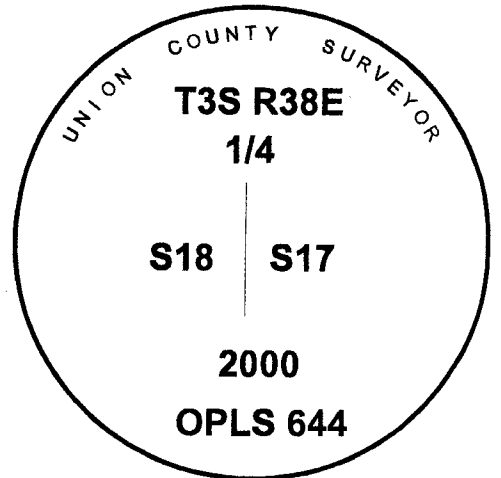

REGISTERED
PROFESSIONAL
LAND SURVEYOR

Gregory T. Blackman Jr.

OREGON
JULY 13, 1973
GREGORY T. BLACKMAN
991

Renewal Date: Dec. 31, 2001

UNION COUNTY SURVEYOR

Date Received 8/9/00

Date Filed 8/10/00

Filed By R. ROBINSON, DEPUTY

File Number 011-2000 R

I used a steel tape and magnetic compass in the establishment of new accessories. I used 18° East magnetic declination and the distances are to a 60d spike driven in the right side at the root crown or the center of aluminum cap.

HORIZONTAL CONTROL DATA
UNION COUNTY, OREGON
OREGON STATE PLANE, NORTH ZONE (3601)

STA NAME: 2018010

1/4 SECTION CORNER COMMON TO SECTIONS 17 AND 18

TWP. 3 S RGE. 38 E.

GEODETIC COORD: NAD 83(91)

DATE TIED: January 30, 2018

LAT: 45 ° 18 ' 14.70890 " N

SURVEYOR: RICK G. ROBINSON
OPLS 2219

LONG: 118 ° 5 ' 47.83824 " W

FIRM: BAGETT, GRIFFITH, & BLACKMAN
2006 ADAMS AVENUE
LAGRANDE, OR 97850
(541) 963-6092

SP. COOR: NAD 83(91)

N: 606154.112 INT FT.

E: 8820362.847 INT FT.

TYPE: GPS

THETA: 1 ° 42 ' 15.9921356 "

ORDER: SECOND CLASS: 1

SCALE FACTOR: 0.9998973659

ELEV: 3142.00 US FT.

ELEV: DATUM: NGVD 29

COMMENTS:

2 1/2" aluminum pipe with aluminum cap
marked as shown, in mound of stone.

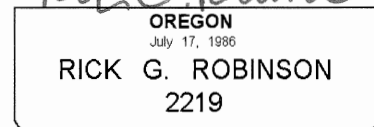
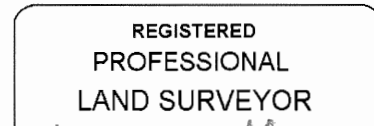
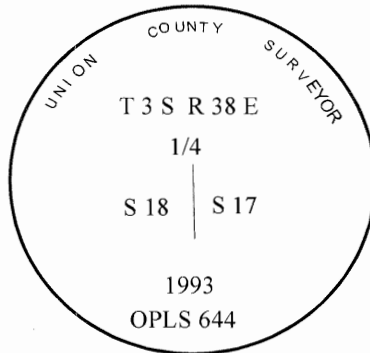

Renewal Date: December 31, 2018

1 METER = 3.2808333333... US FEET = 39.37 INCHES

1 METER = 3.280839895 INT'L FEET OR 1 INCH = 2.54 CM

TO CALCULATE ELEVATION FACTOR (IN THE NORTH AMERICAN CONTINENT)

DIVIDE 20,906,000 BY (20,906,000 + ELLIPSOID ELEV. IN FEET)