

**CERTIFIED RECORD OF LAND CORNER MONUMENTATION**

**HISTORY OF ORIGINAL CORNER ESTABLISHED:**

Corner originally established by David P. Thompson under GLO contract number 103 dated September 3<sup>rd</sup>, 1863. Surveyor General field notes state:

Set post for 1/4 Sec. corner in mound of earth with pits, trench, charred stake as per instructions.

Union County Survey Record 043-84 dated September 19, 1984 by Norman Paullus, OPLS 1952, shows a proportioned position.

T 3 S R 38 E J-19

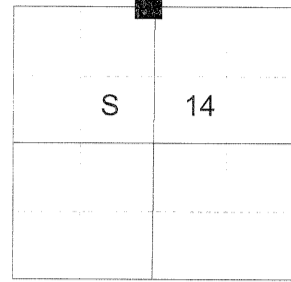

**DESCRIPTION OF CORNER EVIDENCE FOUND:**

None. The painted center line intersection of Gekeler Lane and Buchanan Lane falls 2.9 feet North of the proportioned position.

SEE SURVEY NUMBER 004-2019

**DESCRIPTION OF MONUMENT AND ACCESSORIES I ESTABLISHED TO PERPETUATE THE ORIGINAL LOCATION OF THIS CORNER:**

At the proportionate position I set a 5/8" x 30" iron pin, 30 1/4" in the ground with 2" brass cap marked as shown below, cemented in a 4" hole cut in the asphalt road surface, from which:

- A 5/8" x 30" iron pin bears North 41°26' East a dist. of 45.77 ft., with 1 1/2" aluminum cap marked NE RP.
- A 5/8" x 30" iron pin bears South 47°59' East a dist. of 31.75 ft., with 1 1/2" aluminum cap marked SE RP.
- A 5/8" x 30" iron pin bears South 57°11' East a dist. of 28.04 ft., with 1 1/2" aluminum cap marked SW RP.
- A 5/8" x 30" iron pin bears North 42°43' West a dist. of 45.47 ft., with 1 1/2" aluminum cap marked NW RP.

I hereby certify that the corner was monumented on March 27, 2019.  
Witness: Kyle A. Tucker



Renewal Date: June 30, 2019

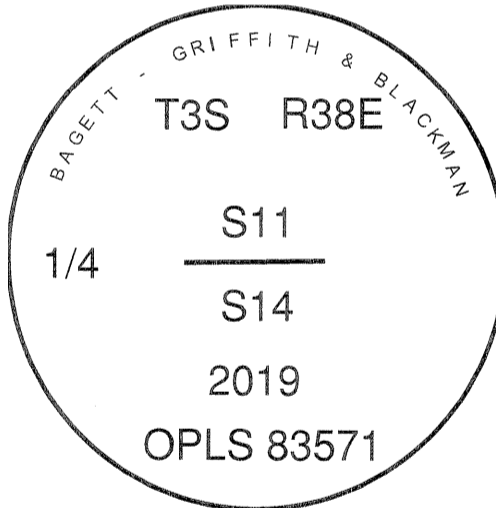

<b>UNION COUNTY SURVEYOR</b>	
Date Received	4/2/19
Date Filed	4/2/19
Filed By	<i>[Signature]</i>
File Number	013-2019R

I used a Leica GS18 in the establishment of the new accessories. Basis of Bearing is as per Union County Survey 004-2019. The bearings and distances are to the center of the aluminum cap.