

CERTIFIED RECORD OF LAND CORNER MONUMENTATION

History of original corner establishment:

Original survey by David P. Thompson, Contract No. 103, 1863

Set post for corner to Sections 10, 11, 14 and 15 in mound of earth with pits, trenches and charred stake as per instructions.

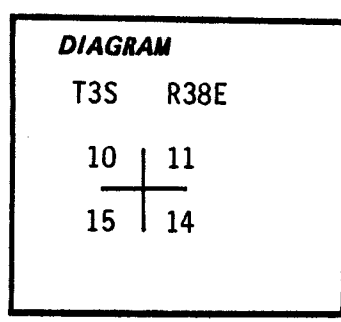

Description of corner evidence found:

Refer to Union County Surveys 43-77, 43-84 and 19-85

Found a 5/8" Iron Rod buried 6" along the south side of Gekeler Lane with plastic cap marked "BGA Survey Marker" as described in Survey 43-77.

Description of monument and accessories established to perpetuate the original location of this corner:

None

UNION COUNTY SURVEYOR
Date Received <u>8-26-85</u>
Date Filed <u>8-26-85</u>
By <u>G. LANGLITZ DEPUTY</u>
File No. <u>52-85R</u>

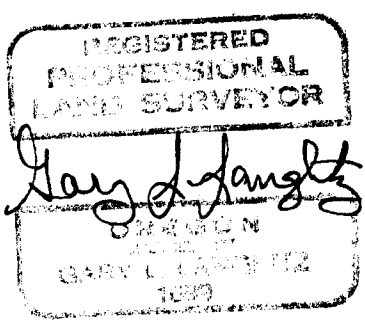

Anderson-Perry & Associates, Inc.

Office of..... County of.....
 State of..... I hereby certify that the within instrument was filed in this office
 for record on the..... day of....., 19.....
 by
 (COUNTY OFFICIAL) (DEPUTY)

J-17

TOWNSHIP 35, RANGE 38 E.

CORNER DIAGRAM

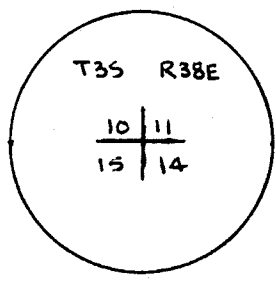

UNION COUNTY SURVEYOR

Date Received 3-14-85

Date Filed 3-15-85

By G. LANGRISH, DEPUTY

File No. 27-85 R

REFER TO FILE NO. 43-84

REFERENCES TO PRIOR RECORDS C.S. 43-77

THIS SPACE RESERVED FOR USE BY COUNTY SURVEYOR

MONUMENT(S) FOUND: (CONDITION AND SOURCE)

5/8" rebar with plastic cap marked BGA in good condition

MONUMENT DETAIL

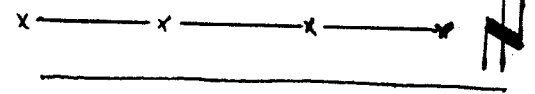

GEKELER LANE

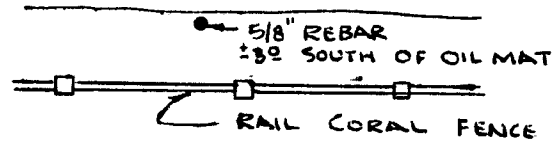

ACCESSORIES FOUND: (CONDITION AND SOURCE)

None

MONUMENT SET (PROCEDURE AND DESCRIPTION)

MONUMENT DETAIL

None

Lined area for monument set procedure and description.

NEW ACCESSORIES

None

Lined area for new accessories.

SKETCH OF MONUMENT, ACCESSORIES AND GENERAL AREA
(IF NEEDED FOR CLARIFICATION)

LOCATION & COMMENTS

DATE _____
COMPASS DECLIN. _____
FIRM/AGENCY P.C.A.
PARTY CHIEF Norman Paullus Jr.
WITNESSES Chet Saunders

SURVEYOR'S SEAL

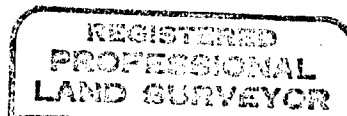

Norman J. Paullus

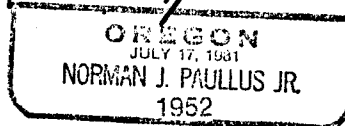

CERTIFIED RECORD OF LAND CORNER MONUMENTATION

History of original corner establishment:

Corner originally established by David T. Thompson under GLO contract Number 103, dated September 3, 1863. Surveyor General record states:

Set post for cor to secs 10, 11, 14 & 15 in mound of earth with charred stake, pits, and trenches as per instructions.

Survey 43-77 calls setting a 5/8" iron pin at corner.

Surveys 122-78, 43-84, and 19-85 call finding 5/8" rebar.

Monumentation sheets 27-85R and 52-85R call finding 5/8" rebar as per survey 43-77.

No record of subsequent monumentation found in Union County survey records

Description of corner evidence found:

Found 5/8" rebar with cap marked BGA SURVEY MARKER as per survey 43-77.

Description of monument and accessories I established to perpetuate the original location of this corner:

In place of found 5/8" rebar, I set a 2½"x30" aluminum pipe with 2½" aluminum cap marked as shown, 40" in the ground 3' south of the oil mat on Gekeler Lane, from which;

NEW BEARING OBJECTS:

- A 5/8" x 30" iron pin with 1½" aluminum cap bears N21°E, 42.22 feet marked UNION COUNTY SURVEYOR NE RP.
- A 5/8" x 30" iron pin with 1½" aluminum cap bears S54°E, 14.49 feet marked UNION COUNTY SURVEYOR SE RP.
- A 5/8" x 30" iron pin with 1½" aluminum cap bears S53°W, 12.57 feet marked UNION COUNTY SURVEYOR SW RP.
- A 5/8" x 30" iron pin with 1½" aluminum cap bears N15°W, 42.82 feet marked UNION COUNTY SURVEYOR NW RP.

I hereby certify that the corner was monumented on March 25, 1996.
Witness: Mark Durbin, Jeff Madsen

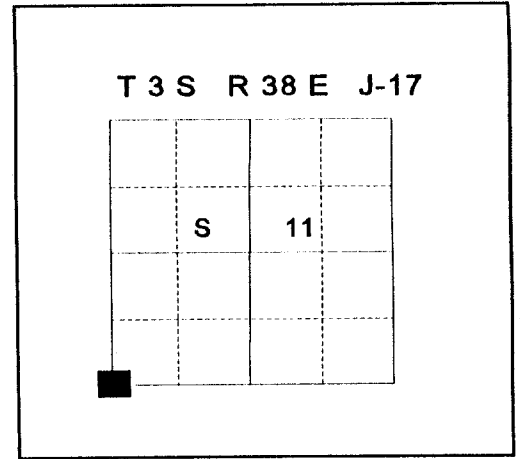

REGISTERED
PROFESSIONAL
LAND SURVEYOR

Gregory T. Blackman

OREGON
JULY 13, 1973

GREGORY T. BLACKMAN
991

Renewal Date: December, 31 1997

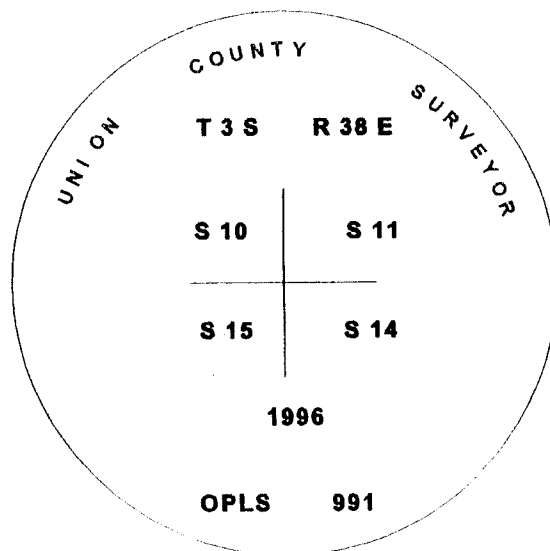

UNION COUNTY SURVEYOR

Date Received 4-22-96

Date Filed 4-22-96

Filed By A. Peterson, Deputy

File Number 044-1996R

I used a steel tape and magnetic compass in the establishment of the new accessories. I used 17° East declination.

HORIZONTAL CONTROL DATA

OREGON STATE PLANE, NORTH ZONE (3601)

LaGRANDE & ISLAND CITY, UNION COUNTY OREGON

STA. NAME: 9637

CORNER COMMON TO: 10,11,14 & 15

TWP.3S, RGE.38E, W.M.

DATE FD.: MARCH, 1996

SURVEYOR: WALTER L. CASWELL
PLS 737

FIRM: EAGLE GPS SURVEY CORP
6110 S.W. LOMBARD AVE.
BEAVERTON, OR. 97008
(503) 643-1073

TYPE: GPS

ORDER: SECOND CLASS: 2

GEODETIC COOR: NAD 83(91)

LAT: 45°18'40.35480" N

LONG: 118°02'05.61395" W

SP. COOR: NAD 83(91)

N: 609228.631 INT.FT.

E: 8836158.369 INT.FT.

THETA: 1°44'53.590"

SCALE FACTOR: 0.999897667

ELEV: 2719.325 US.FT.

ELEV. DATUM: NGVD 29

DIRECTIONS "TO REACH"

REGISTERED
PROFESSIONAL
LAND SURVEYOR

Walter L. Caswell

OREGON
JULY 8, 1966
WALTER L. CASWELL
737

EXPIRES 12/31/97

1 meter = 3.280833... U.S. Feet = 39.37 inches exactly
1 meter = 3.280839895 Intl. Feet or 1 inch = 2.54cm. exactly
To Calculate Elevation Factor (in the North American Continent)
Divide 20,906,000 by (20,906,000 + Ellipsoid Elev. in Feet)

JOB 96-007

SHEET 57 OF 66

CERTIFIED RECORD OF LAND CORNER MONUMENTATION

HISTORY OF ORIGINAL CORNER ESTABLISHMENT:

Corner originally established by David T. Thompson under GLO contract Number 103, dated September 3, 1863. Surveyor General record states: Set post for cor to secs 10, 11, 14 & 15 in mound of earth with charred stake, pits, and trenches as per instructions.

Survey 43-77 calls setting a 5/8" iron pin at corner.

Surveys 122-78, 43-84, and 19-85 call finding 5/8" rebar.

Monumentation sheets 27-85R and 52-85R call finding 5/8" rebar as per survey 43-77.

Monumentation sheet 044-1996R calls finding 5/8" rebar as per survey 43-77 and setting a 2 1/2"x30" aluminum pipe with 2 1/2" aluminum cap 40" in the ground 3' south of the oil mat on Gekeler Lane, from which;

A 5/8" x 30" iron pin with 1 1/2" aluminum cap bears N21°E, 42.22 feet marked UNION COUNTY SURVEYOR NE RP. A 5/8" x 30" iron pin with 1 1/2" aluminum cap bears S54°E, 14.49 feet marked UNION COUNTY SURVEYOR SE RP.

A 5/8" x 30" iron pin with 1 1/2" aluminum cap bears S53°W, 12.57 feet marked UNION COUNTY SURVEYOR SW RP. A 5/8" x 30" iron pin with 1 1/2" aluminum cap bears N15°W, 42.82 feet marked UNION COUNTY SURVEYOR NW RP.

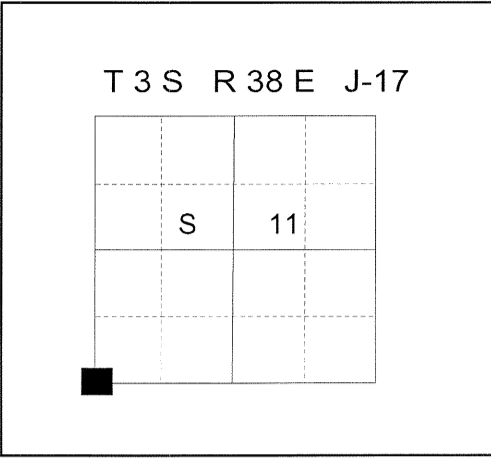

No record of subsequent monumentation found in Union County survey records

DESCRIPTION OF CORNER EVIDENCE FOUND:

Corner monument was found leaning against the Southerly right of way fence by a local surveyor. He returned the monument to the Union County Surveyors Office. The monument was removed during gas line construction. I found the 4 references as follows:

A 5/8" x 30" iron pin with 1 1/2" aluminum cap bears N21°E, 42.22 feet marked UNION COUNTY SURVEYOR NE RP.

A 5/8" x 30" iron pin with 1 1/2" aluminum cap bears S54°E, 14.49 feet marked UNION COUNTY SURVEYOR SE RP.

A 5/8" x 30" iron pin bears S53°W, 12.57 feet. The original 1 1/2" cap has been removed.

A 5/8" x 30" iron pin with 1 1/2" aluminum cap bears N15°W, 42.82 feet marked UNION COUNTY SURVEYOR NW RP.

DESCRIPTION OF MONUMENT AND ACCESSORIES I ESTABLISHED TO PERPETUATE THE ORIGINAL LOCATION OF THIS CORNER:

At record position from the found reference monuments, I set a 2 1/2"x30" aluminum pipe with 2 1/2" aluminum cap marked as shown, 34" in the ground, 3' south of the oil mat on Gekeler Lane;

I added a 1 1/2" aluminum cap marked UNION COUNTY SURVEYOR SW RP to the Southwest reference pin.

I hereby certify that the corner was remonumented on August 9, 2012.

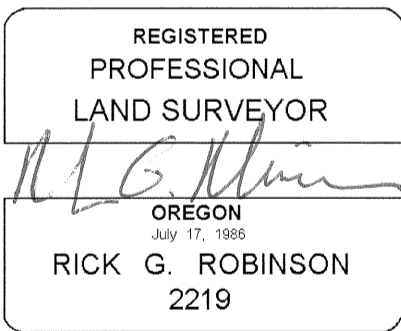

Renewal Date: December 31, 2012

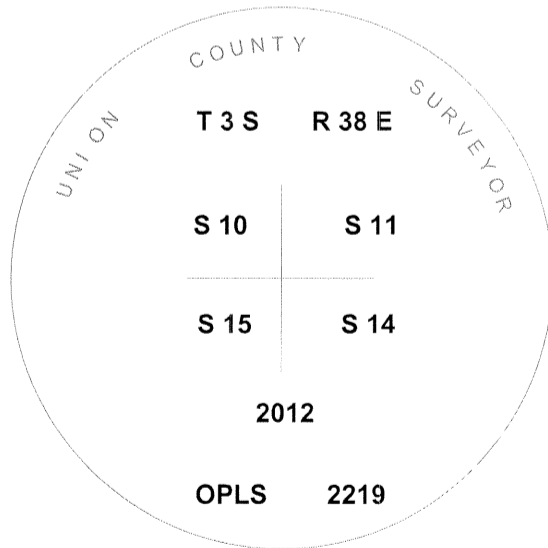

UNION COUNTY SURVEYOR

Date Received 8/17/12

Date Filed 8/20/12

Filed By [Signature]

File Number 026-2012R

I used a steel tape and magnetic compass in the establishment of the new accessories. I used 17° East declination. The distances are to the center of the aluminum cap.

HORIZONTAL CONTROL DATA

UNION COUNTY, OREGON

OREGON STATE PLANE, NORTH ZONE (3601)

STA NAME: 201209

SECTION CORNER COMMON TO SECTIONS 10, 11, 14 AND 15

TWP. 3 S. RGE. 38 E.

GEODETIC COORD: NAD 83(91)

DATE TIED: August 17, 2012

LAT: 45 ° 18 ' 40.35501 " N

SURVEYOR: RICK G. ROBINSON
OPLS 2219

LONG: 118 ° 2 ' 5.61397 " W

FIRM: BAGETT, GRIFFITH, & BLACKMAN
2006 ADAMS AVENUE
LAGRANDE, OR 97850
(541) 963-6092

SP. COOR: NAD 83(91)

N: 609228.652 INT FT.

E: 8836158.367 INT FT.

TYPE: GPS

THETA: 1 ° 44 ' 53.5904819 "

ORDER: SECOND CLASS: 1

SCALE FACTOR: 0.9998976667

ELEV: 2719.31 US FT.

ELEV: DATUM: NGVD 29

COMMENTS:

Corner falls 3 ft. South of South edge of oil on Gekeler Lane, 30 ft. +/- East of fence corner. Monument is 4" below ground.

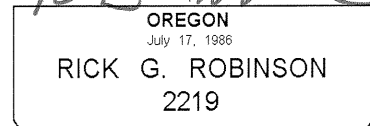
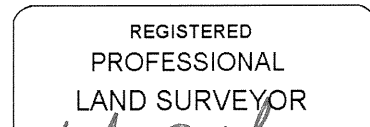
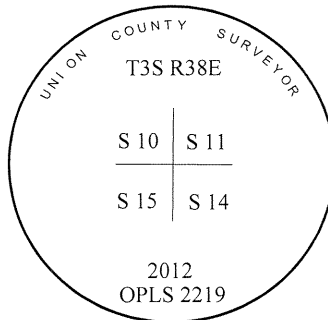

Renewal Date: December 31, 2012

1 METER = 3.2808333333... US FEET = 39.37 INCHES

1 METER = 3.280839895 INT'L FEET OR 1 INCH = 2.54 CM

TO CALCULATE ELEVATION FACTOR (IN THE NORTH AMERICAN CONTINENT)

DIVIDE 20,906,000 BY (20,906,000 + ELLIPSOID ELEV. IN FEET)

Manually disabled GLONASS
satellites (Slot Id): None

Final Coordinates

	Reference:9220	Rover:201209	
Coordinates:			
Latitude:	45° 18' 39.41551" N	45° 18' 40.35498" N	
Longitude:	118° 03' 52.25917" W	118° 02' 05.61414" W	
Ellip. Hgt:	2682.6944 fts	2661.1442 fts	
Solution type:	Phase: all fix		
GNSS type:	GPS		
Frequency:	L1 and L2		
Ambiguity:	Yes		
Quality:	Sd. Lat: 0.0010 fts	Sd. Lon: 0.0007 fts	Sd. Hgt: 0.0019 fts
	Posn. Qlty: 0.0013 fts	Sd. Slope: 0.0007 fts	



Results - Baseline 9220 - 201209

Project Information

Project name: GPS Network 2008
 Date created: 12/02/2010 14:49:42
 Time zone: -7h 00'
 Coordinate system name: NAD83(91) OR N 3601
 Application software: LEICA Geo Office 7.0
 Processing kernel: PSI-Pro 2.0
 Processed: 08/17/2012 16:20:57

Point Information

	Reference: 9220	Rover: 201209
Receiver type / S/N:	SR530 / 34244	ATX1230 / 312081
Antenna type / S/N:	AT502 Tripod / -	ATX1230 GG Pole / -
Antenna height:	3.8484 fts	6.5617 fts
Initial coordinates:		
Latitude:	45° 18' 39.41551" N	45° 18' 40.32509" N
Longitude:	118° 03' 52.25917" W	118° 02' 05.67140" W
Ellip. Hgt:	2682.6944 fts	2653.9754 fts

Processing Parameters

Parameters	Selected	Used	Comment
Cut-off angle:	15°	15°	
Ephemeris type (GPS):	Broadcast	Broadcast	
Ephemeris type (GLONASS):	Broadcast	Broadcast	
Solution type:	Automatic	Phase: all fix	
GNSS type:	Automatic	GPS	
Frequency:	Automatic	Automatic	
Fix ambiguities up to:	80 km	80 km	
Min. duration for float solution (static):	5' 00"	5' 00"	
Sampling rate:	Use all	5	
Tropospheric model:	Hopfield	Hopfield	
Ionospheric model:	Automatic	Computed	
Use stochastic modelling:	Yes	Yes	
Min. distance:	8 km	8 km	
Ionospheric activity:	Automatic	Automatic	

Satellite Selection

Manually disabled GPS satellites (PRNs): None