

UNION COUNTY SURVEYOR

CERTIFIED RECORD OF LAND CORNER MONUMENTATION

HISTORY OF ORIGINAL CORNER ESTABLISHMENT:

Corner originally established by Timothy W. Davenport under GLO contract Number 102, dated July 20, 1863. Surveyor General record states: Set post, from which:
A Pine 30" dia. bears SE, 34 lks.
A Pine 42" dia. bears N55°E, 66 lks.
A Pine 24" dia. bears NW, 88 lks.

Union County Survey 16-77 calls setting a 2" iron pipe with brass cap.

Union County Survey 53-88 call finding "brass cap as per survey 16-77".

No record of subsequent monumentation found in Union County survey records.

DESCRIPTION OF CORNER EVIDENCE FOUND:

Found 2" brass cap monument on 1" iron pipe as per survey 16-77 marked as shown below, in fence corner north and west.

See Union County Survey 009-1996.

DESCRIPTION OF MONUMENT AND ACCESSORIES I ESTABLISHED

TO PERPETUATE THE ORIGINAL LOCATION OF THIS CORNER:

To reference the found brass cap monument the following accessories were taken.

NEW BEARING TREES:

- A 20" Ponderosa Pine bears N11°E, 22.02 feet, marked T3S R38E S7 BT.
- A 5" Ponderosa Pine bears S28°E, 37.56 feet, marked X BT.
- A 12" Ponderosa Pine bears N24°W, 94.80 feet, marked T3S R37E S12 BT.

NEW REFERENCE OBJECT:

A 5/8" x 30" iron pin with 1 1/2" aluminum cap bears S29°W, 11.75 feet marked UNION COUNTY SURVEYOR SW RP.

I hereby certify that the corner was monumented on March 4, 1996.
Witness: Pete Elder

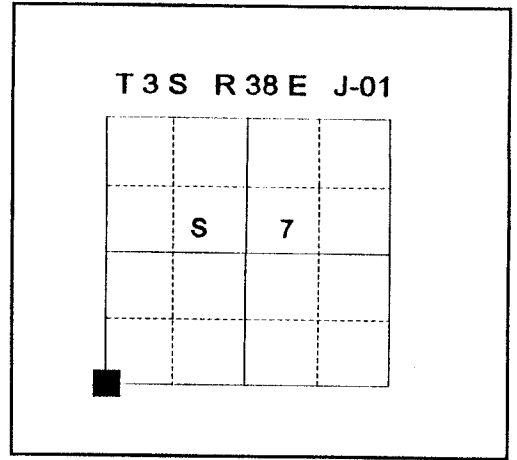

REGISTERED
PROFESSIONAL
LAND SURVEYOR

Jeffery P. Petersen
OREGON
JULY 20, 1993
JEFFERY P. PETERSEN
2625

Renewal Date: December, 31 1996

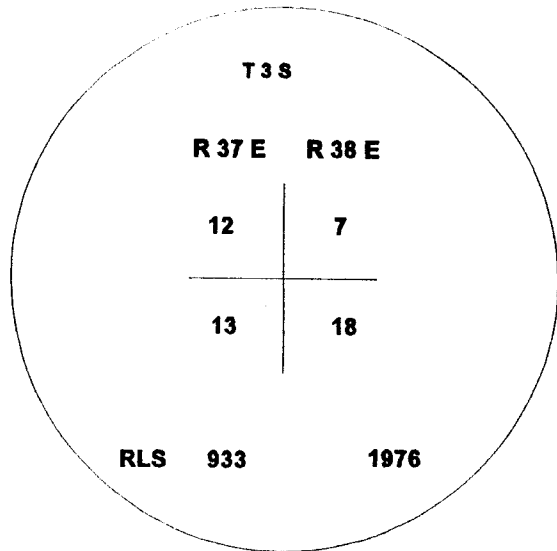

UNION COUNTY SURVEYOR

Date Received 3-19-96

Date Filed 3-20-96

Filed By *Gregory T. Black*

File Number 035-1996 R

I used a steel tape and magnetic compass in the establishment of the new accessories. I used 17° East declination, the distances are to a 60d spike driven into the root crown at the right side of the bearing trees or to the center of the aluminum cap. Attached brass washer to BT blaze.

HORIZONTAL CONTROL DATA

OREGON STATE PLANE, NORTH ZONE (3601)

LaGRANDE & ISLAND CITY, UNION COUNTY OREGON

STA. NAME: 9632

CORNER COMMON TO: 7,12,13 & 18

TWP.3S, RGE.37 & 38E, W.M.

DATE FD.: MARCH, 1996

SURVEYOR: WALTER L. CASWELL
PLS 737

FIRM: EAGLE GPS SURVEY CORP
6110 S.W. LOMBARD AVE.
BEAVERTON, OR. 97008
(503) 643-1073

TYPE: GPS

ORDER: SECOND CLASS: 2

GEODETIC COOR: NAD 83(91)

LAT: 45°18'40.44979" N

LONG: 118°07'00.57770" W

SP. COOR: NAD 83(91)

N: 608605.897 INT.FT.

E: 8815089.684 INT.FT.

THETA: 1°41'24.406"

SCALE FACTOR: 0.999897668

ELEV: 3573.530 US.FT.

ELEV. DATUM: NGVD 29

DIRECTIONS "TO REACH"

AMENDED

REGISTERED
PROFESSIONAL
LAND SURVEYOR

Walter L. Caswell

OREGON
JULY 8, 1966
WALTER L. CASWELL
737

EXPIRES 12/31/97

1 meter = 3.280833... U.S. Feet = 39.37 inches exactly
1 meter = 3.280839895 Intl. Feet or 1 inch = 2.54cm. exactly
To Calculate Elevation Factor (in the North American Continent)
Divide 20,906,000 by (20,906,000 + Ellipsoid Elev. in Feet)

JOB 96-007

SHEET 50 OF 66

HORIZONTAL CONTROL DATA

UNION COUNTY, OREGON

OREGON STATE PLANE, NORTH ZONE (3601)

STA NAME: 9632

CORNER COMMON TO: 7, 18, 12, & 13

TWP. 3 S. RGE. 37&38 E.

GEODETIC COORD: NAD 83(91)

DATE TIED: MARCH 1996

LAT: 45 ° 18 ' 40.40799 " N

SURVEYOR: WALTER L. CASWELL
PLS 737

LONG: 118 ° 7 ' 0.11409 " W

FIRM: EAGLE GPS SURVEY CORP
6110 SW LOMBARD AVE.
BEAVERTON, OR. 97008-4736
(503) 643-1073

SP. COOR: NAD 83(91)

N: 608602.643 INT FT.

E: 8815122.923 INT FT.

TYPE: GPS

THETA: 1 ° 41 ' 24.7351157 "

ORDER: SECOND CLASS: 2

SCALE FACTOR: 0.9998976673

ELEV: 3573.53 US FT.

ELEV: DATUM: NGVD 29

COMMENTS:

This sheet has been edited. The original coordinates came from an eccentric station and the convergence angle was applied the wrong way.

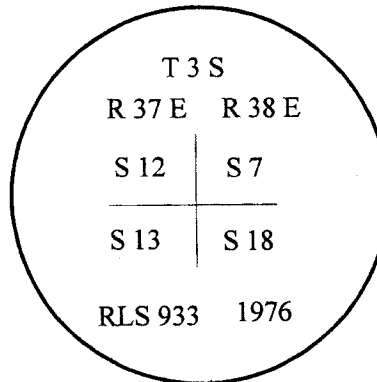

REGISTERED
PROFESSIONAL
LAND SURVEYOR

Gregory T. Blackman

OREGON
JULY 13, 1973

GREGORY T. BLACKMAN
991

Renewal Date: Dec. 31, 2001

1 METER = 3.2808333333... US FEET = 39.37 INCHES

1 METER = 3.280839895 INT'L FEET OR 1 INCH = 2.54 CM

TO CALCULATE ELEVATION FACTOR (IN THE NORTH AMERICAN CONTINENT)

DIVIDE 20,906,000 BY (20,906,000 + ELLIPSOID ELEV. IN FEET)

UNION COUNTY SURVEYOR

CERTIFIED RECORD OF LAND CORNER MONUMENTATION

HISTORY OF ORIGINAL CORNER ESTABLISHMENT:

Corner was originally established by Timothy W. Davenport
Under GLO contract Number 102, dates July 20, 1863
Survey General record states:

Set post, from which:

- A Pine 30" dia. bears SE, 34 lks.
- A Pine 42" dia. bears N55°E, 66 lks.
- A Pine 24" dia. bears NW, 88 lks.

Union County Survey 16-77 calls setting
a 2" iron pipe with brass cap.

Union County Survey 53-88 calls finding
"brass cap as per survey 16-77"

No record of subsequent monumentation found in
Union County survey records.

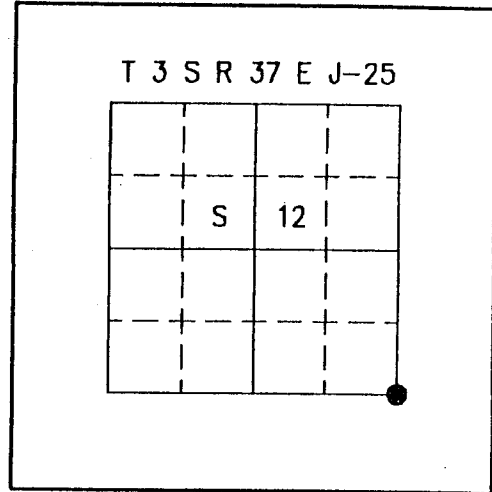

DESCRIPTION OF CORNER EVIDENCE FOUND:

Found a 2 1/2" brass disk on a 1 1/4" galvanized pipe
With the following accessories:

- A 17" Ponderosa Pine bears N24°W, 94.80 feet.
- A 18" Ponderosa Pine bears N11°E, 22.28 feet.
- A 8" Ponderosa Pine bears S28°E, 37.56 feet.

See Union County Survey 009-1996 and 002-2003

**DESCRIPTION OF MONUMENT AND ACCESSORIES I ESTABLISHED
TO PERPETUATE THE ORIGINAL LOCATION OF THIS CORNER:**

None

I hereby certify that the corner was visited on September 11, 2001.

Witness: Daniel A. Renton, Harry D. Kysar

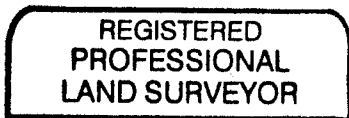

Daniel A. Renton

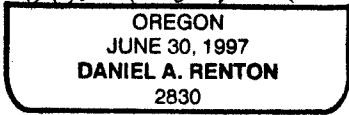

EXPIRATION DATE: DEC. 31, 2004
03/13/03

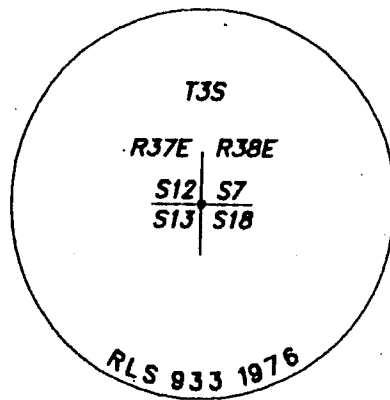

**UNION COUNTY
SURVEYOR**

Date Received 3/17/03

Date Filed 9/12/03

By R. ROBINSON, DEPUTY

File No. 029-2003R