

CERTIFIED RECORD OF LAND CORNER MONUMENTATION

HISTORY OF ORIGINAL CORNER ESTABLISHMENT:
Survey No. 009-2012 position only

T 3 S R 38 E D-17

DESCRIPTION OF CORNER EVIDENCE FOUND:
NONE

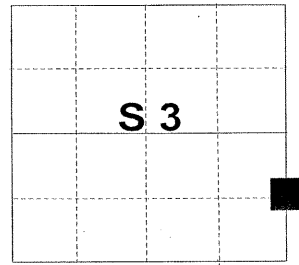

See Union County Survey Number 002-2014

DESCRIPTION OF MONUMENT AND ACCESSORIES ESTABLISHED
TO PERPETUATE THE ORIGINAL LOCATION OF THIS CORNER:

At position determined by survey, I set a 5/8"x30" iron pin with
2 1/2" aluminum cap marked as shown, 30" in the ground, from which:

NEW BEARING OBJECTS:

A 5/8"x30" iron pin with yellow plastic cap marked "BGB SURVEY MARKER" set by survey number 009-2012
bears South 86°13'55" East, a distance of 411.90 feet,

A 5/8"x30" iron pin with yellow plastic cap marked "BGB SURVEY MARKER" set by survey number 009-2012
bears South 0°15'18" West, a distance of 22.71 feet,

I hereby certify that the corner was referenced on March 21, 2014.

Witness: Jeff Hsu

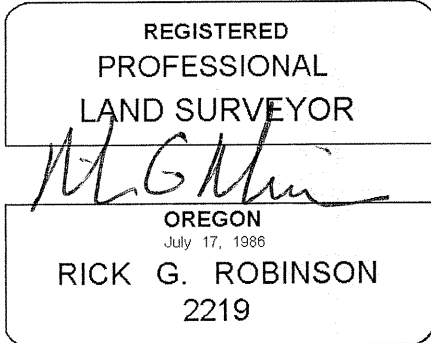

Renewal Date: December 31, 2014

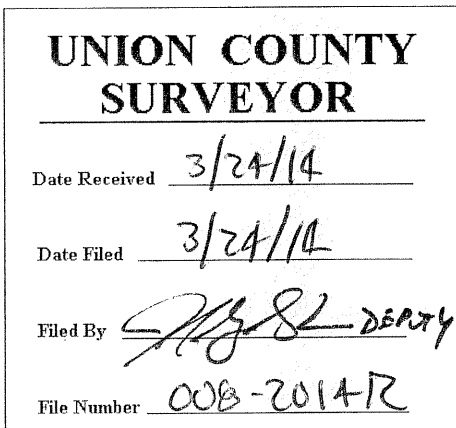
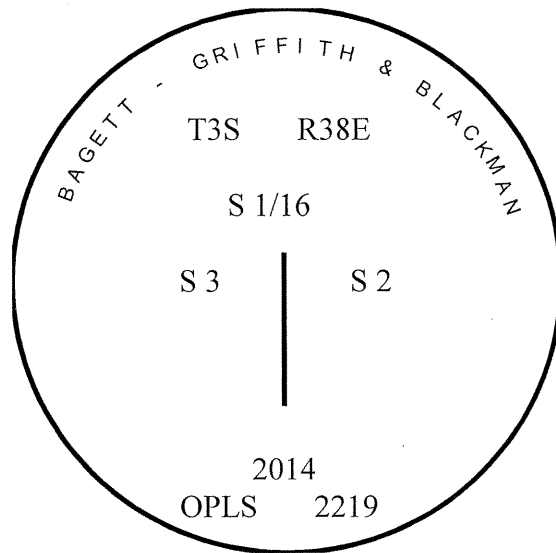

I used a Leica GS 15 GPS unit in the establishment of the new accessories. The basis of bearing is the same as Survey No. 002-2014. Distances are to the center of the pins.