

CERTIFIED RECORD OF LAND CORNER MONUMENTATION

HISTORY OF ORIGINAL CORNER ESTABLISHMENT:

DESCRIPTION OF CORNER EVIDENCE FOUND:

DESCRIPTION OF MONUMENT AND ACCESSORIES I ESTABLISHED TO PERPETUATE THE ORIGINAL LOCATION OF THIS CORNER:

At the Proportionate position I set a 5/8"x30" iron rebar 30" in the ground, with a 2 1/2" Aluminum Cap marked as shown.

NEW BEARING OBJECTS:

A 5/8" x 30" Iron Pin with 1 1/2" Aluminum Cap, bears South 25°11'00" West, a distance of 7.71 ft., marked South RP.

A 5/8" x 30" Iron Pin with Yellow plastic Cap, bears South 89°24'22" West, a distance of 7.04 ft., marked "BGA SURVEY MARKER".

I hereby certify that the corner was perpetuated on 26th of May, 2010.

Witnesses: Greg Blackman Jr. Jeff Hsu

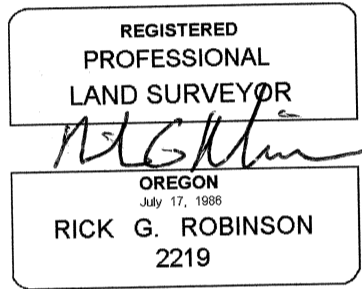
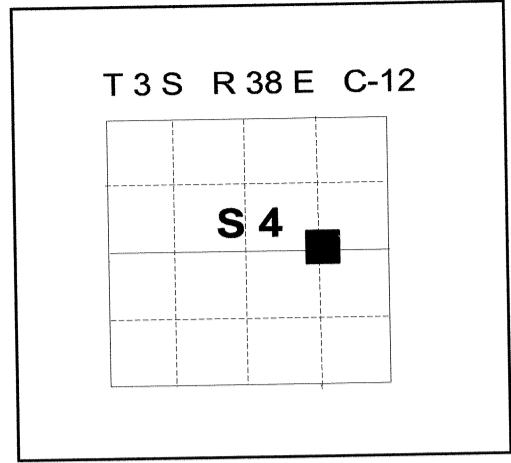

Renewal Date: December 31, 2010

UNION COUNTY SURVEYOR

Date Received 5/27/2010

Date Filed 5/27/2010

Filed By Greg T. Black

File Number 018-2010R

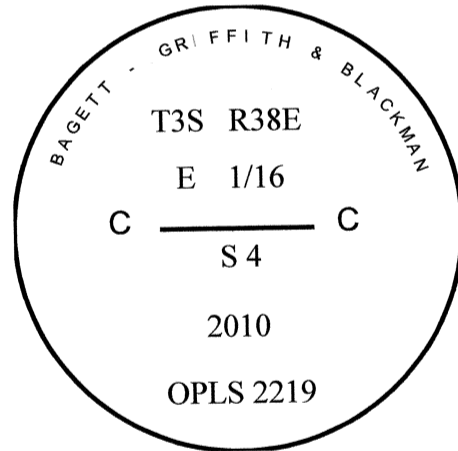

I used a Leica Series 1200 GPS in the establishment of the new accessories. The basis of bearing is the same as Survey No. 008-2008. Distances are to the center of the aluminum cap.