

CERTIFIED RECORD OF LAND CORNER MONUMENTATION

HISTORY OF ORIGINAL CORNER ESTABLISHMENT:

Corner originally established by William H. O'Dell under GLO contract Number 120, dated May 27, 1867. Surveyor General record states:

Set post for 1/4 corner deposited marked stone in mound of stone.

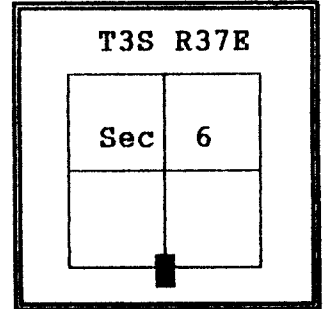

DIAGRAM

No record of subsequent monumentation found in Union County survey records

DESCRIPTION OF CORNER EVIDENCE FOUND:

Found a stone 16" X 9" X 5" marked 1/4 ,in a mound of stone.

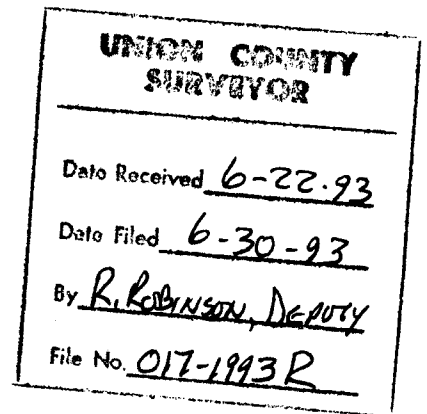

See Union County Survey Number 1993-020.

DESCRIPTION OF MONUMENT AND ACCESSORIES I ESTABLISHED TO PERPETUATE THE ORIGINAL LOCATION OF THIS CORNER:

In place of stone I set a 2 1/2" x 30" aluminum pipe with aluminum cap marked as shown, 18 inches in the ground, from which;

- A 20 inch diameter Ponderosa Pine bears N28°E, 166.74 feet marked 1/4 S 6 BT
- A 15 inch diameter Ponderosa Pine bears S18°E, 177.03 feet marked 1/4 S 7 BT
- A 16 inch diameter Ponderosa Pine bears S40°W, 125.70 feet marked X X BT
- A 17 inch diameter Ponderosa Pine bears N82°E, 162.09 feet marked X BT

Raised a mound of stone around monument, 3 ft. base to top of cap.

Buried stone north and alongside pipe.

Set a steel fence post approximately 5 feet North.

I hereby certify that the above corner point was perpetuated as hereon described on May 12, 1993.

Witness Jeff Petersen

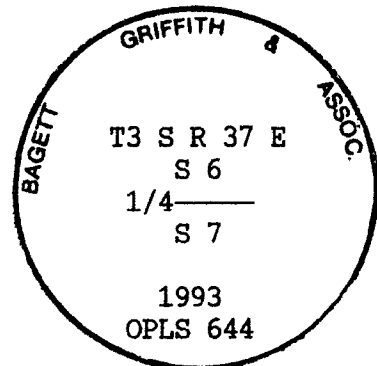

I used a steel tape and magnetic compass in the establishment of new accessories. I used 18° East magnetic declination and the distances are to a 50d spike driven in the right side of the root crown. I attached a brass washer marked OPLS 644 to the BT blaze.

# HORIZONTAL CONTROL DATA

## UNION COUNTY, OREGON

### OREGON STATE PLANE, NORTH ZONE (3601)

STA NAME: 200613

1/4 SECTION CORNER COMMON TO SECTIONS 6 and 7

TWP. 3 S. RGE. 37 E.

GEODETIC COORD: NAD 83(91)

DATE TIED: October 26, 2006

LAT: 45 ° 19 ' 34.90897 " N

SURVEYOR: RICK G. ROBINSON  
OPLS 2219

LONG: 118 ° 13 ' 51.86520 " W

FIRM: BAGETT, GRIFFITH, & BLACKMAN  
2006 Adams Avenue  
La Grande, OR 97850  
(541) 963-6092

SP. COOR: NAD 83(91)

N: 613272.999 INT FT.

E: 8785556.709 INT FT.

TYPE: GPS

THETA: 1 ° 36 ' 32.7269849 "

ORDER: SECOND CLASS: 1

SCALE FACTOR: 0.9998983579

ELEV: 3257.50 US FT.

ELEV: DATUM: NGVD 29

**COMMENTS:**

Corner is a 2 1/2"x30" aluminum pipe with  
2 1/2" aluminum cap marked:

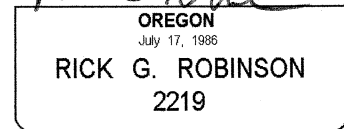
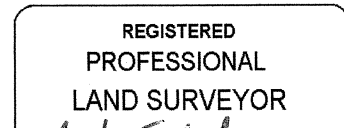
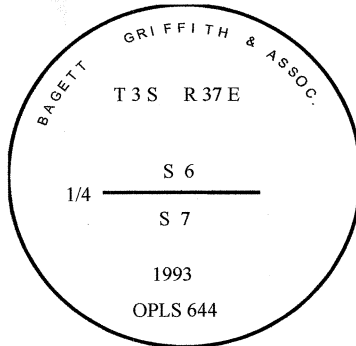

Renewal Date: December 31, 2006

1 METER = 3.280833333... US FEET = 39.37 INCHES

1 METER = 3.280839895 INT'L FEET OR 1 INCH = 2.54 CM

TO CALCULATE ELEVATION FACTOR ( IN THE NORTH AMERICAN CONTINENT)

DIVIDE 20,906,000 BY (20,906,000 + ELLIPSOID ELEV. IN FEET)