

UNION COUNTY SURVEYOR

CERTIFIED RECORD OF LAND CORNER MONUMENTATION

HISTORY OF ORIGINAL CORNER ESTABLISHMENT:

Corner not originally established by GLO survey

Survey No. 020-1993 shows the position only, with no monumentation

DESCRIPTION OF CORNER EVIDENCE FOUND:

NONE

SEE UNION COUNTY SURVEY NUMBER 036-2006

DESCRIPTION OF MONUMENT AND ACCESSORIES I ESTABLISHED TO PERPETUATE THE ORIGINAL LOCATION OF THIS CORNER:

At position established by Survey 020-1993 I set a 5/8"x30" iron pin with 2 1/2" aluminum cap marked as shown below from which;

NEW BEARING OBJECTS:

A 5/8"x30" iron pin with yellow plastic cap marked "BGB SURVEY MARKER" bears South 89°50'45" East, a distance of 110.00 feet.

A 12 inch diameter Douglas Fir bears South 12° East, a distance of 57.45 feet.

I hereby certify that the corner was monumented on October 31, 2006.

Witness: Leo Castillo

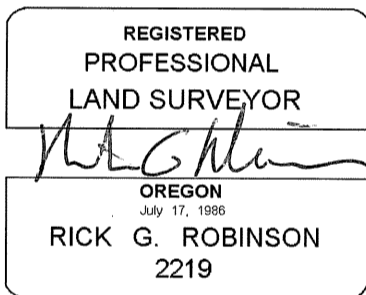
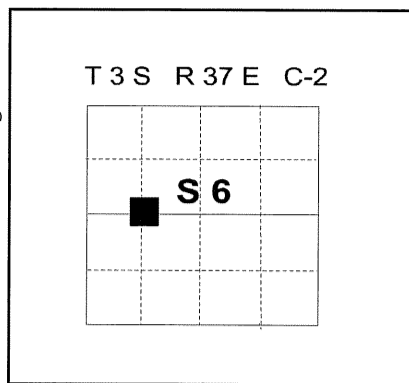

Renewal Date: December 31, 2006

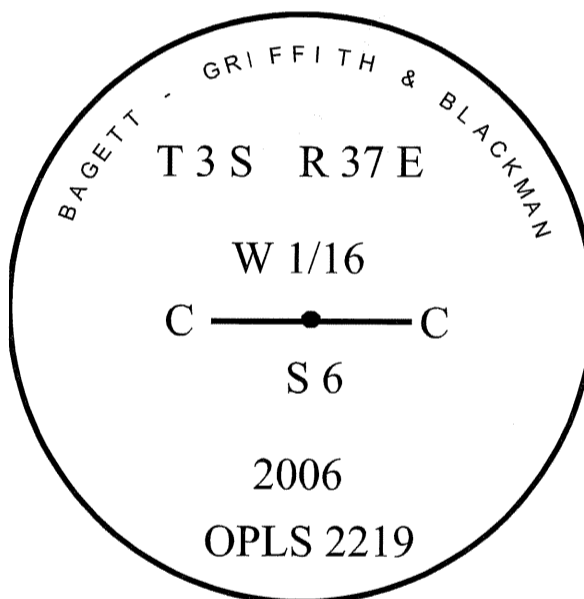

UNION COUNTY SURVEYOR

Date Received 11/3/06

Date Filed 4/14/07

Filed By [Signature]

File Number 004-2007R

I used a Leica system 530 GPS to establish the location of the iron pin accessory. The Basis of bearing is that of survey number 036-2006. I used a steel tape and magnetic compass in the establishment of the new bearing tree. I used 18° magnetic declination, with the distances taken to a 50d spike driven in the right side of the root crown. I attached a brass washer marked "OPLS 2219" to the top of the BT blaze.