

CERTIFIED RECORD OF LAND CORNER MONUMENTATION

HISTORY OF ORIGINAL CORNER ESTABLISHMENT:

The South boundary of T.2S., R.37E., W.M. was originally surveyed by William H. Odell in 1867 under joint GLO contract No. 120 with Joseph G. Gray; approved on Feb. 7, 1868. His notes state: Set post corner for Secs. 1, 2, 35 and 36. Deposited marked stone and raised stone mound as per instructions.

The south boundary was retraced by John A. Hurlburt under contract No. 201 in 1874, for a portion of the subdivision of T.2S. R.37E. This corner was recovered by his survey. In his field notes describing an initial retracement for calibration of his field compass, along the boundary between Secs. 1 and 36. His notes state: Intersect line 92 lks. South of corner, which shows a difference of 40 minutes in course and 86 lks. in chaining.

Corner was recovered by C. Darley, Union County Surveyor, in his survey recorded April 19, 1913 on P.353 in Old Survey Volume. His plat states: Sec. Cor. in place

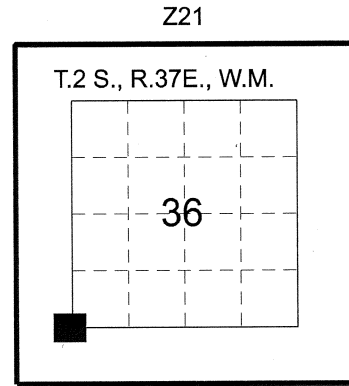

DESCRIPTION OF CORNER EVIDENCE FOUND:

No evidence remains of the original corner.

DESCRIPTION OF MONUMENT AND ACCESSORIES ESTABLISHED TO PERPETUATE THE ORIGINAL LOCATION OF THIS CORNER:

At position by proportionate measurement:

Set a 3 1/4 in. diam. alum. cap on a 5/8 in. diam. by 30 in. long iron rod (rebar), driven 22 inches in the ground, against a 8 1/2 ins. dbh Douglas fir and cradled between roots (used as NW bearing tree), placed mound of stone to top. A galv. steel post placed alongside SE'ly, 3 ft. and driven 18 ins. in the ground, Marked as shown:

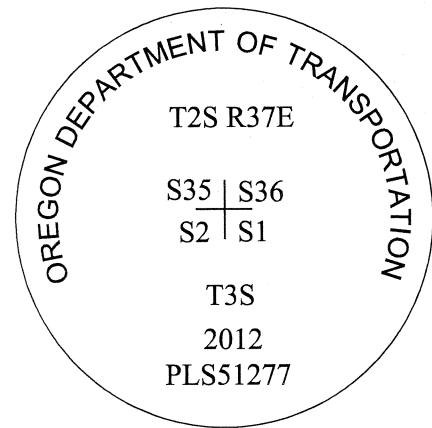

From which: I establish the following references:

A Douglas fir, 11 ins. diam. at breast height, bears N. 69° E., 9.15 ft. marked: T2S R37E S36 BT

A Douglas fir, 9 ins. diam. at breast height, bears S. 51° E., 12.80 ft. marked: T3S R37E S1 BT

A Douglas fir, 8 ins. diam. at breast height, bears S. 36° W., 7.15 ft. marked: T3S R37E S2 BT

A Douglas fir, 8 1/2 ins. diam. at breast height, bears N. 45° W., 0.65 ft. to center and 0.25 ft. to face, marked X at breast height and BT at base.

Accessories taken with hand compass set at 19° E. declination and steel tape.

Witnesses:
Cody Hansen
Peter Elder

I hereby certify that the above corner position was perpetuated as hereon described on October 9, 2012.

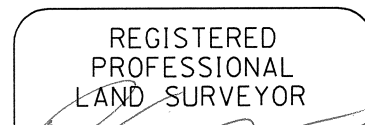
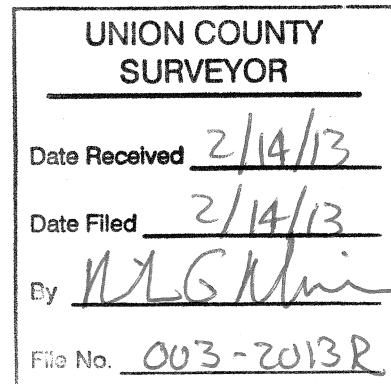

[Handwritten Signature]

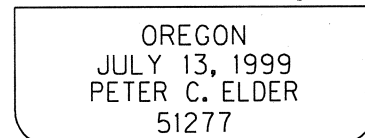

RENEWS: 12/31/2013

	Section	<i>Hilgard - Oro Dell</i>		
	Highway	<i>Interstate 84, Old Oregon Trail</i>		
	County	<i>Union</i>	Scale	<i>NTS</i>
	Purpose	<i>ROW and Quarry</i>	Date	<i>Nov. 16, 2012</i>
	File			