

Index File No. 25 CORNER RECORD (SEARCH) (Ref. FSM 7151.4) Tract or Survey No. _____ Cor. No. _____
 T. 35 R. 36E R.D. LaGrande County Union
 Merid. Willamette N.F. Wallawa-Whitman State Oregon

CORNER DIAGRAM

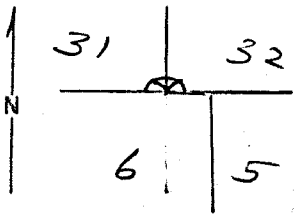

DESCRIBE CORNER MONUMENT FOUND

DESCRIBE BEARING TREES OR OTHER OFFICIAL ACCESSORIES FOUND

P.P. BT with scribing 5 lts NW of Cor.
 other 3 BT's gone but stump holes found in place

PHOTO IDENTIFICATION DATA

Photo No. _____
 Filed At. _____
 Object Ident. _____
 Ident. By _____
 Signature _____

DESCRIBE CORNER LOCATION RELATIVE TO NEAR-BY FEATURES, ALSO HOW TO REACH CORNER

PLANE COORDINATE POSITION DATA

State _____ Zone _____
 X _____
 Y _____
 Estab. By _____
 Agency _____

Signature KHK Title from Boise Cascade Division _____ Headquarters _____ Date 8-28-77 FS-7100-52 (3/68)

UNION COUNTY SURVEYOR

Date Received _____

Date Filed 12-21-87

By G. LANGUITZ, DEPUTY

File No. 272-87R

2-5

CERTIFIED RECORD OF LAND CORNER MONUMENTATION

History of original corner establishment:

Corner originally established by John A. Hurlburt under GLO contract number 201, dated August 5, 1873. Surveyor General record states:

Set pine post 4 ft. long 4 in. square 2 ft. in ground and made stone mound for cor to sec 31-32-5 and 6.

- Pine 12 in dia N12°W 5 lks
- Pine 15 in dia S63°E 18 lks
- Pine 15 in dia S35°W 58 lks
- Pine 20 in dia N62°E 78 lks

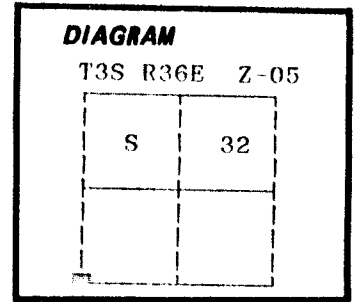

Corner found by Herman D. Graddon on GLO contract number 452, dated June 16, 1882. Surveyor General record states:

The old sec cor a post with 4 bearing trees bears W 15.83 chs dist. I obliterate the marks on post referring to secs S of the line, also the marks in the bearing trees S of line.

No record of subsequent monumentation found in Union County survey records.

Description of corner evidence found:

Found no evidence of the original corner monument.

Found a stump hole N62°E, 78 lks.

Found a stump hole S35°E, 58 lks.

Found a stump hole S63°W, 18 lks.

Found a 20 inch diameter Ponderosa Pine N12°W, 5 lks, dead and down with scribes visible.

Description of monument and accessories I established to perpetuate the

original location of this corner: At record bearing and distance from the found original bearing trees, I set a 2 1/2" x 30" aluminum pipe with aluminum cap marked as shown, 27 inches in the ground, from which;

New Bearing Trees:

- A 16 inch diameter Ponderosa Pine bears N75°E, 88.22 feet marked T3S R36E S32 BT
- A 8 inch diameter Ponderosa Pine bears N41°W, 39.00 feet marked T3S R36E S31 BT

Painted a 6 inch red band around all BTs and attached Bearing Tree and Land Survey Monument signs.

Set a steel fencepost approximately 5 feet East with Land Survey Monument sign attached.

I hereby certify that the above corner point was perpetuated as hereon described on October 2, 1989.

Witness: Rick Robinson

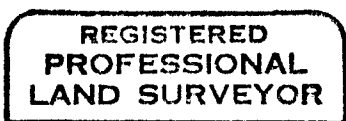
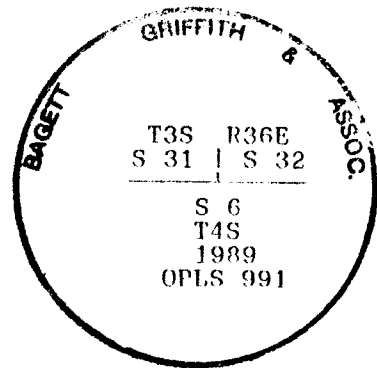

Gregory T. Blackman

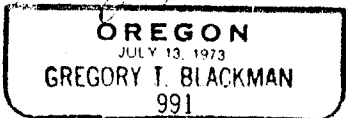

I used a steel tape and magnetic compass in the establishment of new accessories. I used 17° magnetic declination. The distances are to a 50d spike driven in the right side of the root crown. I attached a brass washer marked OPLS 991 to the BT blaze.

Office of..... County of.....
 State of..... I hereby certify that the within instrument was filed in this office
 for record on the..... day of.....

(COUNTY OFFICIAL)

(DEPUTY)

**UNION COUNTY
 SURVEYOR**

Date Received 11-14-89

Date Filed 11-14-89

By R. ROBINSON, DEPUTY

File No. 203-892