

CERTIFIED RECORD OF LAND CORNER MONUMENTATION

-06

History of original corner establishment:

Corner established in 1873 by J. Hurlburt, under General Land Office Contract No. 201. Surveyor General's records state: Mark basalt stone about 36 x 24 x 24 and about 24 in. in ground and make stone mound 2 ft. high for 1/4 Sec. Cor.

Index File No. P-5

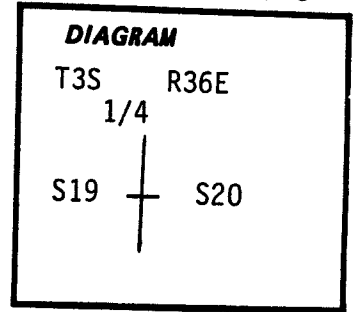

Description of corner evidence found:

A diligent search was made and no evidence could be found of the corner.

Description of monument and accessories established to perpetuate the original location of this corner: At a point established by single proportion measurement set 2 1/2" x 30" galvanized pipe with brass cap stamped:
Set pipe 6" in ground to rock with mound of stone to cap.

From which:

A P. Pine 16" in dia. bears N18°E, 106.5 ft., scribed 1/4 S20 BT. A P. Pine 22" in dia. bears N68°W, 150.9 ft., scribed 1/4 S19 BT. Attached 54-3 signs to both BTs. Attached brass washer stamped LS 1294 to foot blaze of both BTs. Painted blazes and 6" band around both BTs red. Attached 54-2 and 54-4 signs to metal fence post 5' South of corner. Attached 54-2 sign to metal fence post 5' East of corner.

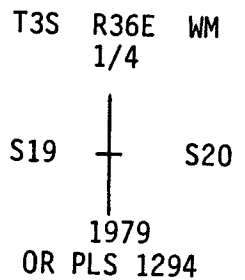

I hereby certify the above corner monument was reestablished as herein described on November 21, 1979.

Witnesses: G. Wagoner
R. Orton
M. Wagoner
D. Allen

REGISTERED PROFESSIONAL LAND SURVEYOR

OREGON
SEPTEMBER 23, 1977
HOWARD L. PERRY
1 2 9 4

Office of..... County Surveyor..... County of..... Union.....
State of..... Oregon....., I hereby certify that the within instrument was filed in this office
for record on the..... day of....., 19.79
..... by
(COUNTY OFFICIAL) (DEPUTY)

UNION COUNTY SURVEYOR

Date Received _____
Date Filed _____
By _____
File No. 440-84 R

**UNION COUNTY
SURVEYOR**

Date Received 10-8-87

Date Filed 10-12-87

By G. LANGLITZ, Deputy

File No. 142-87 R

OREGON CORNER RESTORATION FORM

Section 20 Township 3S Range 36E

County Union Date 7-14-87

Corner Designation

Quarter Corner
19 | 20

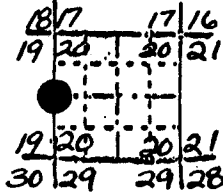

REFER TO SURVEY 29-87

- Condition Report Only
- Not Found
- Renewed
- Unrecorded
- Surveyed In
- Referenced Out

Previous Renewals/Surveys, etc.

1873 Hurlburt 1979 Howard Perry (single Proportioned)

Monument(s) & Accessories Found: (Condition and Source)

- Found 2½" Iron pipe with brass cup in a mound of stone to cap
- Found 18" Ponderosa Pine N18°E-106.5' with open pitched over double blaze marked "¼S20BT"
- Found 24" ponderosa pine N68°W-150.9' with open pitched over double blaze marked "¼S19BT"
- Found metal fence post with Forest Service Signs 5' south & 5' east of corner
- Found ½" IP N14°E- 71.55' from corner

Monument Detail

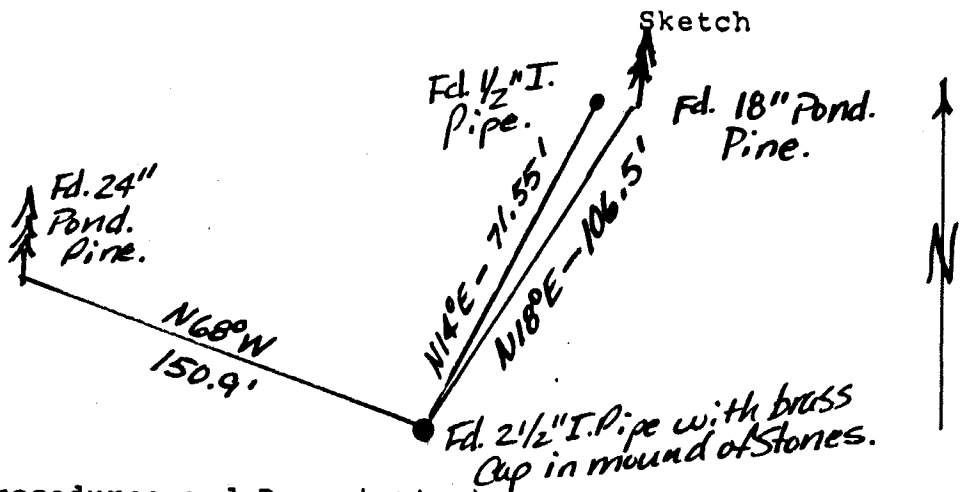
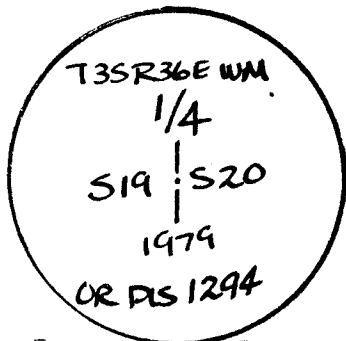

Monument Set (Procedures and Description)

New Accessories

Location & Comments

Red Bridge State Park
Bearings & Distances
by hand compass &
steel tape

Compass Declination

Firm/Agency Oregon State
Parks & Recreation Div.

Address 525 Trade Street SE
Salem OR 97310

Party Chief R.Hill

Notes R.Hill

Witness H.Hanson

Seal

REGISTERED
PROFESSIONAL
LAND SURVEYOR

John E. Hollingsworth

OREGON
JULY 9, 1988
JOHN E. HOLLINGSWORTH
691