

UNION COUNTY  
CERTIFIED RECORD OF LAND CORNER MONUMENTATION

History of original corner establishment:

Corner originally established by John H. Hurlburt under GLO Contract Number 201, dated August 5, 1873. Surveyor General record states:  
Set a stone 18" X 15" X 6" 10 ins in ground for cor. to Secs. 10, 11, 14, 15, from which;

Made mound of stone.

No record of subsequent monumentation found in Union County survey records.

Description of corner evidence found:

Found no evidence of the original corner stone.

The area is subject to flooding by the Grande Ronde River.

See map of survey number 028-1992.

Description of monument and accessories I established to perpetuate the original location of this corner:

At the proportionate position as determined by survey, I set a 2½"x30" aluminum pipe with aluminum cap marked as shown, 28 inches in the ground, from which;

New Bearing Trees or Object;

- A 5/8" X 30" rebar with aluminum cap bears N15°E, 24.65 feet marked T3S R36E RM S11 29 91 1992 OPLS 644.
- A 26 inch diameter Cottonwood bears S53°E, 100.53 feet marked T3S R36E S14 BT on the bark.
- A 28 inch diameter Cottonwood bears S4°W, 93.40 feet marked T3S R36E S15 BT on the bark.
- A 5/8" X 30" rebar with aluminum cap bears N80°W, 29.91 feet marked T3S R36E RM S10 24.65 1992 OPLS 644.

Set a steel fence post approximately 5 feet East with Attention and boundary signs attached.

I hereby certify that the above corner point was perpetuated as hereon described on July 14, 1992.

Witness: Jim Bennett  
Pete Crabtree

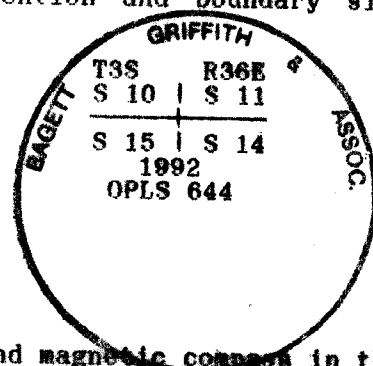
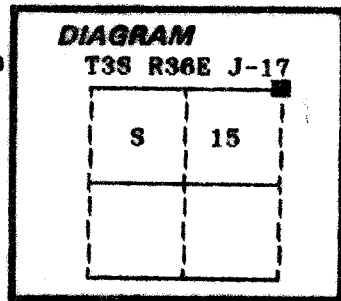

I used a steel tape and magnetic compass in the establishment of new accessories. I used 20° East magnetic declination and the distances are to a 50d spike driven in the right side of the root crown. I attached a brass washer marked OPLS 644 to the BT blaze.

REGISTERED  
PROFESSIONAL  
LAND SURVEYOR

OREGON  
JULY 10, 1984  
DUANE I. GRIFFITH  
644

**UNION COUNTY  
SURVEYOR**

---

Date Received 11/23/92  
Date Filed 11/28/92  
By [Signature]  
File No. 117-1992R

CERTIFIED RECORD OF LAND CORNER MONUMENTATION

History of original corner establishment:

John Hurlburt originally established this corner under GLO Contract 201, dated August 5, 1873. He set a stone 18" x 15" x 6", 10 inches in the ground and made a mound of stone.

Duane Griffith, PLS 644, re-established this corner by proportion July 14, 1992. He set a 2 1/2" x 30" aluminum cap, 28 inches in the ground, with 4 references.

- A 5/8" x 30" rebar with aluminum cap bearing N15°E, 24.65 feet.
- A 26" diameter cottonwood bearing S53°E, 100.53 feet.
- A 28" diameter cottonwood bearing 54°W, 93.40 feet.
- A 5/8" x 30" rebar with aluminum cap bearing N80°W, 29.91 feet.

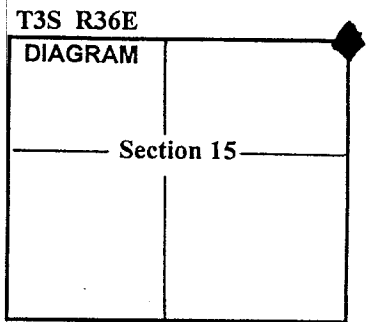

Description of corner evidence found:

Found a 2 1/2" aluminum cap in a 2 foot diameter collar of stone with 4 references as shown:

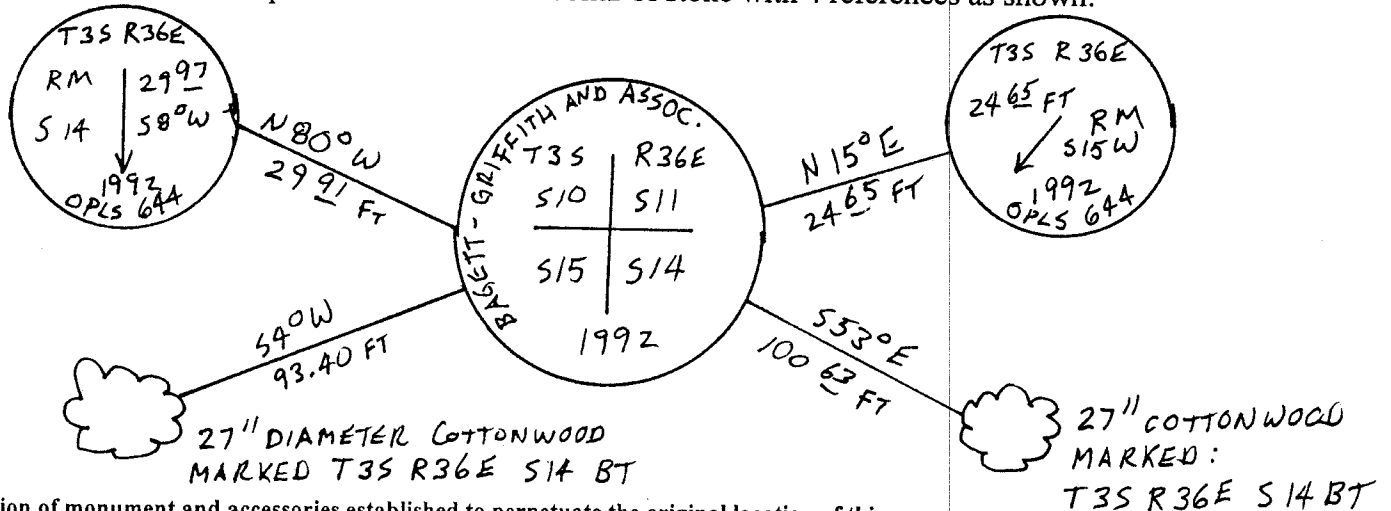

Description of monument and accessories established to perpetuate the original location of this corner:

No additional references set.

Received 12/18/98  
12/18/98  
 R. ROBINSON, DEPUTY  
 187-1998R

**REGISTERED  
 PROFESSIONAL  
 LAND SURVEYOR**  
*Robert E. Butler*  
 OREGON  
 JULY 25, 1995  
 ROBERT E. BUTLER  
 2733

Expires 12/31/99  
 Oregon Department of Transportation  
 3012 Island Avenue  
 La Grande, OR 97850

Office of ..... County of .....

State of ..... I hereby certify that the within instrument was filed in this office for record on the

..... day of ....., 19.....

..... by .....  
 (County Official) (Deputy)