

RESTORED AND ESTABLISHED CORNERS

Section 36, Township 2 South, Range 36 East, W. M.

Hilgard Junction State Park

Union County

August 28, 1969

Var. 20°

TOWNSHIP CORNER, SECTIONS 36, 31, 1 and 6

ORIGINAL:

- Fir post (Missing, found spike in circle of rocks)
- 15" Fir S36°W 31 LKS (not found)
- 18" Fir S18°E 65 LKS (not found)
- 15" Fir N54°E 89 LKS (not found)
- 12" Fir N62°W 52 LKS (not found)

RESTORED:

Since this corner has existed for over 10 years, and the Grande Ronde River calls fit good, I will accept this corner.
 Set 5/8" x 30" iron pin 26" in ground in place of spike.
 Set 4" x 4" x 48" post near pin scribed, "T2S R36E T3S R37E TWNSHP COR"

Witnessed by: A. Slack
 R. Hemmer
 T. Stose

| UNION COUNTY SURVEYOR | |
|-----------------------|-----------------------|
| Date Received | _____ |
| Date Filed | _____ |
| By | _____ |
| File No. | 308 ⁹ -84R |

1/4 CORNER 36 and 1

ORIGINAL:

Stone (found disturbed at fence corner)
 I used fence corner post

SECTION CORNER 1, 2, 35 and 36:

ORIGINAL:

- Post (not found)
- 15" Pine N28°E 98 LKS (now 26", face burned)
- 12" Pine N43°W 84 LKS (now 20", scribe visible)
- 10" Pine S82°W 99 LKS (now 25", scribe visible)
- 10" Pine S19 1/2°E 535 LKS (now 22", face covered)

RESTORED:

Set 5/8" x 30" iron pin 26" in ground.
 Set 4" x 4" x 48" post near pin.
 25" Pine N11°E 155.8 ft. scribed, "T2SR36ES36BTRS691"

Witnessed by: A. Slack
 R. Hemmer
 T. Stose

| UNION COUNTY SURVEYOR | |
|-----------------------|---------|
| Date Received | _____ |
| Date Filed | _____ |
| By | _____ |
| File No. | 310-84R |

(T3S R36E)

| UNION COUNTY SURVEYOR | |
|-----------------------|---------|
| Date Received | _____ |
| Date Filed | _____ |
| By | _____ |
| File No. | 311-84R |

Index File No. Z 21 A-21 CORNER RECORD (SEARCH) Tract or Survey No. _____ Cor. No. _____
 T 25 R. 36E R.D. _____ County _____
 Merid. _____ N.F. _____ State _____

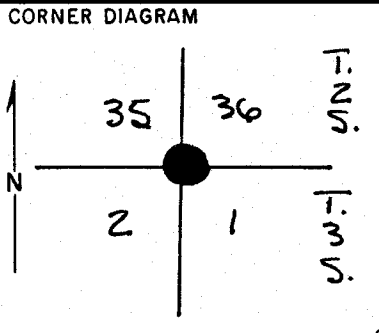

DESCRIBE CORNER MONUMENT FOUND

PHOTO IDENTIFICATION DATA
 Photo No. _____
 Filed At. _____
 Object Ident. _____
 Ident. By _____
 Signature _____

DESCRIBE BEARING TREES OR OTHER OFFICIAL ACCESSORIES FOUND

A pine 25" dia. bears N. 28° E. 98 lks. with illegible marks visible on the partially healed and burned blaze
 A pine 22" dia. bears S. 82° W. 99 lks. with scribe mark S visible in partially healed and burned blaze
 A pine 15" dia. bears N. 43° W. 84 lks. no marks visible
 Pine 30" dia. bears N, 10° E. 236 lks marked T3S R36E S36 BT (this BT not recorded)

PLANE COORDINATE POSITION DATA
 State _____ Zone _____
 X _____
 Y _____
 Estab. By _____
 Agency _____

DESCRIBE CORNER LOCATION RELATIVE TO NEAR-BY FEATURES, ALSO HOW TO REACH CORNER

Signature _____ Title _____ Division _____ Headquarters _____ Date _____ 7100-52
 REV. 65 5

CORNER RECORD (PERPETUATION)

MONUMENT: DESCRIBE NEW MONUMENT SET, OR WORK DONE TO PRESERVE EXISTING MONUMENT

Set an iron post 28" long 2 1/2" dia. 22" in the ground with a brass cap marked

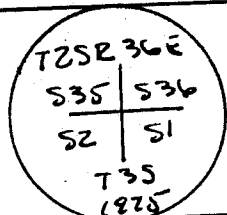

ACCESSORIES DESCRIBE NEW BT'S WITNESS OBJECTS ETC. ESTABLISHED, OR WORK DONE TO PRESERVE EXISTING EVIDENCE

From which a new bearing tree
 A pine 22" dia. bears S. 2 1/2° E. 524 lks. marked T3S R36E S1 BT

Work Done By Garrison Title C. Surveyor Date 7/75 State Registration No. _____ or Agency _____
 Certified Cor. Record Prepared? Yes _____ No _____ Filed At. _____ Date _____

REMARKS
 Corner is located 9 lks. north of fence corner. Fences extent north and east

Index File No. _____ T. _____ R. _____ M. _____ Tract or Surv. No. _____ Cor. _____

UNION COUNTY SURVEYOR

Date Received _____
 Date Filed 12-16-87
 By G. LANGLITZ, DEPUTY
 File No. 204-87R

A-21

CERTIFIED RECORD OF LAND CORNER MONUMENTATION

History of original corner establishment:

Corner originally established by John A. Hurlburt under GLO contract number 201, dated August 5, 1873. Surveyor General record states:
 Set pine post 4 ft. long 4 in. square 2 ft. in ground for cor. to secs. 1-2-35 and 36.
 Pine 15 in. dia. N28°E 98 lks
 Pine 12 in. dia. N43°W 84 lks
 Pine 10 in. dia. S82°W 99 lks
 Pine 10 in. dia. S19½°E 535 lks

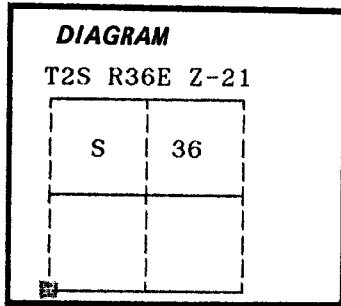

Corner position found and used by John E. Hollingsworth, OPLS 691 in 1969. His record states: ORIGINAL: Post (not found)
 Found 4 bearing trees (see BLM for description). RESTORED: Set 5/8x30" iron rod 26" in ground. Set 4"x4"x48" post near pin. 25" Pine N11°E 155.8 ft. scribed "T2SR36ES36BTRS691". Corner remonumented by A. Joseph Garrison, under BLM group number 350, dated May 3, 1957. His record states: The cor. of secs 1, 2, 35 and 36 monumented with a wood post firmly set from which the remains of the original bearing trees: A pine 25 in diam bears N28°E, 98 lks with scribes visible. A pine 22 in dia bears S82°W 99 lks with scribes visible. A pine 15 in dia bears N43°W 84 lks, no marks visible. Unrecorded bearing tree- A pine 30 in dia bears N10°E 236 lks scribes visible.
 (Hollingsworth tree). At the corner point set an iron post 28 in long 2½ in dia 22 ins. in

Description of corner evidence found:

the ground with brass cap marked (markings shown below) from which a new bearing tree: A pine 22 in dia bears S2½°E 524 lks dist marked T3S R36E S1 BT. No record of subsequent monumentation found in Union County survey records.

Found a standard BLM brass cap monument marked as shown below

Original Bearing Trees:

- A 27 inch diameter Ponderosa Pine bears N28°E, 98 lks with blaze evident.
- A 24 inch diameter Ponderosa Pine bears S82°W, 99 lks with blaze evident.
- A 17 inch diameter Ponderosa Pine bears N43°W, 84 lks with no marks visible.

Hollingsworth Bearing Tree:

A 32 inch diameter Ponderosa Pine bears N10°E, 236 lks with blaze evident.

BLM Bearing Tree:

A 24 inch diameter Ponderosa Pine bears S2½°E, 524 lks with blaze evident.

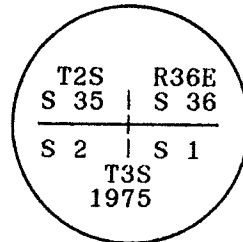

See map of survey dated June, 1989.

Description of monument and accessories | established to perpetuate the original location of this corner:

Painted a 6 inch red band around all BTs and attached bearing tree and land survey monument signs.

Set a steel fencepost approximately 5 feet North with land survey monument and property boundary signs attached.

I hereby certify that the above corner point was perpetuated as hereon described on May 1, 1989.

**REGISTERED
PROFESSIONAL
LAND SURVEYOR**

OREGON
JULY 10, 1964
DUANE I. GRIFFITH
644

**UNION COUNTY
SURVEYOR**

Date Received 8-22-89
 Date Filed 8-22-89
 By G. LANGLITZ, Deputy
 File No. 157-89 R

Office of..... County of.....
 State of....., I hereby certify that the within instrument was filed in this office
 for record on the..... day of....., 19.....

(COUNTY OFFICIAL)

(DEPUTY)

T. 2 S., R. 36 E., Willamette Meridian, Oregon

CHAINS

The following field notes describe the remonumentation of certain original corner points, township 2 south, range 36 east, Willamette Meridian, Oregon, as provided for in the General Special Instructions, Group Number 350, Oregon, dated May 3, 1957, "Investigation of Collateral or Physical Evidence of Corner Positions and Accessories, Followed by Remonumentation of Corner Points, with New Accessories when Needed."

The remonumentation of original corner points was made at the request of the United States Forest Service, in conjunction with their Land Line Location Program.

The mean magnetic declination is 20° E.

South Boundary, T. 2 S., R. 36 E.,
Willamette Meridian, Oregon

(Remonumenting corners established by John A. Hurlburt,
Deputy Surveyor, in 1874)

The cor. of secs. 1, 2, 35, and 36, on the S. bdy. of the Tp., monumented with a wood post, 4 ins. sq., firmly set, projecting 2 ft. above ground, from which the remains of the original bearing trees:

A pine, 25 ins. diam., bears N. 28° E., 98 lks. dist., with illegible scribe marks visible on partially healed and burned blaze.

A pine, 22 ins. diam., bears S. 82° W., 99 lks. dist., with scribe mark S visible on partially healed and burned blaze.

A pine, 15 ins. diam., bears N. 43° W., 84 lks. dist., no marks visible on burned blaze.

and a bearing tree of no record

A pine, 30 ins. diam., bears N. 10° E., 236 lks. dist., mkd. T2S R36E S36 BT.

At the corner point

Set an iron post, 28 ins. long, 2½ ins. diam., 22 ins. in the ground, with brass cap mkd.

T 2 S R 36 E
S 35 | S 36
S 2 | S 1
T 3 S
1975

from which a new bearing tree

A pine, 22 ins. diam., bears S. 2½° E., 524 lks. dist., mkd. T3S R36E S1 BT.

Deposit wood post alongside iron post.

Corner is located 9 lks. North of fence corner, fences extend N. and E.

UNION COUNTY
SURVEYOR

Date Received 3/15/13

Date Filed 3/15/13

By [Signature] DEPUTY

File No. 384-2013R

T3536 A21