

Index File No. 217

CORNER RECORD (SEARCH)  
(Ref. FSM 7151.4)

Tract or Survey No. \_\_\_\_\_ Cor. No. \_\_\_\_\_

T 35 R. 35E R.D. LaGrande County Union SE 34  
Merid. Willamette N.F. W-W State Oregon

CORNER DIAGRAM

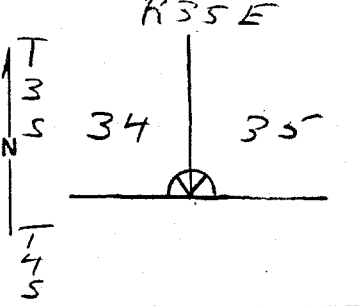

DESCRIBE CORNER MONUMENT FOUND

None  
falls in county road

DESCRIBE BEARING TREES OR OTHER OFFICIAL ACCESSORIES FOUND

Pine stump at  $566^{\circ}30'W$  @ 247 - 100  
Part of the B is visible

PHOTO IDENTIFICATION DATA

Photo No. \_\_\_\_\_  
Filed At. \_\_\_\_\_  
Object Ident. \_\_\_\_\_  
Ident. By \_\_\_\_\_  
Signature \_\_\_\_\_

DESCRIBE CORNER LOCATION RELATIVE TO NEAR-BY FEATURES, ALSO HOW TO REACH CORNER

PLANE COORDINATE POSITION DATA

State \_\_\_\_\_ Zone \_\_\_\_\_  
X \_\_\_\_\_  
Y \_\_\_\_\_  
Estab. By \_\_\_\_\_  
Agency \_\_\_\_\_

Signature David L. Ockleton Title \_\_\_\_\_ Division \_\_\_\_\_ Headquarters \_\_\_\_\_ Date 7-31-86 FS-7100-52 (3/68)

**UNION COUNTY SURVEYOR**

Date Received \_\_\_\_\_

Date Filed 12-21-87

By G. LANGLITZ, DEPUTY

File No. 251-87R

2-17

OREGON CORNER RESTORATION FORM

Section 36 Township 3S Range 35E

County Union Date 5-03-95

CORNER DESIGNATION: Z-17

Previous Renewals/Surveys, etc. This corner was originally set by U.S. Deputy Surveyor J. Cooper under contract No.397 dated July 1,1881. The Surveyor Generals notes state: Set post 4 1/2 feet long 4 ins square 2 ft. in the ground on W. side of in scattering fir timber, for cor. to secs. 2,3,34 and 35. Marked T 3 S R 35 E S 35 on the N.E., R 35 E S 2 on the S.E., T 4 S S 3 on the S.W. and S 34 on the N.W. face with 2 notches on the East and 4 notches on the West edges.

A pine 22 ins. diam. brs. S38°30'E 147 lks. dist. marked T 4 S R 35 E S 2 BT  
A pine 18 ins. diam. brs. S66°30'W 247 lks. dist. marked T 4 S R 35 E S 3 BT

Monument(s) & Accessories Found: (Condition and Source) Found a rotted stump with visible axe marks and bearing tree tag as shown on survey no. 15-90.

Monument Detail: No monument was set, corner falls in McIntyre road.

Monument Set (Procedures and Description): No monument set, the corner position falls in McIntyre road.

New Accessories: From the position established N 66°30' W 163.0 feet from the found bearing tree stump:

A 5/8"x 30" rebar with a yellow plastic cap stamped "TOMKINS SURVEYING" set near a fence corner at the N.W. corner of the intersection of Highway 244 with McIntyre road, bears N 78°06'42" W 36.55 feet.

A 5/8"x 30" rebar with a yellow plastic cap stamped "TOMKINS SURVEYING" set near a fence corner at the N.E. corner of the intersection of Highway 244 with McIntyre road, bears N 45°44' E 78.23 feet.

A 5/8"x 30" rebar with a yellow plastic cap stamped "TOMKINS SURVEYING" set near a fence corner at the S.E. corner of the intersection of Highway 244 with McIntyre road, bears S 82°22'18" E 99.92 feet.

A 5/8"x 30" rebar with a yellow plastic cap stamped "TOMKINS SURVEYING" set near a fence corner at the S.W. corner of the intersection of Highway 244 with McIntyre road, bears S 1 3°48'49" W 82.98 feet.

Location & Comments: Corner is located at the intersection of Highway 244 and McIntyre road North of the northerly edge of Highway 244.

Compass Declination: 18° E  
Firm/agency: Tomkins-wells Joint Venture  
Land Surveying  
P.O. Box 1696  
Pendleton, Oregon 97801

Surveyor's Seal

Party Chief: Greg Flowers  
Notes: Greg Flowers  
Witness: Todd Rosenbalm

UNION COUNTY  
CLERK  
Date Received 5/9/95  
Date Filed 5/11/95  
By [Signature]  
File No. 003-1995R

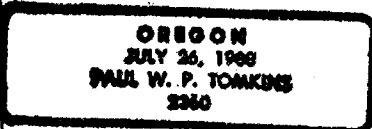
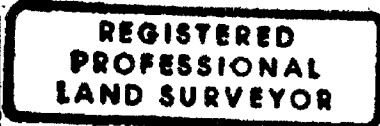

renews 6/30/96  
5/07/95

**UNION COUNTY SURVEYOR  
CERTIFIED RECORD OF LAND CORNER MONUMENTATION**

**HISTORY OF ORIGINAL CORNER ESTABLISHED:**

Corner originally established by U.S. Deputy Surveyor J. Cooper under contract No. 397 dated July 1, 1881. Surveyor General notes state:

Set post 4 1/2 feet long, 4 ins. square 2 ft in the ground, on W. Side of hill, in scattering fir timber for cor. To secs 2, 3, 34 and 35, marked T3S R35E S35 on the NE, R35E S2 on the SE, T4S S3 on the SW face and S34 on the NW face with 2 notches on the East, and 4 Notches on the West edges.

A pine 22 ins. diam bears S 38°30'E, 147 lks. dist., marked T4S R35E S2 BT.  
A pine 18 ins. diam bears S 66°30'W, 247 lks. dist., marked T4S R35E S3 BT.

Position established in Survey No. 012-1995. No new monument set. Union County Monumentation Record No. 003-1995R states:

No monument set, the corner position falls in McIntyre road.

From the position established N 66°30' W 163.0 feet from the found bearing tree stump:

A 5/8" x 30" rebar with a yellow plastic cap stamped "TOMKINS SURVEYING" set near a fence corner at the N.W. corner of the intersection of Highway 244 with McIntyre road, bears N 78°06'42" W 36.55 feet.

A 5/8" x 30" rebar with a yellow plastic cap stamped "TOMKINS SURVEYING" set near a fence corner at the N.E. corner of the intersection of Highway 244 with McIntyre road, bears N 45°44' E 78.23 feet.

A 5/8" x 30" rebar with a yellow plastic cap stamped "TOMKINS SURVEYING" set near a fence corner at the S.E. corner of the intersection of Highway 244 with McIntyre road, bears S 82°22'18" W 99.92 feet.

A 5/8" x 30" rebar with a yellow plastic cap stamped "TOMKINS SURVEYING" set near a fence corner at the S.W. corner of the intersection of Highway 244 with McIntyre road, bears S 13°48'49" W 82.98 feet.

**DESCRIPTION OF CORNER EVIDENCE FOUND:**

Found a 5/8" iron rod with a yellow plastic cap bears N 78°06' W, a distance of 36.55 feet, marked Tomkins Surveying, vertical in good condition.

Found a 5/8" iron rod with a yellow plastic cap bears N 45°44' E, a distance of 78.23 feet, marked Tomkins Surveying, vertical in good condition.

Found the 5/8" iron rod for the Southeast accessory bent/disturbed with no cap. (No measurement taken)

No remains of the Southwest pin found.

**DESCRIPTION OF MONUMENT AND ACCESSORIES I ESTABLISHED TO PERPETUATE THE ORIGINAL LOCATION OF THIS CORNER:**

At the intersection of record distance from the two North bearing objects I set a 2 1/2" x 15" copper clad monument 6" below the surface of McIntyre road. From which:

**NEW BEARING OBJECTS:**

A 5/8" iron rod with a 1 1/2" aluminum cap bears N 33°50' E, a distance of 75.45 feet, marked Union County Surveyor NE RP.

A 5/8" iron rod with a 1 1/2" aluminum cap bears N 35°04' W, a distance of 51.00 feet, marked Union County Surveyor NW RP.

I hereby certify that this corner was monumented on January 28, 2015.

Witness: Thomas J. Kopp

REGISTERED  
PROFESSIONAL  
LAND SURVEYOR

*Rick G. Robinson*  
OREGON  
July 17, 1986  
RICK G. ROBINSON  
2219

Renewal Date: December 31, 2016

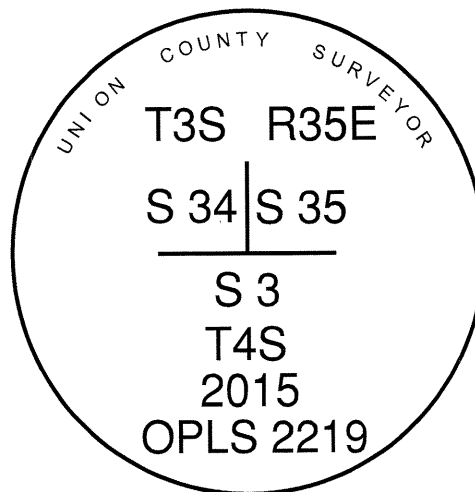

**UNION COUNTY SURVEYOR**

Date Received 2/4/15

Date Filed 2/11/15

Filed By [Signature] DEPUTY

File Number 010-2015R

I used a Leica GS-15 in the establishment of the new accessories. Basis of Bearing is True Geodetic North at the Northeast corner of Section 3, Township 4 South, Range 35 East of the Willamette Meridian as determined by GPS observation.

T 3 S R 35 E Z-17

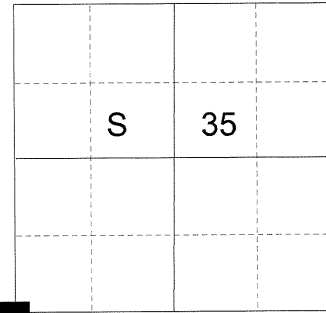

# HORIZONTAL CONTROL DATA

## UNION COUNTY, OREGON

### OREGON STATE PLANE, NORTH ZONE (3601)

STA NAME: 201501

SECTION CORNER COMMON TO SECTIONS 34 AND 35 ONLY

TWP. 3 S. RGE. 35 E.

GEODETIC COORD: NAD 83(91)

DATE TIED: January 28, 2015

LAT: 45 ° 15 ' 8.59400 " N

SURVEYOR: RICK G. ROBINSON  
OPLS 2219

LONG: 118 ° 24 ' 28.59699 " W

FIRM: BAGETT, GRIFFITH, & BLACKMAN  
2006 ADAMS AVENUE  
LAGRANDE, OR 97850  
(541) 963-6092

SP. COOR: NAD 83(91)

N: 585083.702 INT FT.

E: 8740783.323 INT FT.

TYPE: GPS

THETA: 1 ° 29 ' 1.16570282 "

ORDER: SECOND CLASS: 1

SCALE FACTOR: 0.9998956455

ELEV: 3427.15 US FT.

ELEV: DATUM: NGVD 29

**COMMENTS:**

Corner monument is set 6" below road surface of McIntyre Road

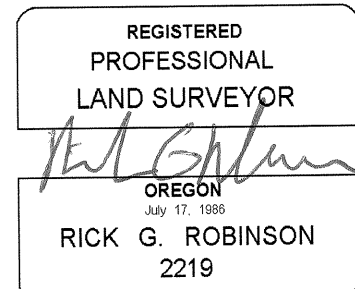
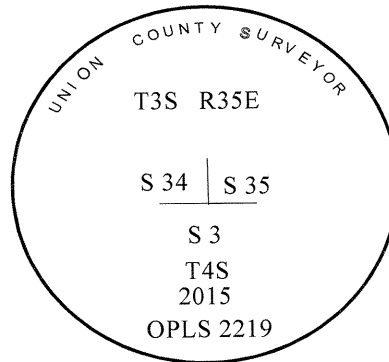

Renewal Date: December 31, 2016

1 METER = 3.2808333333... US FEET = 39.37 INCHES

1 METER = 3.280839895 INT'L FEET OR 1 INCH = 2.54 CM

TO CALCULATE ELEVATION FACTOR ( IN THE NORTH AMERICAN CONTINENT)

DIVIDE 20,906,000 BY (20,906,000 + ELLIPSOID ELEV. IN FEET)