

CERTIFIED RECORD OF LAND CORNER MONUMENTATION

History of original corner establishment:

Not previously set.

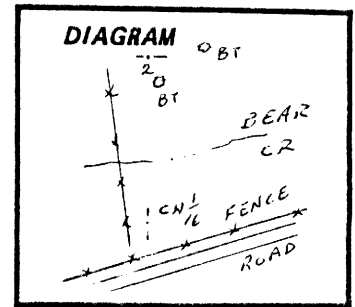

Description of corner evidence found:

Not previously set.

UNION COUNTY SURVEYOR	
Date Received	<u>10-2-86</u>
Date Filed	<u>10-13-86</u>
By	<u>G. LANGLITZ DEPUTY</u>
File No.	<u>177-86 R</u>

See Survey 35-86

Description of monument and accessories established to perpetuate the original location of this corner:

Set a 2" x 30" galvanized iron pipe with 2½" brass cap marked: Pipe is set 26" into the ground with a collar of stone. A steel fence post is set 5' from the brass cap with a USFS Land Survey Monument sign attached.

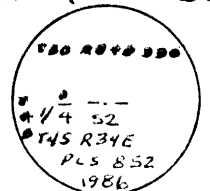

Bearing Trees:

A 10" Douglas Fir bears N 76°00'E, 22.7' scribed ¼ S BT in a single blaze. A 16" Tamarack bears S30°00'E, 6.4" scribed ¼ S BT in a single blaze. A ¾" aluminum washer stamped RLS 852 is nailed between the letters B and T on each tree. A 6" red band is painted around each tree and USFS Bearing Tree and Land Survey Monument signs attached. The corner is immediately south of a 53" Tamarack not used as a bearing tree.

I certify the above corner point was established as hereon described on September 10, 1986.

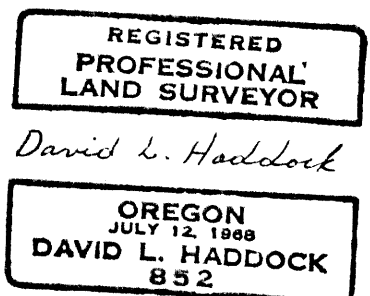

Office of..... County of.....
 State of....., I hereby certify that the within instrument was filed in this office
 for record on the..... day of....., 19.....
 by
 (COUNTY OFFICIAL) (DEPUTY)

RECORD OF LAND CORNER MONUMENTATION

NORTH 1/4 CORNER SECTION 2, T. 4 S., R. 34 E., W.M.

ORIGINALLY ESTABLISHED BY: David L. Haddock, PLS #852

SURVEY NUMBER: 35-86, filed November 18, 1986

UNION COUNTY MONUMENTATION NUMBER: 177-86R, filed October 13, 1986

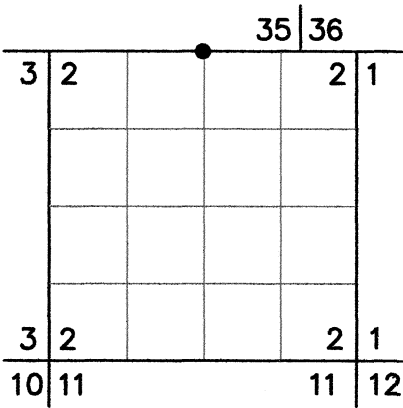

ORIGINAL DESCRIPTION: Set a 2" x 30" galvanized iron pipe with 2½" brass cap marked: (diagram shown) Pipe is set 26" into the ground with a collar of stone. A steel fence post is set 5' from the brass cap with a USFS Land Survey Monument sign attached.

Bearing Trees:

A 10" Douglas Fir bears N 76°00'E, 22.7' scribed ¼ S BT in a single blaze. A 16" Tamarack bears S30°00'E, 6.4" scribed ¼ S BT in a single blaze. A 3/4" aluminum washer stamped RLS 852 is nailed between the letters B and T on each tree. A 6" red band is painted around each tree and USFS Bearing Tree and Land Survey Monument signs attached. The corner is immediately south of a 53" Tamarack not used as a bearing tree.

EVIDENCE FOUND: Found a 2½" galvanized pipe with 2½" brass cap, marked as shown below, flush with ground with steel fence post with attached USFS 54-9 signs set south, 4.9 ft. from found monument.

From which I found the following bearing trees:

A Douglas-fir, 8" dbh, bears N. 76°00' E., 22.7 ft., found dead and down with visible scribe.

A western larch, 16" dbh, bears S. 23°E., 6.40 ft., with a healed blaze. Distance measured with steel tape to 60d nail driven side-center-right at the root crown, with an attached 1½" aluminum washer stamped PLS 69454.

DESCRIPTION OF MONUMENTS AND ACCESSORIES SET AND METHODS USED:

I accept the position of the found monument for the corner.

CORNER MONUMENT MARKED:

From which, **I SCRIBE NEW BEARING TREES:**

- ▶ A Douglas-fir, 22" dbh, bears N. 14° E., 37.61 ft., marked X in upper blaze, and BT in lower blaze. Distance measured with RTK GPS
- ▶ A western larch, 26" dbh, bears S. 70° W., 13.76 ft., marked X in upper blaze and BT in lower blaze. Distance measured with steel tape

Also from which, **I SET NEW REFERENCE POINT:**

- ▶ A 5/8"x24" iron pin, bears N. 69° W., 15.00 ft., with attached 2" aluminum cap marked *RP 1 2025 PLS 69454*. Distance measured with RTK GPS

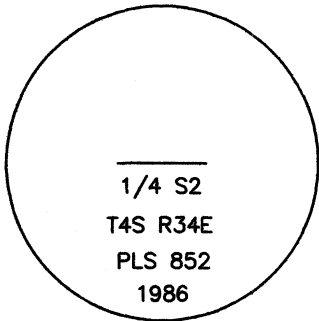

Painted a 6" red band around each tree, and also painted the blazes red. Attached 54-3 and 54-9 signs to bearing trees. Bearings are geodetic, based on GPS observation at the corner. Distances to bearing trees measured to a 60d nail driven in the side-center-right at the root crown of each tree, with attached 1½" aluminum washer stamped *PLS 69454*.

RESTORATION BY, STAMP AND DATE:

Work performed September 25, 2025
Survey completed September 25, 2025

T. Jesus Quinones, LSIT

USDA FOREST SERVICE
NORTHEAST OREGON LAND ZONE
1550 Dewey Avenue, Suite A
Baker City, OR 97814
(541) 523-1283

UNION COUNTY
SURVEYOR

Date Received 12/18/25

Date Filed 12/18/25

By [Signature]

File No. 054-2025R

REGISTERED
PROFESSIONAL
LAND SURVEYOR

[Signature]

OREGON
NOVEMBER 30, 2007
JASON L. HATFIELD
#69454

EXPIRES: 6/30/2027