

CERTIFIED RECORD OF LAND CORNER MONUMENTATION

History of original corner establishment: Corner established by Rufus S. Moore under General Land Office contract number 451, dated June 12, 1882. Surveyor General records state: Set basalt stone 16"x13"x8", 12" in the ground for 1/4 section corner, marked 1/4 on the North face, from which:

A Pine 10" diameter bears S68°E, 117 lks, marked 1/4S BT.

A Pine 10" diameter bears N84°W, 80 lks, marked 1/4S BT.

Corner remonumented in 1975 by BLM. Record States:

Set an iron post 28" long, 2 1/2" in diameter 24" in the ground with brass cap marked as shown below.

A 10" Pine bears S61 3/4°E, 79 lks, marked 1/4 S23BT

A 7" Pine bears N 75 1/2°W, 32 lks, marked 1/4 S14 BT.

Deposited stone alongside iron post.

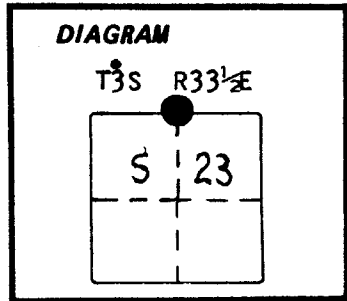

No record of subsequent monumentation found in county records.

Description of corner evidence found:

Found standard BLM brass cap marked as shown below.

Found original SE BT. dead and down at record bearing and distance.

Found original NW BT. dead and down at record bearing and distance.

Found BLM 1075 SE BT. dead and down, at record bearing and distance.

Found BLM 1975 NW BT. dead and down, at record bearing and distance.

See map of survey dated 4-86.

Description of monument and accessories I established to perpetuate the original location of this corner: From the found BLM brass cap I set a 5/8"x30" rebar with plastic cap marked BGA Survey Marker at a bearing of South 5.26 feet.

A 5/8"x30" rebar with plastic cap marked BGA Survey Marker bears West 5.35 feet.

Set steel fence post approximately 5 feet East with a 54-9 sign attached.

Corner rehabilitated 4-7-86

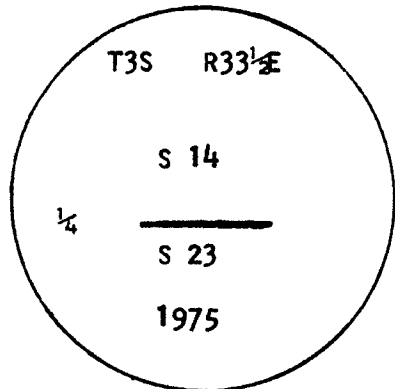

Standard BLM Cap

REGISTERED PROFESSIONAL LAND SURVEYOR

Duane I. Griffith
OREGON
JULY 10, 1964
DUANE I. GRIFFITH
644

UNION COUNTY SURVEYOR
Date Received 4-30-86
Date Filed 5-1-86
By G. LANGLITZ, DEPUTY
File No. 16-86R

Office of..... County of.....
State of....., I hereby certify that the within instrument was filed in this office
for record on the..... day of....., 19.....
..... by

(COUNTY OFFICIAL)

(DEPUTY)

Index File No. N 19 CORNER RECORD (SEARCH) (Ref. FSM 7151.4) Tract or Survey No. _____ Cor. No. _____
 T 3S R. 33½E R.D. La grande County Union
 Merid. Willamette N.F. W-W State Oregon

CORNER DIAGRAM

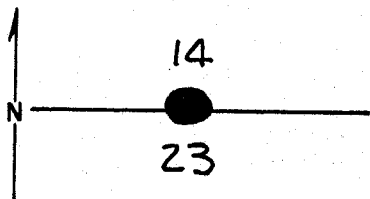

DESCRIBE CORNER MONUMENT FOUND

The $\frac{1}{4}$ corner to sections 14 & 23 monumented with a basalt stone 16 x 13 x 8 inches firmly set 4 inches in the ground, no marks visible from which the remains of the original bearing trees:

DESCRIBE BEARING TREES OR OTHER OFFICIAL ACCESSORIES FOUND

A root hole bears S 68° E. 117 lks. dist. with a down and decayed pine along side 10" dia. with scribe marks BT visible in decayed blaze

A pine snag 15" dia. bears N. 84° W. 80 lks. dist. with scribe marks $\frac{1}{4}$ S visible in partially healed blaze

PHOTO IDENTIFICATION DATA

Photo No. PTU 1442 1939

Filed At. _____

Object Ident. _____

Ident. By W. Hyde 7-6-64
Signature

DESCRIBE CORNER LOCATION RELATIVE TO NEAR-BY FEATURES, ALSO HOW TO REACH CORNER

PLANE COORDINATE POSITION DATA

State _____ Zone _____

X _____

Y _____

Estab. By _____
Agency

Signature

Title

Division

Headquarters

Date

7100-52-(3/68)

CORNER RECORD (PERPETUATION)

MONUMENT: DESCRIBE NEW MONUMENT SET, OR WORK DONE TO PRESERVE EXISTING MONUMENT

Set an iron post 28" long by 2½" dia. 24" in the ground with brass cap marked:

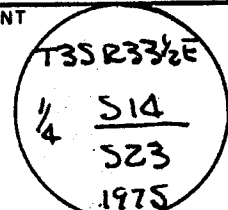

ACCESSORIES: DESCRIBE NEW BT'S WITNESS OBJECTS ETC. ESTABLISHED, OR WORK DONE TO PRESERVE EXISTING EVIDENCE

A pine 10" dia. bears S. 61½° E. 79 lks. dist. marked $\frac{1}{4}$ S23 BT
 A pine 7" dia. bears N. 75½° W. 32 lks. dist. marked $\frac{1}{4}$ S14 BT

Deposit corner stone along side the iron post.

Work Done By Garrison Title C. surveyor Date 7/75 State Registration No. BLM
 or Agency _____

Certified Cor. Record Prepared? Yes No Filed At: _____ Date _____

REMARKS

Index File No. _____ T. _____ R. _____ M. _____ Tract or Surv. No. _____ Cor. _____

UNION COUNTY SURVEYOR

Date Received _____

Date Filed 12-18-87

By S. LANSBURY, Deputy

File No. 220-87R

N-19

T3S33 1/2 N19

Remonumentation of Certain Original Corner Points,
T. 3 S., R. 33 1/2 E., Willamette Meridian, Oregon

CHAINS

At the corner point

Set an iron post, 28 ins. long, 2 1/2 ins. diam., 24 ins. in the ground, with brass cap mkd.

T 3 S R 33 1/2 E
S 22 | S 23
S 27 | S 26
1975

from which new bearing trees

A fir, 6 ins. diam., bears N. 7 1/2° E., 17 lks. dist., mkd. T3S R33 1/2 E S23 BT.

A fir, 9 ins. diam., bears N. 34 1/4° W., 48 lks. dist., mkd. T3S R33 1/2 E S22 BT.

The 1/4 sec. cor. of secs. 14 and 23, monumented with a basalt stone, 16 x 13 x 8 ins., firmly set 4 ins. in the ground, no marks visible, from which the remains of the original bearing trees:

A root hole, bears S. 68° E., 117 lks. dist., with a down and decayed pine alongside, 10 ins. diam., with scribe marks BT visible on decayed blaze.

A pine snag, 15 ins. diam., bears N. 84° W., 80 lks. dist., with scribe marks 1/4 S visible on partially healed blaze.

At the corner point

Set an iron post, 28 ins. long, 2 1/2 ins. diam., 24 ins. in the ground, with brass cap mkd.

T 3 S R 33 1/2 E
1/4 S 14
S 23
1975

from which new bearing trees

A pine, 10 ins. diam., bears S. 61 1/4° E., 79 lks. dist., mkd. 1/4 S23 BT.

A pine, 7 ins. diam., bears N. 75 1/2° W., 32 lks. dist., mkd. 1/4 S14 BT.

Deposit corner stone alongside iron post.

The cor. of secs. 10, 11, 14, and 15, monumented with a basalt stone, 13 x 10 x 8 ins., firmly set 7 ins. in the ground, no marks visible, from which the remains of the original bearing trees:

A decayed fir stump, 14 ins. diam., bears N. 36° E., 72 lks. dist., with scribe marks T3S R33 1/2 E S11 visible on decayed blaze.

A fir, 22 ins. diam., bears S. 68° E., 34 lks. dist., with healed blaze. (Record, 41 lks.)

A root hole, bears S. 42° W., 34 lks. dist., with a down and decayed fir alongside, 36 ins. diam., no marks visible.

T3S33 1/2 N19

UNION COUNTY
SURVEYOR

Date Received 3/15/13

Date Filed 3/15/13

By [Signature] DEPUTY

File No. 368-2013R