

CERTIFIED RECORD OF LAND CORNER MONUMENTATION

INDEX: V-13

History of original corner establishment:

- A. Corner established by US Deputy Surveyor Herman D. Gradon under his contract number 517 dated Sept. 30, 1884. Surveyor General's Record states: Var. 20E Set a basalt stone 18x12x6 ins., 12 ins. in the ground for cor. to secs. 27,28,33 & 34 marked with 1 notch on S. and 3 notches on E. edge; from which
  - A fir, 30 ins. diam., bears N.40E., 53 lks. dist., marked T3N R40E S27 BT.
  - A fir, 8 ins. diam., bears S.40E., 43 lks. dist., marked T3N R40E S34 BT.
  - A fir, 8 ins. diam., bears S.13W., 20 lks. dist., marked T3N R40E S33 BT.
  - A pine, 12 ins. diam., bears N.60W., 67 lks. dist., marked T3N R40E S28 BT.

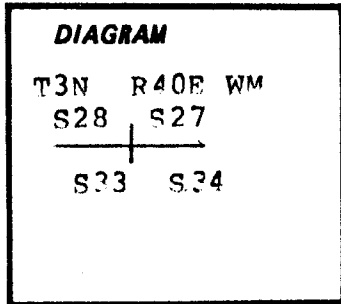

Description of corner evidence found:

B. MONUMENT FOUND:

none; steep sidehill with old three way fence corner and lines near the healthy bearing tree. At locus of corner position is a live fir tree with four sides blazed and well healed.

ACCESSORIES FOUND:

15" dia douglas fir in southeast quadrant with healed blaze that has been partially opened. Visible scribe marks. badly burned root collar remains of fir in the northeast quadrant.

Description of monument and accessories established to perpetuate the original location of this corner:

- C. After diligent search for original stone and other bearing trees, I set a 3.5 inch diameter aluminum cap in a 0.75 inch diameter by 6 feet long iron pipe at locus of record bearings and distances from original bearing trees. Cap is 1.3 feet above ground in a large mound of stone. Cap is marked:

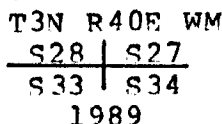

STRYKER PLS 2060

NEW ACCESSORIES ESTABLISHED with magnetic declination of 19 deg. East

- 9" dia douglas fir bears S79W at 14.9 ft scribed "T3N R40E S33 BT"
  - 13" dia douglas fir bears N13W at 4.4 ft scribed "T3N R40E S28 BT"
  - 13" dia douglas fir bears N89E at 12.7 ft scribed "T3N R40E S27 BT"
  - 15" dia douglas fir bears S39E at 28.0 ft (healthy original BT)
- Painted red band around each bearing tree.  
Placed brass washer marked "PLS 2060" at base of each new BT blaze  
Placed LAND SURVEYOR MEMBER LSAW metal signs on each bearing tree  
Placed steel fence post at corner.

Office of..... County of.....  
State of....., I hereby certify that the within instrument was filed in this office for record on the..... day of.....

..... by  
(COUNTY OFFICIAL)

**UNION COUNTY SURVEYOR**  
(DEPUTY)

Date Received 8-30-89  
Date Filed 9-1-89  
By G. LANGRISH DEARY  
File No. 168-89R

REGISTERED PROFESSIONAL LAND SURVEYOR

*Edwin A. Stryker*  
★ P.O. 189-692-001

OREGON  
JULY 15, 1983  
EDWIN A. STRYKER  
2060

**CERTIFIED RECORD OF LAND CORNER MONUMENTATION**

**HISTORY OF ORIGINAL CORNER ESTABLISHED:**

Corner originally established by Herman D. Gradon under GLO joint contract No. 517, dated Sept. 30, 1884. Surveyor General field notes state:

Set basalt stone 18x12x6 ins., 12 ins. in the ground for cor. to secs. 27,28,33, and 34 marked with 1 notch on E and 3 notches on E. edge, from which:  
 A 30" fir bears North 40° East a dist. of 53 lks. marked T3N R40E S27 BT.  
 An 8" fir bears South 40° East a dist. of 43 lks. marked T3N R40E S34 BT.  
 An 8" fir bears South 13° West a dist. of 20 lks. marked T3N R40E S33 BT.  
 A 12" fir bears North 60° West a dist. of 67 lks. marked T3N R40E S28 BT.

T 3 N R 40 E V-13

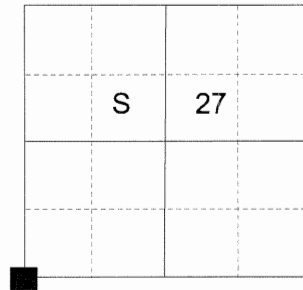

In Union County Survey 019-89 Edwin Stryker PLS 2060 searched for the corner and found a 15" diam. Douglas Fir in the South East quadrant with healed blaze that had been partially opened with visible scribe marks as well as a badly burned root collar remnant in the North East quadrant. Union County Monumentation Record states: I set a 3.5 inch diameter aluminum cap on a 0.75 inch diameter by 6 feet long iron pipe at locus of record bearings and distances from original bearing trees. Cap is 1.3 feet above ground in a large mound of stone.  
 From which:  
 A 9" fir bears South 79° West a dist. of 14.9 ft. marked T3N R40E S33 BT.  
 A 13" fir bears North 13° West a dist. of 4.4 ft. marked T3N R40E S28 BT.  
 A 13" fir bears North 89° East a dist. of 12.7 ft. marked T3N R40E S27 BT.  
 A 15" fir bears South 39° East a dist. of 28.0 ft. (healthy original BT)

**DESCRIPTION OF CORNER EVIDENCE FOUND:**

Found a 3/4" galv. pipe 15" above ground with 3 1/2" aluminum cap marked as shown in a large mound of stone.  
 From which:  
 A 9" Douglas fir bears South 79° West a dist. of 14.9 ft. alive and vigorous with healed blaze.  
 A 16" Douglas fir bears North 13° West a dist. of 4.4 ft. alive and vigorous with healed blaze.  
 A dead and down 13" Douglas fir with healed blaze bears North 89° East a dist. of 12.7 ft. to root hole.  
 A 16" Douglas fir bears South 40° East a dist. of 28.0 ft. alive and vigorous with partially open blaze (healthy original BT).

**DESCRIPTION OF MONUMENT AND ACCESSORIES I ESTABLISHED TO PERPETUATE THE ORIGINAL LOCATION OF THIS CORNER:**

**NEW BEARING TREES:**

An 8" Douglas fir bears North 51° East a dist. of 20.65 marked T3N R40E S27 BT.

Monument falls in a North South running fence line. A fence corner bears South approx. 20 feet from which fences bear East, West, South, and North.

I hereby certify that the corner was perpetuated on April 24, 2018.

Witness: Kyle A. Tucker

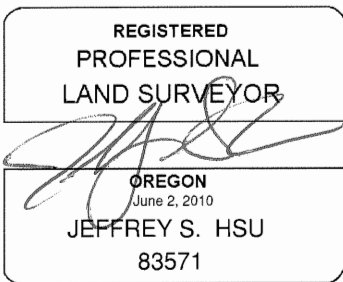

Renewal Date: June 30, 2019

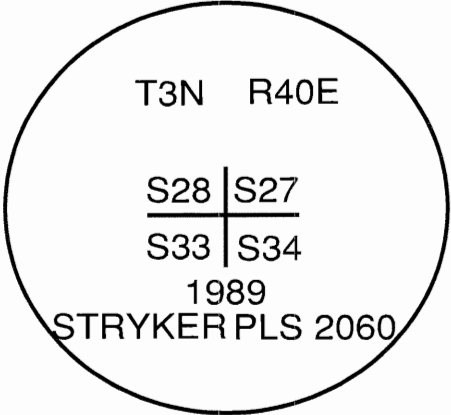

I used a steel tape and magnetic compass in the establishment of the new accessories. I used 13° East declination, the distances are to a 60d spike driven into the right side of the root crown of the bearing trees. A brass washer marked OPLS 83571 is attached to the BT blaze of the new bearing trees.

**UNION COUNTY SURVEYOR**

Date Received 4/25/18

Date Filed 4/25/18

Filed By [Signature]

File Number 01A-2018R

# HORIZONTAL CONTROL DATA

## UNION COUNTY, OREGON

### OREGON STATE PLANE, NORTH ZONE (3601)

STA NAME: 2018026

SECTION CORNER COMMON TO SECTIONS 27, 28, 33 AND 34

TWP. 3 N RGE. 40 E.

GEODETIC COORD: NAD 83(91)

DATE TIED: April 24, 2018

LAT: 45 ° 42 ' 14.17833 " N

SURVEYOR: RICK G. ROBINSON  
OPLS 2219

LONG: 117 ° 48 ' 30.13373 " W

FIRM: BAGETT, GRIFFITH, & BLACKMAN  
2006 ADAMS AVENUE  
LAGRANDE, OR 97850  
(541) 963-6092

SP. COOR: NAD 83(91)

N: 754200.162 INT FT.

E: 8889632.599 INT FT.

TYPE: GPS

THETA: 1 ° 54 ' 31.9176657 "

ORDER: SECOND CLASS: 1

SCALE FACTOR: 0.9999382021

ELEV: 3138.79 US FT.

ELEV: DATUM: NGVD 29

**COMMENTS:**

3 1/2" aluminum cap on 3/4" iron pipe set  
in mound of stone, with cap marked  
as shown.

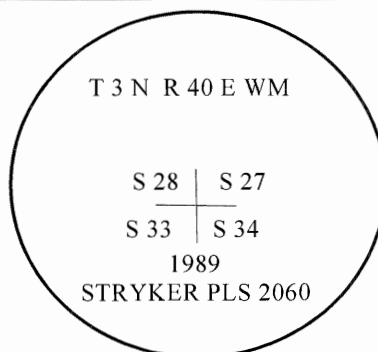

REGISTERED  
PROFESSIONAL  
LAND SURVEYOR

*Rick G. Robinson*  
OREGON  
July 17, 1986  
RICK G. ROBINSON  
2219

Renewal Date: December 31, 2018

1 METER = 3.2808333333... US FEET = 39.37 INCHES

1 METER = 3.280839895 INT'L FEET OR 1 INCH = 2.54 CM

TO CALCULATE ELEVATION FACTOR ( IN THE NORTH AMERICAN CONTINENT)

DIVIDE 20,906,000 BY (20,906,000 + ELLIPSOID ELEV. IN FEET)