

T-1

History of original corner establishment:

Corner was established by Rufus S. Moore, Contract No. 437. Commenced July, 1882, and completed August, 1883.

40.00 set a tamarack post 3 feet long 3 inches square 24 inches in ground. From which:

- A tamarack 18 inches diameter bears S 87° E 53 lks. dist.
- A tamarack 44 inches diameter bears N 73° W 33 lks. dist.

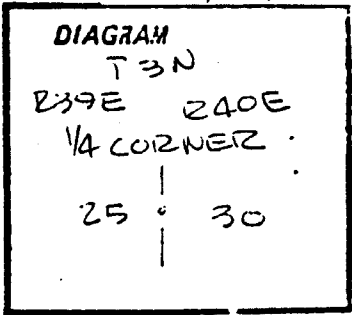

Description of corner evidence found:

Found a brass cylinder laying horizontal in concrete and stamped "S 25-30." No record of this remonumentation can be found; however, parole evidence indicates this to be an acceptable corner.

Description of monument and accessories established to perpetuate the original location of this corner:

No accessories established.

UNION COUNTY SURVEYOR

Date Received _____

Date Filed _____

By _____

File No: 214-83R

CERTIFIED RECORD OF LAND CORNER MONUMENTATION

T-1

History of original corner establishment:

Survey was performed by Rufus Moore, Deputy Surveyor, under Contract No. 437 dated June 3, 1882. He set a tamarack post for the $\frac{1}{4}$ corner common to Sections 25 & 30 T 3 N R 39 and 40 E.

The bearing trees were:

A tamarack 18" dia. bears S 87 E, 53 lks. dist. scribed $\frac{1}{4}$ S BT.

A tamarack 44" dia. bears N 73 W, 33 lks. dist. scribed $\frac{1}{4}$ S BT.

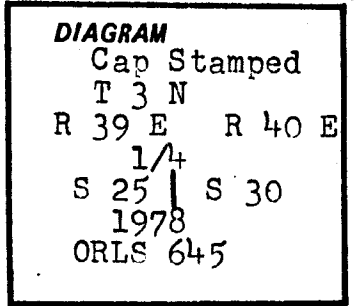

Description of corner evidence found:

Found a tamarack stump approx. 48" dia. in Section 25. The stump is badly weathered though Earl Tarbell testified that he saw $\frac{1}{4}$ S BT scribed faintly on the stump about 15 to 20 years ago. I also found a block of concrete 12" x 8" x 6" with a piece of brass imbeded in the surface and stamped $\frac{1}{4}$ 25-30, though this block bears N 73 E, 21.8 feet from the above tamarack stump instead of S 73 E, 21.8 feet as is called for in the original GLO notes. I therefore rejected the block of concrete as the actual $\frac{1}{4}$ corner and set a new monument as per the description in the GLO notes.

Description of monument and accessories I established to perpetuate the original location of this corner:

I set a stamped 2 $\frac{1}{2}$ " brass cap on a 30" galv. iron pipe at the $\frac{1}{4}$ corner location by using the bearing and distance from the bearing tree stump as previously described. I placed the monument 8" below the surface of the county road to protect it from possible grader activity. I then set new bearing trees as follows:

A pine 28" dia. bears S 21 E, 97.5 feet and scribed $\frac{1}{4}$ S S 30 BT.

A pine 34" dia. bears S 84 30 W, 135.25 feet and scribed $\frac{1}{4}$ S S 25 BT.

REGISTERED
PROFESSIONAL
LAND SURVEYOR

James H. Hambleton
3-20-78

OREGON
JULY 10, 1984
JAMES H. HAMBLETON
645

Office of..... County of.....

State of....., I hereby certify that the within instrument was filed in this

for record on the..... day of....., 19.....

..... by
(COUNTY OFFICIAL)

(DEPUTY)

UNION COUNTY SURVEYOR	
Date Received _____	
Date Filed _____	R GPO-798-276
By _____	
File No. <u>215-83R</u>	

**UNION COUNTY SURVEYOR
CERTIFIED RECORD OF LAND CORNER MONUMENTATION**

HISTORY OF ORIGINAL CORNER ESTABLISHMENT:

Corner originally established by Rufus S. Moore under GLO contract number 437, dated June 3, 1882. GLO record states: Set post for ¼ Sec Cor, from which:

A Tamarack 18 in diam bears S 87° E, 53 Lks dist
A Tamarack 44 in diam bears N 78° W, 33 Lks dist
Corner was visited by Jim Buisman (No date)
Monumentation record 214-83R states "Found brass cylinder laying horizontal in concrete and stamped "S 1/4 25-30. No record of this remonumentation can be found; however, parole evidence indicates this to be an acceptable corner" Corner remonumented by James Hambleton in 1978.

Monumentation record 215-83R states "Found tamarack stump in Section 28..I also found a block of concrete 12"x8"x6" with a piece of brass..This bears N73E instead of S73E as called for in the GLO notes. I therefore rejected the block and set a new monument as per the GLO notes..Set 2 ½" brass cap monument 8" below the road surface..I set new bearing trees as follows: A Pine 28" dia. Bears S21E, 97.5 feet and scribed 1/4S S30 BT. A Pine 34" dia. Bears S84-30W, 135.25 feet and scribed 1/4S S25 BT"

No record of subsequent monumentation found in UNION COUNTY survey records.

DESCRIPTION OF CORNER EVIDENCE FOUND:

Found a 34" Ponderosa Pine S21°E, 97.5 feet, live and vigorous with blaze evident. Found a 44" Ponderosa Pine stump S84°30'W, 135.25 feet.

SEE SURVEY NUMBER 017-2005

T 3 N R 39 E T-25

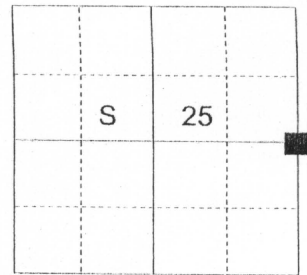

DESCRIPTION OF MONUMENT AND ACCESSORIES I ESTABLISHED

TO PERPETUATE THE ORIGINAL LOCATION OF THIS CORNER:

At record bearing and distance from the found Hambleton bearing trees, I set a 5/8"x 30" "copper clad" iron pin with 2½" brass cap marked as shown, 30" in the ground, in a water valve box (Corner falls in paved road), from which:

NEW BEARING TREES:

A 20 inch diameter Ponderosa Pine bears N 62° E, a distance of 239.38 feet, marked T3N R40E 1/4 S30 BT.

An 8 inch diameter Ponderosa Pine bears S 60° W, a distance of 304.77 feet, marked T3N R39E 1/4 S25 BT.

A 9 inch diameter Ponderosa Pine bears N 12° W, a distance of 118.64 feet, marked T3N R39E 1/4 S25 BT.

I hereby certify that the corner was monumented on August 22, 2005.

Witness: Greg Blackman, Jr., Mark Brooks, Rick Thew

REGISTERED
PROFESSIONAL
LAND SURVEYOR

Rick G. Robinson

OREGON
July 17, 1906
RICK G. ROBINSON
2219

Renewal Date: December 31, 2006

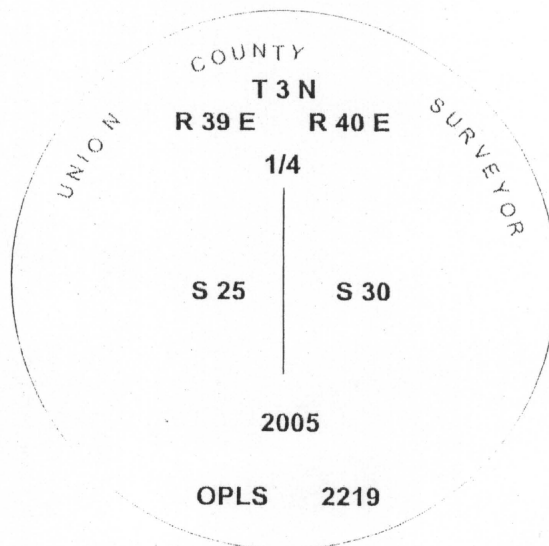

**UNION COUNTY
SURVEYOR**

Date Received 9/15/05

Date Filed 9/15/05

Filed By *[Signature]*

File Number 037-2005R

I used a steel tape and magnetic compass in the establishment of the new accessories. I used 18° East declination, the distances are to a 60d spike driven into the right side of the root crown of the new bearing trees. A brass washer marked OPLS 2219 is attached to the BT blaze of the new bearing trees.

HORIZONTAL CONTROL DATA

UNION COUNTY, OREGON

OREGON STATE PLANE, NORTH ZONE (3601)

STA NAME: 200548

1/4 SECTION CORNER COMMON TO SECTIONS 25 and 30

TWP. 3 N. RGE. 39 E.
& 40

GEODETIC COORD: NAD 83(91)

DATE TIED: September 15, 2005

LAT: 45 ° 42 ' 40.04851 " N

SURVEYOR: RICK G. ROBINSON
OPLS 2219

LONG: 117 ° 51 ' 11.61776 " W

FIRM: BAGETT, GRIFFITH, & BLACKMAN
2006 Adams Avenue
La Grande, OR 97850
(541) 963-6092

SP. COOR: NAD 83(91)

N: 756301.470 INT FT.

E: 8873837.795 INT FT.

TYPE: GPS

THETA: 1 ° 52 ' 54.8442841 "

ORDER: SECOND CLASS: 1

SCALE FACTOR: 0.9999393833

ELEV: 2762.23 US FT.

ELEV: DATUM: NGVD 29

COMMENTS:

5/8"x30" copper clad iron pin with
2 1/2" aluminum monument marked:
Set in water valve box in road

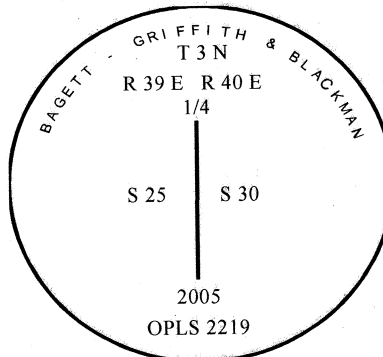

REGISTERED
PROFESSIONAL
LAND SURVEYOR

Rick G. Robinson
OREGON
July 17, 1986
RICK G. ROBINSON
2219

Renewal Date: December 31, 2006

1 METER = 3.280833333... US FEET = 39.37 INCHES

1 METER = 3.280839895 INT'L FEET OR 1 INCH = 2.54 CM

TO CALCULATE ELEVATION FACTOR (IN THE NORTH AMERICAN CONTINENT)

DIVIDE 20,906,000 BY (20,906,000 + ELLIPSOID ELEV. IN FEET)