

**CERTIFIED RECORD OF LAND CORNER MONUMENTATION**

**HISTORY OF ORIGINAL CORNER ESTABLISHED:**

Corner originally established by Herman D. Gradon under GLO contract 517, dated September 30, 1884. Surveyor General field notes state:

Set a basalt stone 13x9x7 ins. 9 ins. in the ground for cor. to secs. 19, 20, 29 and 30, marked with 2 notches on S and 5 notches on E edges, from which:

- A pine 30 ins in diam bears N31°E, 34 lks. dist. marked T3N R40E S20 BT.
- A pine 27 ins. in diam bears S34°E, 72 lks. dist. marked T3N R40E S29 BT.
- A pine 18 ins. in diam. bears S15°W, 207 lks. dist. marked T3N R40E S30 BT.
- A pine 26 ins. in diam. bears N54°W, 26 lks. dist. marked T3N R40E S19 BT.

T 3 N R 40 E R-05

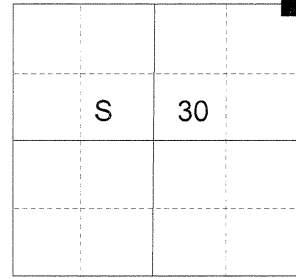

**DESCRIPTION OF CORNER EVIDENCE FOUND:**

An old rock jack fence corner occupies the corner position. Fences bears North and West. Due to harmony with corners to the West, South and East, I accept the position of the rock jack as the best available evidence of the original GLO corner position.

SEE SURVEY NUMBER 028-2016

**DESCRIPTION OF MONUMENT AND ACCESSORIES I ESTABLISHED**

**TO PERPETUATE THE ORIGINAL LOCATION OF THIS CORNER:**

At the fence corner position, I set a 2 ½" x 30" aluminum pipe with 2 ½" aluminum cap, marked as shown below, 18 inches in the ground, in a mound of stone 3 ft. diam., from which:

**NEW BEARING OBJECTS:**

- A 5/8" iron pin bears North 34° East, a distance of 13.28 feet, with 1 ½" aluminum cap marked BGB SURVEY MARKER NE RP.
- A 14" Ponderosa Pine bears South 6° East, a distance of 92.45 feet, marked T3N R40E S29 BT.
- An 18" Ponderosa Pine bears South 34° West, a distance of 137.70 feet, marked T3N R40E S30 BT.
- A 5/8" iron pin bears North 20° West, a distance of 10.08 feet, with 1 ½" aluminum cap marked BGB SURVEY MARKER NW RP.

Drove a steel fencepost approx 1.5 feet North of monument.  
I hereby certify that this monument was set on August 30, 2016.

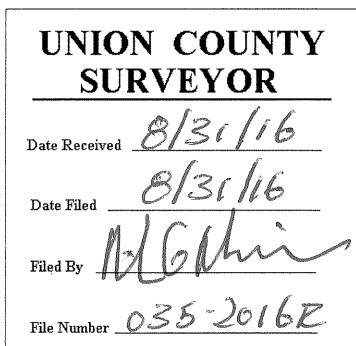
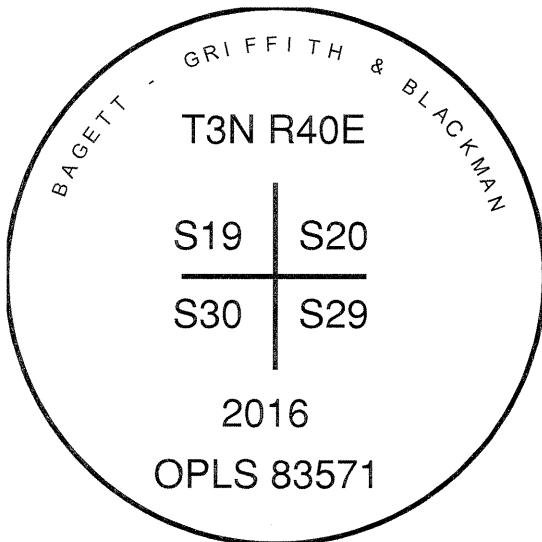

I use a steel tape and magnetic compass in the establishment of the bearing objects. Magnetic declination used was 15° East. Distances to the new trees are to a spike in the root crown of the trees. Bearings are to a brass washer in the lower blaze marked OPLS 83571. Bearings and distance to the iron pin accessories are to the center of the aluminum caps.