

**CERTIFIED RECORD OF LAND CORNER MONUMENTATION**

**HISTORY OF ORIGINAL CORNER ESTABLISHED:**

Corner originally established by Herman D. Gradon under GLO contract 517, dated September 30, 1884. Surveyor General field notes state:

Set a basalt stone 12x12x10 ins. 8 ins. in the ground for 1/4 sec. cor., marked 1/4 on N face, from which:

- A fir 8 ins. in diam. bears N5°W, 11 lks. dist. marked 1/4 S BT.
- A fir 12 ins. in diam. bears S49°W, 13 lks. dist. marked 1/4 S BT.

T 3 N R 40 E R-03

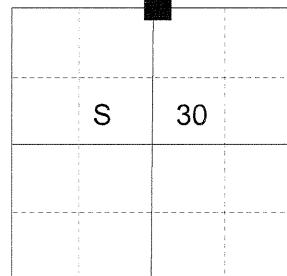

**DESCRIPTION OF CORNER EVIDENCE FOUND:**

None.

SEE SURVEY NUMBER 028-2016

**DESCRIPTION OF MONUMENT AND ACCESSORIES I ESTABLISHED**

**TO PERPETUATE THE ORIGINAL LOCATION OF THIS CORNER:**

At proportionate position, I set a 2 1/2" x 30" aluminum pipe with 2 1/2" aluminum cap, marked as shown below, 20 inches in the ground, in a collar of stone 1 ft. diam., from which:

**NEW BEARING OBJECTS:**

- A 5" Douglas Fir bears North 3° East, a distance of 105.50 feet, marked 1/4 S19 BT.
- A 4" Ponderosa Pine bears South 81° East, a distance of 100.25 feet, marked 1/4 S30 BT.
- A 12" Ponderosa Pine bears West a distance of 50.85 feet, marked 1/4 S30 BT.
- A 5" Ponderosa Pine bears North 61° West, a distance of 42.50 feet, marked 1/4 S19 BT.

Drove a steel fencepost approx 1 ft East of monument.

I hereby certify that this monument was set on August 30, 2016.

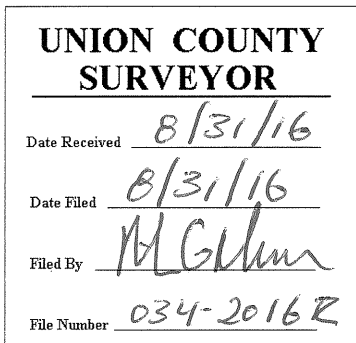
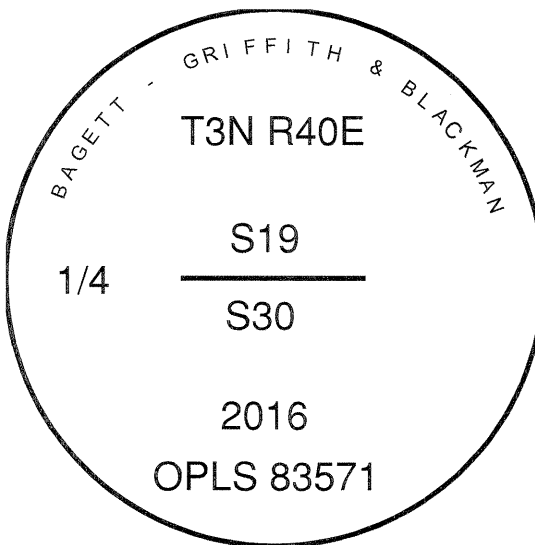

I use a steel tape and magnetic compass in the establishment of the bearing objects. Magnetic declination used was 15° East. Distances to the new trees are to a spike in the root crown of the trees. Bearings are to a brass washer in the lower blaze marked OPLS 83571.