

CERTIFIED RECORD OF LAND CORNER MONUMENTATION

Index File No. N-13

History of original corner establishment:

Corner established by H. D. Graden under GLO contract No. 517, in November, 1884. Surveyor General's notes state: "Set a basalt stone 16 x 12 x 12 ins. 11 ins. in the ground, for cor. to secs. 15, 16, 21, and 22, marked with 3 notches on S. and E. edges. From which: A pine 10 ins. in diam. bears N10°E, 15 lks. dist., marked T3NR40E S15 BT. A pine 30 ins. in diam., bears N65°W, 59 lks. dist., marked T3NR40E S16 BT. A pine 8 ins. in diam., bears S67°E, 15 lks. dist., marked T3NR40E S22 BT. A pine 8 ins. in diam. bears S40°W, 63 lks. dist., marked T3NR40E S21 BT."

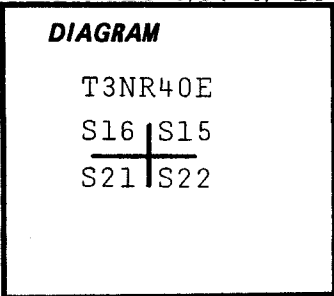

Description of corner evidence found:

Found 19 x 16 x 8 inch stone, clearly marked with 3 notches on south and east sides. No traced of south BTs due to road building. Found 21" pine, N40°E, 11.0 ft. A 30" pine stump, N63°W, 36.5 ft. with BT blaze left. Magnetic Variation used. N20°E.

Description of monument and accessories established to perpetuate the original location of this corner:

At center of the above described stone, set 2 1/2" x 30" galvanized pipe with brass cap marked: Set pipe 24" in the ground and mound of stone around to cap. Placed marked stone at base of pipe. From which: A 20" pine bears S38°E, 93.8 ft., scribed T3NR40E S22 BT. A fir 28" in diam. bears S15°W, 18.6 ft. scribed T3NR40E S21 BT. A 15" pine bears N40°W, 65.0 ft. scribed T3NR40E S16 BT. Placed 54-3s and brass washer stamped PLS 1051 on BTs. Placed 54-3 on old BTs. Painted blazes red and 6" red band around.

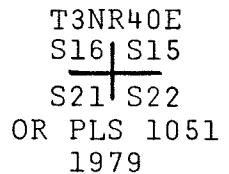

I hereby certify that the above corner monument was reestablished as herein described.

Witnesses: David L. Landers
Daniel T. Rowland
Ray McVey

May 29, 1979

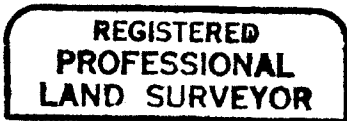

Barry B. Barbour

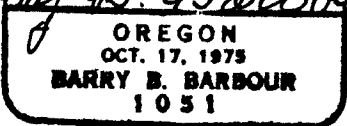

Office of...County Surveyor..... County of...Union.....

State of...Oregon....., I hereby certify that the within instrument was filed in this office for record on the...9th day of...June....., 1979.

..... by (COUNTY OFFICIAL) (DEPUTY)

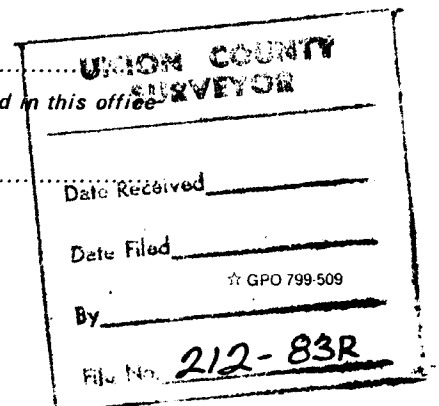

CERTIFIED RECORD OF LAND CORNER MONUMENTATION

HISTORY OF ORIGINAL CORNER ESTABLISHMENT:

Originally set by the subdivision of Township 3 North, Range 40 East by Herman Gradon in Contract Number 517, dated September 30, 1884. Surveyor General record states:

Set a basalt stone 16x12x12 ins 11 ins in the ground for Cor. to Secs. 15, 16, 21 and 22, marked with 3 notches on S. and 3 notches E. edges, from which:
 A pine 10 ins. in diam. bears N10°E, 15 lks. dist., marked T3N R40 S15 BT.
 A pine 30 ins. in diam. bears N65°W, 59 lks. dist., marked T3N R40E S16 BT.
 A pine 8 ins. in diam. bears S67°E, 15 lks. dist., marked T3N R40E S22 BT.
 A pine 8 ins. in diam. bears N40°W, 63 lks. dist., marked T3N R40E S21 BT.

T 3 N R 40 E N-13

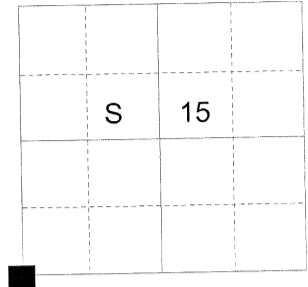

Corner found by Barry Barbour in 1979. Union County Surveyor monumentation record 212-83R states:
 Found 19x16x8 inch stone clearly marked with 3 notches on south and east edges. No traces of south Bts due to road building. Found 21" pine, N40°E, 11.0 ft. A 30" pine stump, N63°W, 36.5 ft. with BT blaze left.

A the center of the above described stone set 2 ½" by 30" galvanized pipe with brass cap marked as shown below: Set pipe 24" in the ground and mound of stone around to cap. Placed marked stone at base of pipe. From which: A 20" pine bears S38°E, 93.8 ft., scribed T3NR40E S22 BT. A 15" pine bears N40°W, 65.0 ft. scribed T3NR40E S16 BT.

DESCRIPTION OF CORNER EVIDENCE FOUND:

Found a 2 ½" iron pipe with a 2 ½" brass cap, marked as shown below, 11 inches above ground, from which:
 A 27 inch Ponderosa Pine bears North 42° East, a distance of 11.0 feet, alive and vigorous with healed blaze.
 A 35 inch Douglas Fir bears South 11° West, a distance of 18.6 feet, alive and vigorous with healed blaze.
 A 21 inch Ponderosa Pine bears North 43° West, a distance of 65.0 feet, alive and vigorous with healed blaze.
 A 15 inch stump bears North 50° West, a distance of 36.5 feet, with no scribe marks visible.

DESCRIPTION OF MONUMENT AND ACCESSORIES I ESTABLISHED TO PERPETUATE THE ORIGINAL LOCATION OF THIS CORNER:

NEW BEARING TREE:
 A 12 inch Ponderosa Pine bears North 76° West, a distance of 127.15 feet, marked X BT.

I hereby certify that the corner was perpetuated on August 30, 2012.
 Witness: Rick Robinson

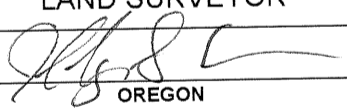
REGISTERED PROFESSIONAL LAND SURVEYOR

OREGON June 2, 2010 JEFFERY S. HSU 83571

Renewal Date: June 30, 2013

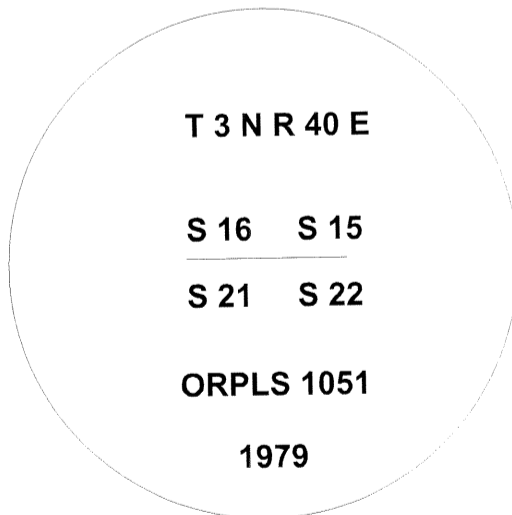
UNION COUNTY SURVEYOR
Date Received <u>9/7/12</u>
Date Filed <u>9/7/12</u>
Filed By <u>R. Robinson, Deputy</u>
File Number <u>035-2012R</u>



I used a steel tape and magnetic compass in the establishment of the new accessories. I used 16° East declination, the distances are to a 60d spike driven into the right side of the root crown of the new bearing tree. A brass washer marked OPLS 83571 is attached to the BT blaze of the new bearing tree.