

CERTIFIED RECORD OF LAND CORNER MONUMENTATION

History of original corner establishment:

Original survey by F.W. Campbell, 1884, states:

Set a Pine post 3 ft. long, 3 ins. square, 24 ins. in the ground for 1/4 Sec. corner marked 1/4 S. on West face, from which:

- A Pine 12 ins. diam. bears S74°E 58 lks. dist. marked "1/4 S BT"
- A Pine 27" diam. bears S30°W 113 lks. dist. marked "1/4 S BT"

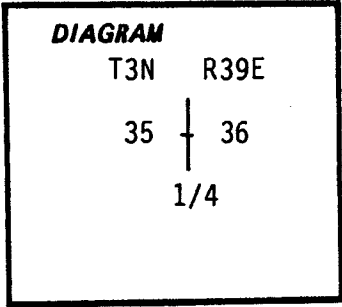

Description of corner evidence found:

No physical evidence of the original corner was found.

Description of monument and accessories I established to perpetuate the original location of this corner:

Original County Road Petition No. 667 dated 1916 for a road now known as Cabin Creek County Road No. 140 states in its legal description: "Beginning at the center post on the West side of Section 36, T3N, R39E, W.M., where said section line intersects with the present County Road, thence due East to center of said Section 36,....."

At the corner site, we find the following: The existing Cabin Creek County Road running Easterly within a well-defined and fenced right-of-way,

The visible ditchlines and roadbed of an abandoned roadway running South-west through a wooded area.

And a well-defined fenceline running northerly from the corner site.

In our opinion, the original location of the 1/4 35/36 T3N, R39E has been perpetuated and can be restored by reference to the existing roadways and evidence of land occupation in the area. We therefore establish the 1/4 corner of Sec. 35 and 36, T3N, R39E in the center of the fenced right-of-way of Cabin Creek County Road at its intersection with the Southerly extension of the line from the NW corner of Sec. 36 through the existing fence corner located along the Northerly fence line as depicted on the Map of Survey being filed concurrently with this record.

At the corner point thus determined, we set a 40 penny spike as a temporary monument due to pending reconstruction of the roadway. We establish the following bearing objects: A 5/8"x30" Iron Rod with yellow

Office of..... County of.....  
 State of....., I hereby certify that the within instrument was filed in this office  
 for record on the..... day of....., 19.....  
 \_\_\_\_\_ by \_\_\_\_\_  
 (COUNTY OFFICIAL) (DEPUTY)

**UNION COUNTY SURVEYOR**

Date Received 6-3-85  
 Date Filed 6-4-85  
 By H.L.P.  
 File No. 33-85 R (1)

CERTIFIED RECORD OF LAND CORNER MONUMENTATION

X-21 2/2

(Continued)

Page 2 of 2 Pages

History of original corner establishment:

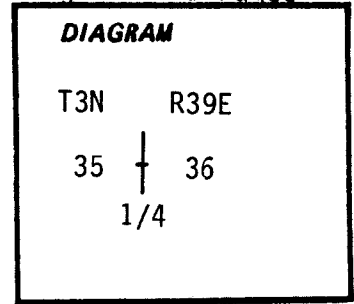

Description of corner evidence found:

Description of monument and accessories I established to perpetuate the original location of this corner:

plastic cap marked "AP&A" attached, set along an existing E-W fence line, bears N64°W 64.92 feet; and a 5/8"x30" Iron Rod with yellow plastic cap marked "AP&A" attached, set along an existing E-W fence line, bears N41°E 37.78 feet.

Magnetic Compass (20° East Declination) Steel Tape

May 1, 1985

Gary Langlitz LS1099  
Greg Orton

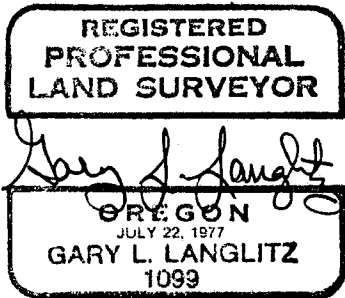

Office of..... County of.....  
State of....., I hereby certify that the within instrument was filed in this office  
for record on the..... day of....., 19.....

..... by .....  
(COUNTY OFFICIAL) (DEPUTY)

**UNION COUNTY SURVEYOR**

Date Received 6-3-85

Date Filed 6-20-85

By H.L.P.

File No. 33-85R(2)

**CERTIFIED RECORD OF LAND CORNER MONUMENTATION**

**HISTORY OF ORIGINAL CORNER ESTABLISHED:**

Corner originally established by F.W. Campbell under GLO contract 498, dated March 10, 1884. Surveyor General field notes state:

Set a pine post 3 ft. long 3 ins. square, 24 ins. in the ground for 1/4 Sec. corner marked 1/4 S on West face, from which:  
A pine 12 in. diam. bears S74°E, 58 lks. dist. marked 1/4 S BT.  
A pine 27 ins. diam. bears S30°W, 113 lks. dist. marked 1/4 S BT.

County Road Petition 667 utilizes this corner. Legal description states "Beginning at the center post on the West side of Section 36, T3N, R39E, WM, where said section line intersects with the present County Road...". Acceptance of wood stake as 1/4 corner by County engineer's office is shown on road plat dated Aug. 19, 1916.

In Survey 14-85, Gary Langlitz places the corner by retracement of the county road, and existing lines of possession. Union County Monumentation record 33-85R states:

We therefore establish the 1/4 corner of Section 35 and 36 in the center of the fenced right-of-way of Cabin Creek county Road at its intersection with the Southerly extension of the line from the NW corner of Sec. 36 through the existing fence corner located along the Northerly fence line. At the corner point thus determined, we set a 40 penny spike as a temporary monument due to pending reconstruction of the roadway. We establish the following bearing objects:

- A 5/8" x 30" iron rod with yellow plastic cap marked "AP&A" attached, set along an existing E-W fence line, bears N64°W., 64.92 feet.
- A 5/8" x 30" iron rod with yellow plastic cap marked "AP&A" attached, set along an existing E-W fence line, bears N41°E., 37.78 feet.

**DESCRIPTION OF CORNER EVIDENCE FOUND:**

Found references set by Survey Number 14-85, at a point established by distance intersection from reference pins:

- A 5/8" x 30" iron rod bears North 64°36'39" West, a distance of 64.92 feet, with yellow plastic cap marked AP&A in East/West fence line.
- A 5/8" x 30" iron rod bears North 38°14'52" East, a distance of 37.78 feet, with yellow plastic cap marked AP&A in East/West fence line.

SEE SURVEY NUMBER 002-2018

**DESCRIPTION OF MONUMENT AND ACCESSORIES I ESTABLISHED**

**TO PERPETUATE THE ORIGINAL LOCATION OF THIS CORNER:**

At a point record distance from found iron pins I set a 5/8"x30" copper clad iron pin with 2 1/2" brass cap marked as shown, level with the asphalt in a 4"x6" cylinder of concrete from which:

**NEW BEARING OBJECTS:**

- A 5/8" x 30" iron pin bears South 64°36'39" East, a distance of 69.70 feet, with 1 1/2" aluminum cap marked UNION COUNTY SURVEYORS SE RP.
- A 5/8" x 30" iron pin bears South 38°14'52" West, a distance of 37.40 feet, with 1 1/2" aluminum cap marked UNION COUNTY SURVEYORS SW RP.

I hereby certify that this monument was perpetuated January 11, 2018

Witness: Kyle Tucker

T 3 N R39E X-21

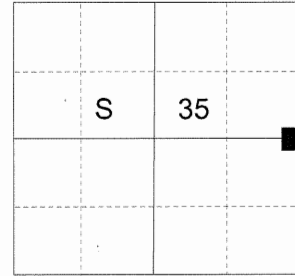

REGISTERED PROFESSIONAL LAND SURVEYOR



OREGON  
June 2, 2010  
JEFFREY S. HSU  
83571

Renewal Date: June 30, 2019

**UNION COUNTY SURVEYOR**

Date Received 1/24/18

Date Filed 1/24/18

Filed By JEFFREY S. HSU

File Number 001-2018R

I use a RTK GPS in the establishment of the accessories. Bearings and distances are to the center of the aluminum caps. Basis of Bearing is as per Survey Number 002-2018.

**HORIZONTAL CONTROL DATA**  
**UNION COUNTY, OREGON**  
**OREGON STATE PLANE, NORTH ZONE (3601)**

STA NAME: 2018006

1/4 SECTION CORNER COMMON TO SECTIONS 35 AND 36

TWP. 3 N RGE. 39 E.

GEODETIC COORD: NAD 83(91)

DATE TIED: January 25, 2018

LAT: 45 ° 41 ' 48.01568 " N

SURVEYOR: RICK G. ROBINSON  
OPLS 2219

LONG: 117 ° 53 ' 26.39831 " W

FIRM: BAGETT, GRIFFITH, & BLACKMAN  
2006 ADAMS AVENUE  
LAGRANDE, OR 97850  
(541) 963-6092

SP. COOR: NAD 83(91)

N: 750862.011 INT FT.

E: 8868704.496 INT FT.

TYPE: GPS

THETA: 1 ° 51 ' 1.81096874 "

ORDER: SECOND CLASS: 1

SCALE FACTOR: 0.9999370237

ELEV: 2820.06 US FT.

ELEV: DATUM: NGVD 29

COMMENTS:

2 1/2" brass cap in concrete set in road surface  
with cap marked as shown.

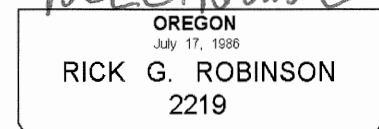
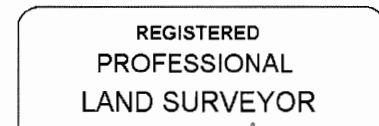
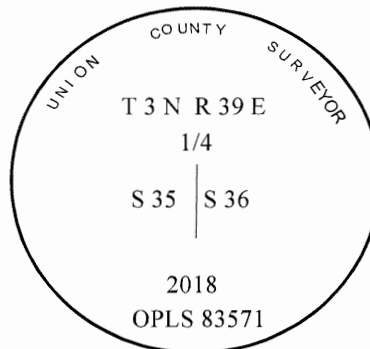

Renewal Date: December 31, 2018

1 METER = 3.2808333333... US FEET = 39.37 INCHES

1 METER = 3.280839895 INT'L FEET OR 1 INCH = 2.54 CM

TO CALCULATE ELEVATION FACTOR ( IN THE NORTH AMERICAN CONTINENT)

DIVIDE 20,906,000 BY (20,906,000 + ELLIPSOID ELEV. IN FEET)