

CERTIFIED RECORD OF LAND CORNER MONUMENTATION

HISTORY OF ORIGINAL CORNER ESTABLISHED:

Corner originally established by F.W. Campbell under GLO contract 498, dated March 10, 1884. Surveyor General field notes state:

T 3 N R39E V-23

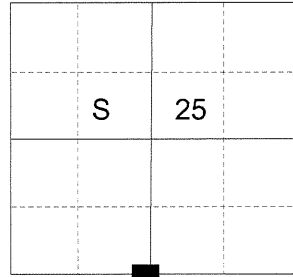

Set a pine post 3 ft. long 3 ins. square, 24 ins. in the ground for 1/4 Sec. corner marked 1/4 S on N. face, from which:

A pine 20 in. diam. bears N3°W, 113 lks. dist. marked 1/4 S BT.

A pine 5 ins. diam. bears S4°E, 11 lks. dist. marked 1/4 S BT.

County Road Petition #667 described the road heading Northerly through this corner. County road engineer's survey notes there is a stake at this location.

In Surveys 49-71 and 77-71, James Voelz appears to set a witness pin to this corner along the East right of way line of Palmer Junction Road.

Survey 14-85 by Gary Langlitz notes the existence of the Voelz pin, but does not note its relevance to the quarter corner position.

DESCRIPTION OF CORNER EVIDENCE FOUND:

The constructed centerline of Palmer Junction Road falls within 3 feet of a proportioned position. A bent smooth iron pin set by Surveys 49-71 and/or 77-71, falls East 23.54 feet from said centerline.

SEE SURVEY NUMBER 023-2016

DESCRIPTION OF MONUMENT AND ACCESSORIES I ESTABLISHED

TO PERPETUATE THE ORIGINAL LOCATION OF THIS CORNER:

At the intersection of a line driven from the Southeast corner of Section 25 through aforementioned pin and the centerline of Palmer Junction Road, I set a cotton spindle (road is slated for reconstruction this summer), from which:

NEW BEARING OBJECTS:

A 5/8" x 30" iron pin bears North 22°44' East, a distance of 74.11 feet, with 1 1/2" aluminum cap marked BGB SURVEY MARKER NE RP.

A 5/8" x 30" iron pin bears South 31°33' East, a distance of 47.81 feet, with 1 1/2" aluminum cap marked BGB SURVEY MARKER SE RP.

A 5/8" x 30" iron pin bears South 39°06' West, a distance of 44.18 feet, with 1 1/2" aluminum cap marked BGB SURVEY MARKER SW RP.

A 5/8" x 30" iron pin bears North 24°43" West, a distance of 64.50 feet, with 1 1/2" aluminum cap marked BGB SURVEY MARKER NW RP.

I hereby certify that this monument was monumented June 25, 2016.

REGISTERED
PROFESSIONAL
LAND SURVEYOR

OREGON
June 2, 2010
JEFFREY S. HSU
83571

Renewal Date: June 30, 2017

**UNION COUNTY
SURVEYOR**

Date Received 7/27/16

Date Filed 7/27/16

Filed By [Signature]

File Number 023-2016R

I use a RTK GPS in the establishment of the accessories. Bearings and distances are to the center of the aluminum caps. Basis of Bearings is as per Survey Number 023-2016.

CERTIFIED RECORD OF LAND CORNER MONUMENTATION

HISTORY OF ORIGINAL CORNER ESTABLISHED:

Corner originally established by F.W. Campbell under GLO contract 498, dated March 10, 1884. Surveyor General field notes state:

Set a pine post 3 ft. long 3 ins. square, 24 ins. in the ground for 1/4 Sec. corner marked 1/4 S on N. face, from which:
A pine 20 in. diam. bears N3°W, 113 lks. dist. marked 1/4 S BT.
A pine 5 ins. diam. bears S4°E, 11 lks. dist. marked 1/4 S BT.

County Engineers plat for County Road Petition #667, dated August 19, 1916 shows the county road going through this corner. Plat shows a stake at 1/4 corner position.

In Surveys 49-71 and 77-71, James Voelz appears to set a witness pin to this corner along the East right of way line of Palmer Junction Road.

Survey 14-85 by Gary Langlitz notes the existence of the Voelz pin, but does not note its relevance to the quarter corner position.

In Survey 023-2016 I place the corner at intersection of a line from the SE corner of Section 25 through the pin set along the East right of way by Survey 49-71 and the centerline of the constructed road. Due to ongoing road construction, a cotton spindle was set in lieu of a durable monument, from which:

- A 5/8" iron pin bears North 22°44' East, a distance of 74.11 feet, with 1 1/2" aluminum cap marked BGB SURVEY MARKER NE RP.
- A 5/8" iron pin bears South 31°33' East, a distance of 47.81 feet, with 1 1/2" aluminum cap marked BGB SURVEY MARKER SE RP.
- A 5/8" iron pin bears South 39°06' West, a distance of 44.18 feet, with 1 1/2" aluminum cap marked BGB SURVEY MARKER SW RP.
- A 5/8" iron pin bears North 24°43" West, a distance of 64.50 feet, with 1 1/2" aluminum cap marked BGB SURVEY MARKER NW RP.

DESCRIPTION OF CORNER EVIDENCE FOUND:

- Found a cotton spindle 2" below top of asphalt at 1/4 corner position from which:
- A 5/8" iron pin bears North 22°44' East, a distance of 74.11 feet, with 1 1/2" aluminum cap marked BGB SURVEY MARKER NE RP.
- A 5/8" iron pin bears South 31°33' East, a distance of 47.81 feet, with 1 1/2" aluminum cap marked BGB SURVEY MARKER SE RP.
- A 5/8" iron pin bears South 39°06' West, a distance of 44.18 feet, with 1 1/2" aluminum cap marked BGB SURVEY MARKER SW RP.
- A 5/8" iron pin bears North 24°43" West, a distance of 64.50 feet, with 1 1/2" aluminum cap marked BGB SURVEY MARKER NW RP.

SEE SURVEY NUMBER 002-2018

DESCRIPTION OF MONUMENT AND ACCESSORIES I ESTABLISHED

TO PERPETUATE THE ORIGINAL LOCATION OF THIS CORNER:

At record distance and bearing from the found iron pins I set a 5/8"x30" copper clad iron pin with 2 1/2" brass cap marked as shown, level with the asphalt in a 4"x6" cylinder of concrete.

I hereby certify that this monument was monumented January 11, 2018

Witness: Kyle Tucker

T 3 N R39E V-23

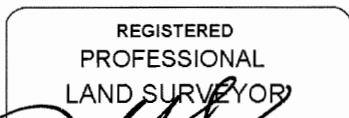
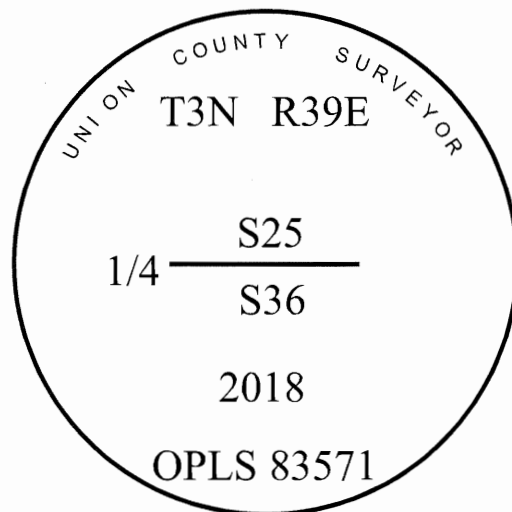
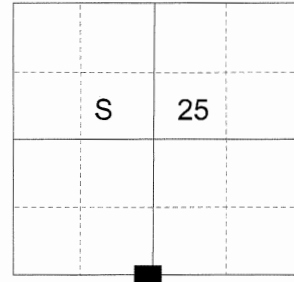

OREGON
June 2, 2010
JEFFREY S. HSU
83571

Renewal Date: June 30, 2019

UNION COUNTY SURVEYOR

Date Received 1/24/18

Date Filed 1/24/18

Filed By [Signature]

File Number 002-2018R

I use a RTK GPS in the retracement of the accessories. Bearings and distances are to the center of the aluminum caps. Basis of Bearing is as per Survey Number 023-2016.