

CERTIFIED RECORD OF LAND CORNER MONUMENTATION

HISTORY OF ORIGINAL CORNER ESTABLISHED:

Corner not previously established.

T 3 N R 39 E S-17

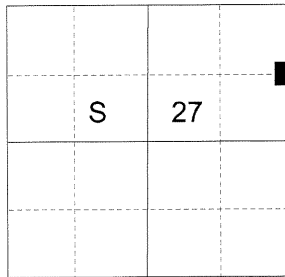

DESCRIPTION OF CORNER EVIDENCE FOUND:

None.

SEE SURVEY NUMBER 066-2015

DESCRIPTION OF MONUMENT AND ACCESSORIES I ESTABLISHED

TO PERPETUATE THE ORIGINAL LOCATION OF THIS CORNER:

At position determined by survey, I set a 5/8" x 30" iron pin with 2 1/2" aluminum cap, marked as shown below, 28 inches in the ground, from which:

NEW BEARING TREES:

An 8" Ponderosa Pine bears North 63° East, a distance of 25.05 feet, marked N1/16 S26 BT.

An 11" Ponderosa Pine bears North 14° West, a distance of 34.85 feet, marked N1/16 S27 BT.

Set a steel fencepost approximately 1 foot North of the corner monument. Corner approximately 11 feet NE of a fence corner.

I hereby certify that the corner was monumented November 19, 2015.

UNION COUNTY SURVEYOR

Date Received 11/20/15

Date Filed 11/20/15

Filed By [Signature]

File Number 174-2015R

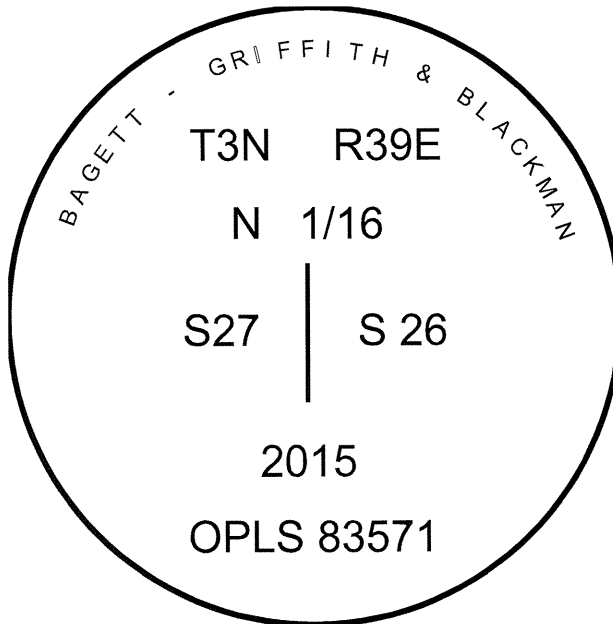

REGISTERED PROFESSIONAL LAND SURVEYOR

[Signature]

OREGON
June 2, 2010

JEFFREY S. HSU
83571

Renewal Date: June 30, 2017

I used a steel tape and magnetic compass in the establishment of the bearing trees. Magnetic declination used was 15° East. Bearings are to a brass washer marked OPLS 83571 in the lower BT blaze. Distances are to at 60d spike in the right hand side of the tree.