

CERTIFIED RECORD OF LAND CORNER MONUMENTATION

Index File No. R-15

History of original corner establishment:

Corner established by F. W. Campbell under GLO contract No. 498 in May, 1884. Surveyors General's notes state: "Set fir post, 3 ft. long, 3 ins. sq., 24 ins. in the ground, for 1/4 sec. cor. mkd. 1/4 on N. face; from which: A pine 24" ins. diam., bears N85°W, 20 lks. dist. mkd. 1/4S BT. A fir 20 ins. diam., bears S4°E, 88 lks. dist. mkd. 1/4S BT."

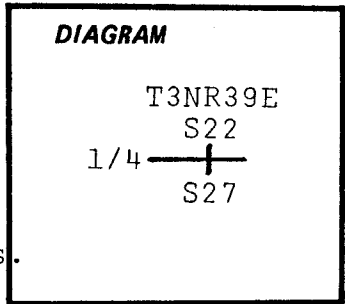

Description of corner evidence found:

Found no trace of corner post. Found 28" pine snag with partially opened blaze and faint scribing visible. From which, measured S85°E, 13.2 ft. No trace of fir BT. Falls in old foad. Corner falls near an East-West fence near an old road. Magnetic variation used. N20°E.

Description of monument and accessories I established to perpetuate the original location of this corner:

At the above described point set 2 1/2" x 30" galvanized pipe with brass cap marked: Set pipe 18" in the ground to bedrock. No rock in the area. From which: A 20" pine bears N51°W, 72.0 ft. scribed 1/4 S22 BT. A 15" pine bears S57°E, 39.7 ft. scribed 1/4 S27 BT. Painted blazes red and 6" red band around. Placed 54-3 and brass washer stamped PLS 1051 on BTs.

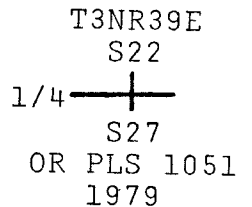

I hereby certify that the above corner monument was reestablished as herein described.

Witnesses: David L. Landers Daniel T. Rowland Ray McVey

May 31, 1979

REGISTERED PROFESSIONAL LAND SURVEYOR

Barry B. Barbour

OREGON OCT. 17, 1979 BARRY B. BARBOUR 1051

Office of...County...Surveyor... County of...Union... State of...Oregon... I hereby certify that the within instrument was filed in this office for record on the 19th day of June, 1979.

(COUNTY OFFICIAL)

(DEPUTY)

OREGON COUNTY SURVEYOR Date Received Date Filed * GEO. 799-509 By File No. 168-83R

CERTIFIED RECORD OF LAND CORNER MONUMENTATION

HISTORY OF ORIGINAL CORNER ESTABLISHED:

Corner originally established by F. W. Campbell, U.S. Deputy Surveyor, under GLO Contract No. 498, dated March 10, 1884. Surveyor General notes state:
Set fir post 3 ft long 3 ins square 24 ins in the ground for 1/4 sec corner marked 1/4 S on N face, from which:
A pine 24 ins diam bears N 85° W, 20 lks dist marked 1/4 S.B.T.
A fir 20 ins diam bears S 4° E, 88 lks dist marked 1/4 S.B.T.

T 3 N R 39 E R-15

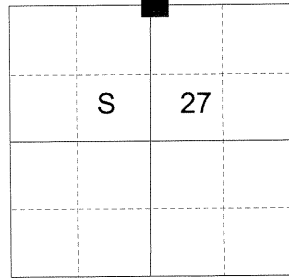

In 1979, Barry Barbour reestablishes this corner from found original evidence. Union County Monumentation record states:

Found no trace of corner post. Found 28" pine snag with partially healed blaze and faint scribing visible. From which, measured S85°E, and East-West fence near and old road. At the above described point, set 2 1/2" x 30" diameter galvanized pipe with brass cap. Set pipe 18" in the ground to bedrock. No rock in the area. From which:
A 20" pine bears N51°W, 72.0 ft. scribed 1/4 S22 BT.
A 15" pine bears S57°E, 39.7 ft. scribed 1/4 S27 BT

DESCRIPTION OF CORNER EVIDENCE FOUND:

Found a 2 1/2" iron pipe with a 2 1/2" brass cap, marked as shown below, 12" above ground. From which:
A 25" Ponderosa Pine bears South 55° East, a distance of 39.7 feet, alive and vigorous with a healed blaze.
A 31" Ponderosa Pine bears North 51° West, a distance of 72.00 feet, alive and vigorous with a healed blaze.

DESCRIPTION OF MONUMENT AND ACCESSORIES I ESTABLISHED TO PERPETUATE THE ORIGINAL LOCATION OF THIS CORNER:

From the pipe monument

NEW BEARING OBJECTS:

A 7" Ponderosa Pine bears North 75° East, a distance of 6.85 feet, marked 1/4 S22 BT.
A 5" ponderosa Pine bears South 50° West, a distance of 4.10 feet, marked 1/4 S27 BT.

Corner falls approximately 40 feet West of a logging road.

I set a steel fencepost approximately 1 foot North of the corner monument.

I hereby certify that the corner was monumented on November 3, 2015.

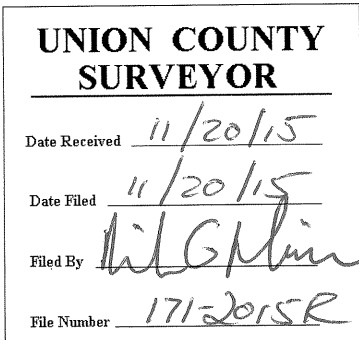
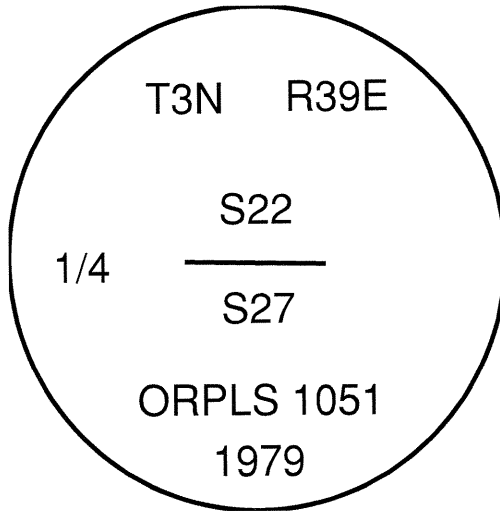

I used a steel tape and magnetic compass in the establishment of the new accessories. I used 15° East declination, the distances are to a 60d spike driven into the right side of the root crown of the bearing trees. A brass washer marked OPLS 83571 is attached to the BT blaze of the new bearing trees.