

**CERTIFIED RECORD OF LAND CORNER MONUMENTATION**

Index File No. R-13

**History of original corner establishment:**

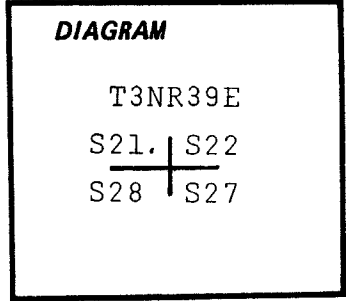

Corner established by F. W. Campbell under GLO contract No. 498 in May, 1884. Surveyors General's notes state: "Set a basalt stone 12 x 12 x 12 ins., 9 ins. in the ground for cor. to secs. 21, 22, 27, and 28, about 300 ft. above branch; mkd. with 2 notches on S. and 3 notches on E. edge: from which A pine, 30 ins. diam. bears N32°W, 126 lks. dist., mkd. T3NR39E S21 BT. A fir 20 ins. diam. bears N50°E, 165 lks. dist. mkd. T3NR39E S22 BT. A pine 8 ins. diam. bears S25°W, 65 lks. dist. mkd. T3NR39E S28 BT. A pine 12 ins. diam. bears S39°E, 150 lks. dist. mkd. T3NR39E S27 BT."

**Description of corner evidence found:**

Found no trace of stone. Corner falls on old road. At a point a 36" pine with partially opened blazes bears N30°W, 83.1 ft.(slope) and a 24" pine bears S39°E, 99.1 ft.(slope) with definite blazes and partially opened. BLM BT tags on both BTs and Boise Cascade location tag on NW BT. Magnetic variation used. N20°E.

**Description of monument and accessories established to perpetuate the original location of this corner:**

At the above described point set 2 1/2" x 30" galvanized pipe with brass cap marked: Set pipe 25" in the ground and mound of stone around to cap. From which: An 11" fir bears N58°E, 52.6 ft., scribed T3NR39E S22 BT. A 9" pine bears S62°W, 33.4 ft., scribed T3NR39E S28 BT. Old BTs are 36" pine bears N30°W, 80.8 ft. and 24" pine bears S39°E, 93.5 ft. Painted blazes red and 6" red band around. Placed 54-3 and brass washer stamped PLS 1051 on BTs. Placed 54-2 and 54-4 on a steel fence post 5' north of corner.

T3NR39E  
S21 | S22  
S28 | S27  
OR PLS 1051  
1979

I hereby certify that the above corner monument was reestablished as herein described.

Witnesses: David L. Landers  
Daniel T. Rowland  
Ray McVey

May 31, 1979

**REGISTERED  
PROFESSIONAL  
LAND SURVEYOR**

*Barry B. Barbour*  
**OREGON  
OCT. 17, 1975  
BARRY B. BARBOUR  
1051**

Office of... County Surveyor..... County of... Union.....  
State of... Oregon....., I hereby certify that the within instrument was filed in this office  
for record on the 19<sup>th</sup> day of... June....., 1979.  
..... by .....  
(COUNTY OFFICIAL) (DEPUTY)

<b>UNION COUNTY SURVEYOR</b>	
Date Received	_____
Date Filed	_____
By	_____
File No.	<u>167-83R</u>

**CERTIFIED RECORD OF LAND CORNER MONUMENTATION**

**HISTORY OF ORIGINAL CORNER ESTABLISHED:**

Corner originally established by F. W. Campbell under GLO Contract Number 498, dated March 10th, 1884. Surveyor General Field Notes state:

T 3 N R 39 E-13

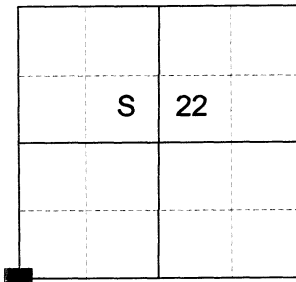

Set basalt stone 12x12x12 ins. 9 ins. in the ground for corner to secs 21-22-27 and 28. about 300 ft. above branch marked with 2 notches on S. and 3 notches on E edges from which:

- A pine 30 ins diam. bears N32°W 126 lks. dist. marked T3NR39E S21 BT
- A fir 20 ins. diam. bears N50°E 165 lks. dist. marked T3NR39E S22 BT
- A pine 8 ins. diam. bears S25°W 65 lks. dist. marked T3NR39E S28 BT
- A pine 12 ins. diam. bears S39°E 150 lks. dist. marked T3NR39E S27 BT

In 1973 Barry Barbour finds two of the original bearing trees. Union County Monumentation Record 167-83R states: Found no trace of stone. Corner falls on old road. At a point a 36" pine with partially opened blazes bears N30°W, 83.1 ft. (slope) and a 24" pine bears S39°E, 99.1 ft. (slope) with definite blazes and partially opened. BLM BT tags on both BTs. At the above described point set 2 1/2" x 30" galvanized pipe with brass cap marked: Set pipe 25" in the ground and mound of stone around to cap. From which:

- An 11" fir bears N58°E, 52.6 ft., scribed T3NR39E S22 BT
- A 9" pine bears S62°W, 33.4 ft., scribed T3NR39E S28 BT
- Old BTs are 36" pine bears N30°W, 80.8 ft. and 24" pine bears S39°E, 93.5 ft.
- Placed signs on a steel fence post 5' North of corner

**DESCRIPTION OF CORNER EVIDENCE FOUND:**

- Found 2 1/2" galvanized iron pipe, 8" above ground, with 2 1/2" brass cap marked as shown below, from which:
- A 15" diam. Douglas Fir stob bears North 58° East, a dist. of 52.60 ft., dead and standing 6 ft. tall with healed blaze.
- A 32" diam. Ponderosa Pine stob bears South 39° East, a dist. of 95.35 (rec. 93.50) ft., dead and standing 6 ft. tall with scribe marks visible on partially healed blaze.
- An 11" diam. Ponderosa Pine bears South 62° West, a dist. of 33.40 ft., alive and vigorous with scribe marks visible on partially healed blaze.
- A 37" diam. Ponderosa Pine bears North 30° West, a dist. of 80.80 ft., alive and vigorous with scribe marks visible on partially healed blaze.

**DESCRIPTION OF MONUMENT AND ACCESSORIES I ESTABLISHED TO PERPETUATE THE ORIGINAL LOCATION OF THIS CORNER:**

From the center of the found iron pipe:

**NEW BEARING OBJECTS:**

- A 12" diam. Douglas Fir bears North 56° East, a dist. of 6.00 ft., marked T3NR39E S22 BT
- An 8" Douglas Fir bears South 31° East, a dist. of 28.75 ft., marked T3NR39E S27 BT

Fence post bears approx. 5 ft. North

Falls on East side of old road, approx. 15 feet East of ruins of a North/South bearing fence line

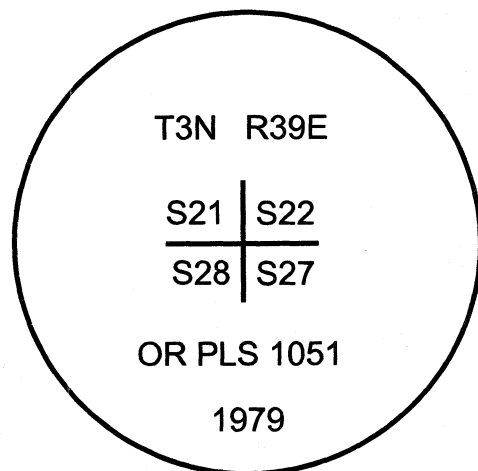

I hereby certify that the corner was perpetuated on June 20, 2023. Witnesses: Kyle Tucker and Adam Gordon

I used a compass and tape in the establishment of the new accessories. Bearings are to a brass washer marked OPLS 83571 in the BT blaze and distances are measured to a 60D spike in the right side of the center of the tree. I used 14° East for magnetic declination.

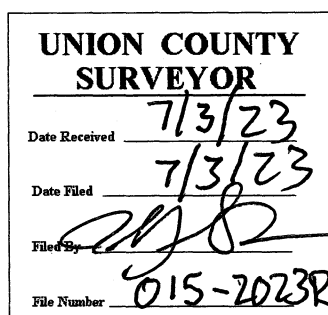

Renewal Date: June 30, 2025