

UNION COUNTY SURVEYOR
CERTIFIED RECORD OF LAND CORNER MONUMENTATION

HISTORY OF ORIGINAL CORNER ESTABLISHMENT:

Corner originally established by Frank W. Campbell under GLO contract number 498, dated May 15, 1884. GLO record states: Set post 1/4 Sec Cor, from which:

A Fir 10 in diam bears S 28° E, 8 Lks dist
A Tamarack 18 in diam bears N 10° E, 63 Lks dist

T 3 N R 39 E N-23



No record of subsequent monumentation found in UNION COUNTY survey records.

DESCRIPTION OF CORNER EVIDENCE FOUND:

Found no evidence of the corner monument or its' accessories.

SEE SURVEY NUMBER 017-2005

DESCRIPTION OF MONUMENT AND ACCESSORIES I ESTABLISHED

TO PERPETUATE THE ORIGINAL LOCATION OF THIS CORNER:

At position determined by survey, I set a 2 1/2" x 30" aluminum pipe with a 2 1/2" aluminum cap marked as shown, 29 inches in the ground, from which:

NEW BEARING TREES:

An 11" diameter Ponderosa Pine bears N 70° E, a distance of 16.20 feet, marked 1/4 S13 BT.
A 12" diameter White Fir bears S 20° E, a distance of 39.55 feet, marked 1/4 S24 BT.
A 12" diameter Douglas Fir bears S 18° W, a distance of 49.40 feet, marked 1/4 S24 BT.
A 9" diameter Ponderosa Pine bears N 25° W, a distance of 22.55 feet, marked 1/4 S13 BT.

Set steel fence post approximately 1 ft. North of the corner monument.

I hereby certify that the corner was monumented on September 2, 2005.
Witness: Greg Blackman, Jr., Mark Brooks, Rick Thew

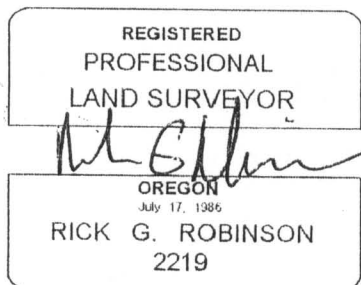

Renewal Date: December 31, 2006

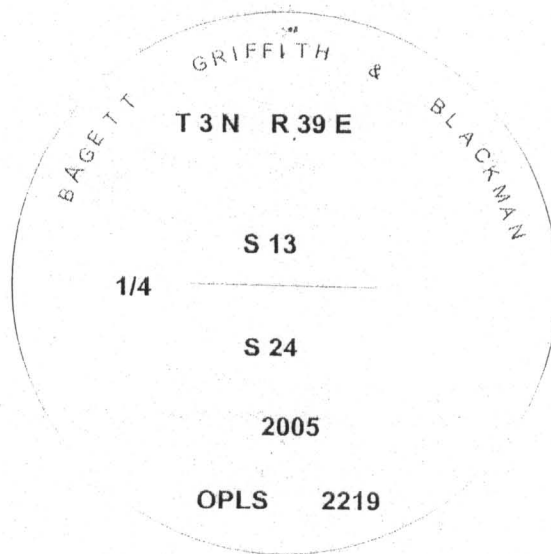

UNION COUNTY SURVEYOR

Date Received 9/15/05

Date Filed 9/15/05

Filed By [Signature]

File Number 023-2005R

I used a steel tape and magnetic compass in the establishment of the new accessories. I used 18° East declination, the distances are to a 60d spike driven into the right side of the root crown of the new bearing trees. A brass washer marked OPLS 2219 is attached to the BT blaze of the new bearing trees.

N-23

HORIZONTAL CONTROL DATA
UNION COUNTY, OREGON
OREGON STATE PLANE, NORTH ZONE (3601)

STA NAME: 200540

1/4 SECTION CORNER COMMON TO SECTIONS 13 and 24

TWP. 3 N. RGE. 39 E.

GEODETIC COORD: NAD 83(91)

DATE TIED: September 15, 2005

LAT: 45 ° 43 ' 57.97636 " N

SURVEYOR: RICK G. ROBINSON
OPLS 2219

LONG: 117 ° 52 ' 49.45545 " W

FIRM: BAGETT, GRIFFITH, & BLACKMAN
2006 Adams Avenue
La Grande, OR 97850
(541) 963-6092

SP. COOR: NAD 83(91)

N: 764103.124 INT FT.

E: 8870898.447 INT FT.

TYPE: GPS

THETA: 1 ° 51 ' 28.0103263 "

ORDER: SECOND CLASS: 1

SCALE FACTOR: 0.999943037

ELEV: 2943.02 US FT.

ELEV: DATUM: NGVD 29

COMMENTS:

2 1/2" aluminum monument marked:

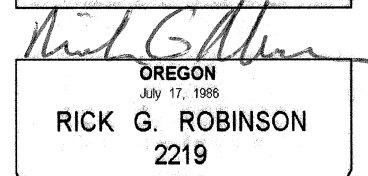
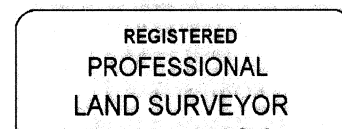
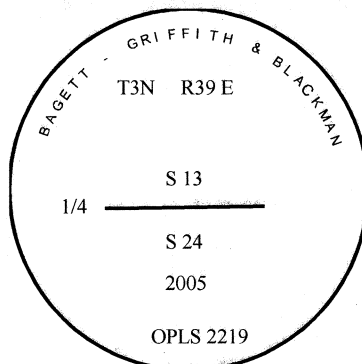

Renewal Date: December 31, 2006

1 METER = 3.2808333333... US FEET = 39.37 INCHES

1 METER = 3.280839895 INT'L FEET OR 1 INCH = 2.54 CM

TO CALCULATE ELEVATION FACTOR (IN THE NORTH AMERICAN CONTINENT)

DIVIDE 20,906,000 BY (20,906,000 + ELLIPSOID ELEV. IN FEET)