

UNION COUNTY SURVEYOR
CERTIFIED RECORD OF LAND CORNER MONUMENTATION

HISTORY OF ORIGINAL CORNER ESTABLISHMENT:

Corner not previously originally established.

No record of subsequent monumentation found in UNION COUNTY survey records.

DESCRIPTION OF CORNER EVIDENCE FOUND:

NONE.

T 3 N R 39 E N-22



SEE SURVEY NUMBER 017-2005

DESCRIPTION OF MONUMENT AND ACCESSORIES I ESTABLISHED TO PERPETUATE THE ORIGINAL LOCATION OF THIS CORNER:

At position determined by survey, I set a 5/8"x30" iron pin with a 2 1/2" aluminum cap marked as shown, 28 inches in the ground, from which:

NEW BEARING TREES:

A 10 inch diameter Douglas Fir bears N 58° E, a distance of 61.10 feet, marked W1/16 S13 BT.

An 8 inch diameter Douglas Fir bears S 40° E, a distance of 15.25 feet, marked W1/16 S24 BT.

Corner falls in North-South fence line.

Set a steel fence post approximately 1 ft. North of corner monument.

I hereby certify that the corner was monumented on September 2, 2005.
Witness: Greg Blackman, Jr., Mark Brooks, Rick Thew

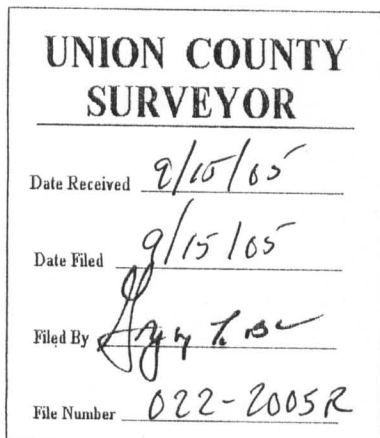
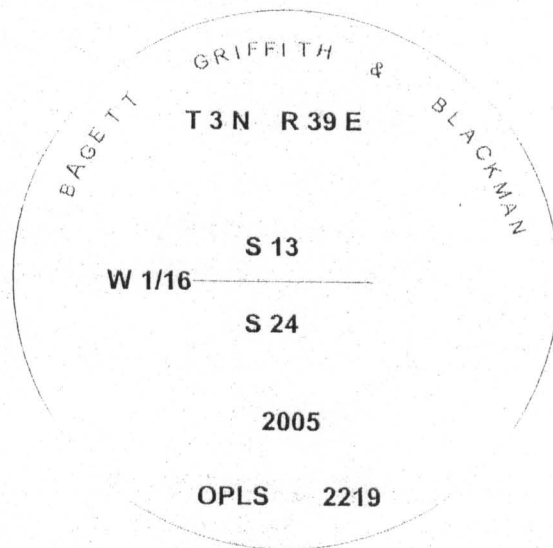
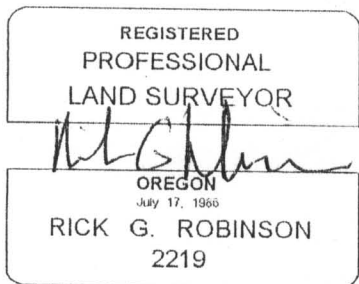

I used a steel tape and magnetic compass in the establishment of the new accessories. I used 18° East declination, the distances are to a 60d spike driven into the right side of the root crown of the new bearing trees. A brass washer marked OPLS 2219 is attached to the BT blaze of the new bearing trees.