

CERTIFIED RECORD OF LAND CORNER MONUMENT

HISTORY OF ORIGINAL CORNER ESTABLISHMENT:

Corner originally established by T. Davenport under GLO Contract Number 102, with an accepted date of January 12th, 1864. Surveyor General record states:

Set post for section corner in mound of earth, with charred stake, pits, trench as per instructions.

No information found for the establishment of the existing monument found by Merrick & Company.

DESCRIPTION OF CORNER EVIDENCE FOUND:

FOUND 1/2" DIA. REBAR, NO CAP FLUSH WITH GROUND SURFACE IN CENTERLINE OF FIELD ROAD RUNNING EAST & WEST & ON LINE WITH ROAD CENTERLINE TO THE NORTH.

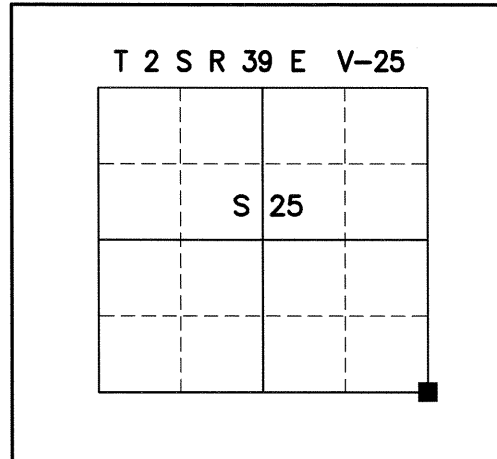

DESCRIPTION OF MONUMENT AND ACCESSORIES THAT I ESTABLISHED TO PERPETUATE THE ORIGINAL LOCATION OF THIS CORNER:

REHABILITATED FOUND 1/2" DIA. REBAR WITH SET 30" LONG #6 REBAR WITH 3-1/4" DIAMETER ALUMINUM CAP 0.5' BELOW FIELD ROAD SURFACE.

ACCESSORIES (BEARING OBJECTS):

- Set 60d Nail 3' above ground in east face of an existing power pole, that bears N14°E from set monument, 90.0 feet.
- Set 60d Nail 3' above ground in southwest face of an existing power pole, that bears S61°E from set monument, 48.1 feet.
- Set 60d Nail 3' above ground in west face of an existing power pole, that bears S42°W from set monument, 27.7 feet.
- Set chiseled "x" in top of existing 12" dia. metal drain culvert (north end), that bears N62°W from set monument, 32.4 feet.

I hereby certify that the corner was set on July 18th, 2019.
Witnessed by: Kevin Kenna & Seth Gould

REGISTERED
PROFESSIONAL
LAND SURVEYOR

OREGON
NOVEMBER 7, 2011
VERNEN KALANI LEE
85504

EXPIRES: 12/31/2020

UNION COUNTY
SURVEYOR

DATE RECEIVED: 9/20/19
DATE FILED: 9/24/19
FILED BY:
FILE NUMBER: 058-2019R

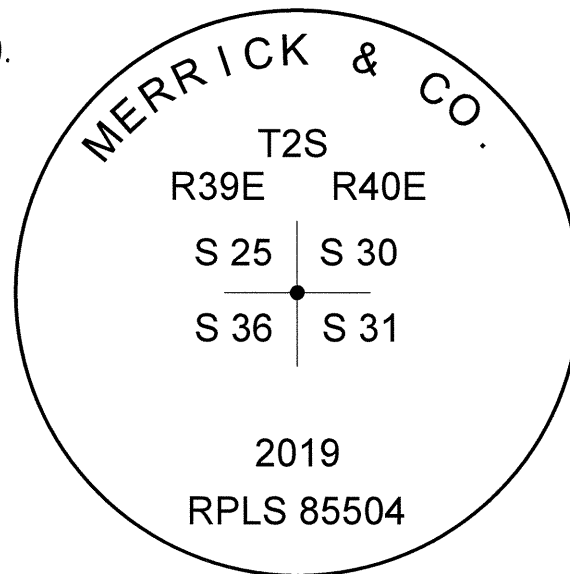

FIELD CREW USED A COMPASS OR GPS WITH STEEL TAPE FOR ESTABLISHMENT OF THE NEW ACCESSORIES. ALL DISTANCES STATED ARE HORIZONTAL DISTANCES FROM CENTER OF SET ALUMINUM CAP TO THE STATED ACCESSORY.

HORIZONTAL CONTROL DATA

UNION COUNTY, OREGON

OREGON STATE PLANE, NORTH ZONE (3601)

STA NAME: 2020001

SECTION CORNER COMMON TO SECTIONS 25, 30, 31, AND 36

TWP. 2 S RGE. 39 AND 40 E.

GEODETIC COORD: NAD 83(91)

DATE TIED: December 31, 2019

LAT: 45 ° 21 ' 17.72774 " N

SURVEYOR: RICK G. ROBINSON
OPLS 2219

LONG: 117 ° 52 ' 13.97908 " W

FIRM: BAGETT, GRIFFITH, & BLACKMAN
2006 ADAMS AVENUE
LAGRANDE, OR 97850
(541) 963-6092

SP. COOR: NAD 83(91)

N: 626490.902 INT FT.

E: 8877896.506 INT FT.

TYPE: GPS

THETA: 1 ° 51 ' 53.1696691 "

ORDER: SECOND CLASS: 1

SCALE FACTOR: 0.9998998508

ELEV: 2684.87 US FT.

ELEV: DATUM: NGVD 29

COMMENTS:

5/8" iron pin with 3 1/4" aluminum cap
0.5' below ground, marked as shown

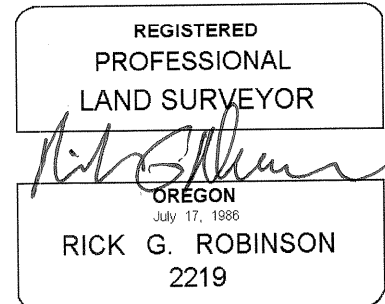
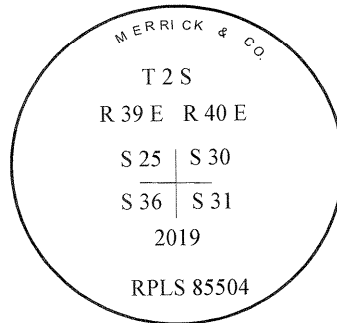

Renewal Date: December 31, 2020

1 METER = 3.2808333333... US FEET = 39.37 INCHES

1 METER = 3.280839895 INT'L FEET OR 1 INCH = 2.54 CM

TO CALCULATE ELEVATION FACTOR (IN THE NORTH AMERICAN CONTINENT)

DIVIDE 20,906,000 BY (20,906,000 + ELLIPSOID ELEV. IN FEET)