

**UNION COUNTY SURVEYOR  
CERTIFIED RECORD OF LAND CORNER MONUMENTATION**

**HISTORY OF ORIGINAL CORNER ESTABLISHMENT:**

Corner established by David P. Thompson under contract no. 103, dated September 3, 1863. Surveyor General record states:  
Set post for corner to Secs 20, 21, 28 and 29 in mound of Earth with charred stake, pits, trench as per instructions.

J.W. Kimbrell, in Old Book Survey page 144, dated March 20, 1889, finds no remaining evidence of corner. He sets a stone 9"x10"x24" for corner.

Road Survey Number 406, done by Kimbrell and Curtis, recovers monument.

Roscoe Neal, in an unrecorded survey for the Union County Highway Department dated 12-7-1928, of Lower Cove Road, finds a stone 12"x12"x24" marked "X".

In Survey Number 13-86, Gary Langlitz finds no remaining evidence of the corner monument. He uses evidence from said Road Survey to position the monument, but does not set a new monument.

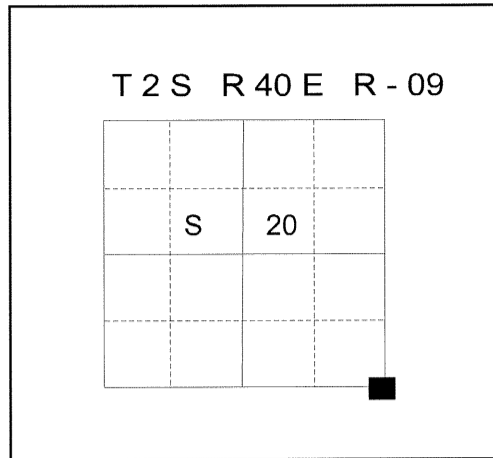

**DESCRIPTION OF CORNER EVIDENCE FOUND:**

None. I find the alignment of Lower Cove Road to be harmonious with the alignment shown in Roscoe Neal's 1928 survey and use this survey to place the corner position. Position falls very near the centerline of Kerns Loop and fencelines running East/West.

See Survey Number 008-2014

**DESCRIPTION OF MONUMENT AND ACCESSORIES I ESTABLISHED**

**TO PERPETUATE THE ORIGINAL LOCATION OF THIS CORNER:**

At the position determined by survey, I set a 5/8"x30" copperclad iron pin with 2 1/2" brass cap, marked as shown below, 37" in the ground, from which:

**NEW BEARING OBJECTS:**

- A 5/8" x 30" iron pin bears North 64°46' East, a distance of 32.49 feet, with a 1 1/2" aluminum cap marked UNION COUNTY SURVEYOR NE RP. Pin falls in a North/South fenceline.
- A 5/8" x 30" iron pin bears South 54°25' East, a distance of 36.33 feet, with a 1 1/2" aluminum cap marked UNION COUNTY SURVEYOR SE RP. Pin falls in a North/South fenceline.
- A 5/8" x 30" iron pin bears South 48°40' West, a distance of 48.04 feet, with a 1 1/2" aluminum cap marked UNION COUNTY SURVEYOR SW RP. Pin falls in a North/South fenceline.
- A 5/8" x 30" iron pin bears North 39°50' West, a distance of 54.32 feet, with a 1 1/2" aluminum cap marked UNION COUNTY SURVEYOR NW RP. Pin falls in a North/South fenceline.

Corner falls in centerline of Kerns Loop.

I hereby certify that the corner was monumented on March 13, 2014.

Witness: Rick G. Robinson

**REGISTERED  
PROFESSIONAL  
LAND SURVEYOR**

*Jeffrey S. HSU*  
**OREGON**  
June 2, 2010  
**JEFFREY S. HSU**  
**83571**

Renewal Date: June 30, 2015

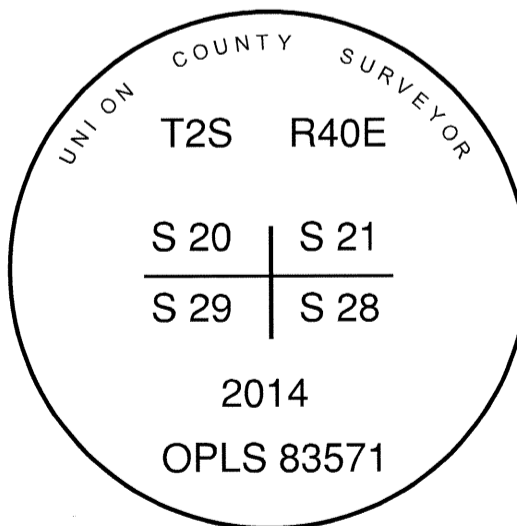

**UNION COUNTY  
SURVEYOR**

Date Received 3/14/14

Date Filed 3/14/14

Filed By Rick G. Robinson

File Number 005-2014R

I used a Leica GS15 RTK GPS in the establishment of new accessories. The Basis of Bearings is the same as that of Survey No. 008-2014. The bearings and distances are to the center of the aluminum caps.

R-09

# HORIZONTAL CONTROL DATA

## UNION COUNTY, OREGON

### OREGON STATE PLANE, NORTH ZONE (3601)

STA NAME: 201406

SECTION CORNER COMMON TO SECTIONS 20, 21, 28 AND 29

TWP. 2 S. RGE. 40 E.

GEODETIC COORD: NAD 83(91)

DATE TIED: March 12, 2014

LAT: 45 ° 22 ' 10.43820 " N

SURVEYOR: RICK G. ROBINSON  
OPLS 2219

LONG: 117 ° 49 ' 45.06041 " W

FIRM: BAGETT, GRIFFITH, & BLACKMAN  
2006 ADAMS AVENUE  
LAGRANDE, OR 97850  
(541) 963-6092

SP. COOR: NAD 83(91)

N: 632175.013 INT FT.

E: 8888347.800 INT FT.

TYPE: GPS

THETA: 1 ° 53 ' 38.7807112 "

ORDER: SECOND CLASS: 1

SCALE FACTOR: 0.9999007124

ELEV: 2803.26 US FT.

ELEV: DATUM: NGVD 29

**COMMENTS:**

Corner falls in centerline of Kerns Loop  
at approximate line of extended fences  
Monument is 7" below road surface.

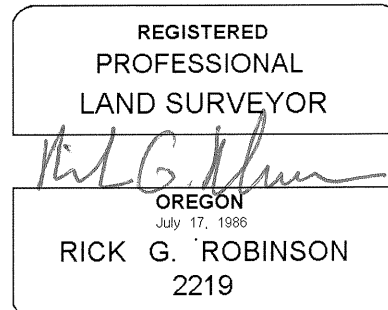
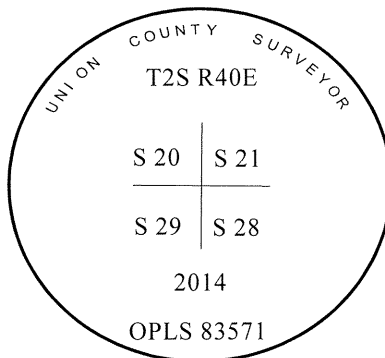

Renewal Date: December 31, 2014

1 METER = 3.2808333333... US FEET = 39.37 INCHES

1 METER = 3.280839895 INT'L FEET OR 1 INCH = 2.54 CM

TO CALCULATE ELEVATION FACTOR ( IN THE NORTH AMERICAN CONTINENT)

DIVIDE 20,906,000 BY (20,906,000 + ELLIPSOID ELEV. IN FEET)