

**UNION COUNTY SURVEYOR  
CERTIFIED RECORD OF LAND CORNER MONUMENTATION**

**HISTORY OF ORIGINAL CORNER ESTABLISHMENT:**

Corner established by David P. Thompson under contract no. 103, dated September 3, 1863. Surveyor General record states:  
Set post for corner to secs. 19, 20, 29 and 30 in mound of Earth with charred stake, pits, trench as per instructions.

J.W. Kimbrell, in Old Book Survey page 144, dated March 20, 1889, finds no remaining evidence of corner. Field notes state:  
Set Stone 10x11x25 for corner to Sec 19, 20, 29 and 30.

In Survey Number 114-73, Jamez Voelz mentions that the corner was found.

In Survey Number 13-86, Gary Langlitz finds an unrecorded 8"x11"x16" basalt stone, buried 12", lying flat with chiseled "+" on flat side, located 1.4' South of an existing fence corner.

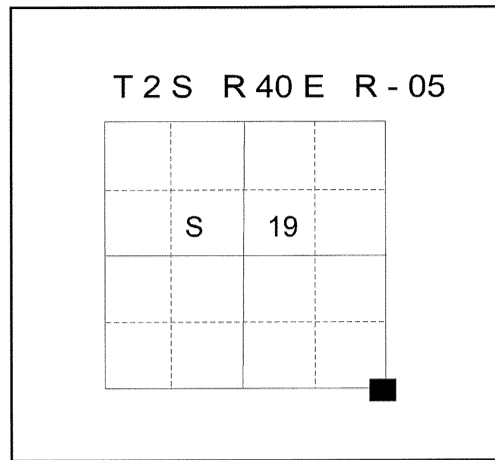

**DESCRIPTION OF CORNER EVIDENCE FOUND:**

At apparent intersection of fences, which run West and North, I find a stone 10"x15"x24", buried 8" below ground surface. There are no visible marks on the stone and the fence corner mentioned in Survey Number 13-86 is no longer existing. Further excavation below the stone monument reveals remnants of charred wood. Corner falls in a tilled agricultural area devoid of natural stone features. Due to harmony with the record measurements to adjacent monuments as well as lines of occupation, I accept this stone as the best available evidence of the original corner.

See Survey Number 008-2014

**DESCRIPTION OF MONUMENT AND ACCESSORIES I ESTABLISHED**

**TO PERPETUATE THE ORIGINAL LOCATION OF THIS CORNER:**

At the stone position, I set a 2 1/2"x30" aluminum pipe with 2 1/2" aluminum cap, marked as shown below, 38" in the ground, from which:

**NEW BEARING OBJECTS:**

- A 5/8" x 30" iron pin bears North 0°30' West, a distance of 63.11 feet, with a 1 1/2" aluminum cap marked UNION COUNTY SURVEYOR N RP. Pin falls at South end of fenceline terminus.
- A 5/8" x 30" iron pin bears North 85°54' East, a distance of 21.25 feet, with a 1 1/2" aluminum cap marked UNION COUNTY SURVEYOR E RP. Pin falls along edge of crop line and is buried 6".
- A 5/8" x 30" iron pin bears South 2°39' West, a distance of 28.71 feet, with a 1 1/2" aluminum cap marked UNION COUNTY SURVEYOR S RP. Pin falls on North side of a buried farm implement.
- A 5/8" x 30" iron pin bears North 88°04' West, a distance of 14.95 feet with a 1 1/2" aluminum cap marked UNION COUNTY SURVEYOR W RP. Pin falls on East side of fence line terminus.

Corner falls in tilled agricultural area. I reburied the stone along the South side of the monument.

I hereby certify that the corner was monumented on March 12, 2014.

**REGISTERED  
PROFESSIONAL  
LAND SURVEYOR**

*Jeffrey S. Hsu*  
**OREGON**  
June 2, 2010  
**JEFFREY S. HSU**  
83571

Renewal Date: June 30, 2015

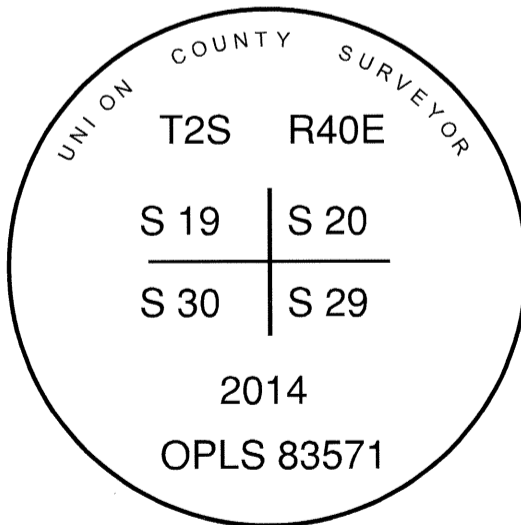

**UNION COUNTY  
SURVEYOR**

Date Received 3/14/14

Date Filed 3/14/14

Filed By *R. L. Hsu*

File Number 003-2014R

I used a Leica GS15 RTK GPS in the establishment of new accessories. The Basis of Bearings is the same as that of Survey No. 008-2014 The bearings and distances are to the center of the aluminum caps.

# HORIZONTAL CONTROL DATA

## UNION COUNTY, OREGON

### OREGON STATE PLANE, NORTH ZONE (3601)

STA NAME: 201404

SECTION CORNER COMMON TO SECTIONS 19, 20, 29 AND 30

TWP. 2 S. RGE. 40 E.

GEODETIC COORD: NAD 83(91)

DATE TIED: March 12, 2014

LAT: 45 ° 22 ' 10.50469 " N

SURVEYOR: RICK G. ROBINSON  
OPLS 2219

LONG: 117 ° 50 ' 59.47021 " W

FIRM: BAGETT, GRIFFITH, & BLACKMAN  
2006 ADAMS AVENUE  
LAGRANDE, OR 97850  
(541) 963-6092

SP. COOR: NAD 83(91)

N: 632006.853 INT FT.

E: 8883038.633 INT FT.

TYPE: GPS

THETA: 1 ° 52 ' 46.0103196 "

ORDER: SECOND CLASS: 1

SCALE FACTOR: 0.9999007135

ELEV: 2687.97 US FT.

ELEV: DATUM: NGVD 29

**COMMENTS:**

Corner falls in tilled agricultural area  
at apparent corner of extended fences  
Monument is 8" below ground.

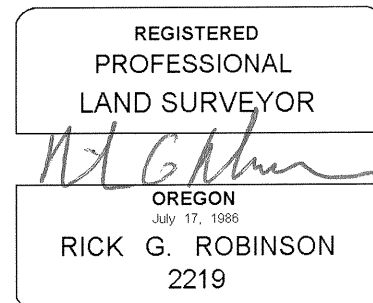
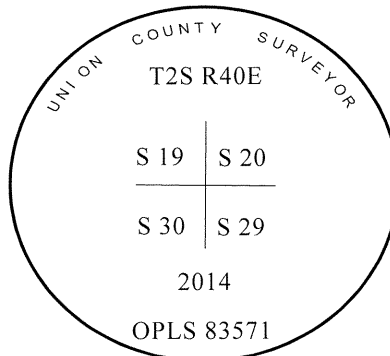

Renewal Date: December 31, 2014

1 METER = 3.2808333333... US FEET = 39.37 INCHES

1 METER = 3.280839895 INT'L FEET OR 1 INCH = 2.54 CM

TO CALCULATE ELEVATION FACTOR ( IN THE NORTH AMERICAN CONTINENT)

DIVIDE 20,906,000 BY (20,906,000 + ELLIPSOID ELEV. IN FEET)