

**UNION COUNTY SURVEYOR
CERTIFIED RECORD OF LAND CORNER MONUMENTATION**

HISTORY OF ORIGINAL CORNER ESTABLISHMENT:

Corner established by David P. Thompson under contract no. 103, dated September 3, 1863. Surveyor General record states:

Set post for 1/4 Sec. Corner in mound of Earth with charred stake, pits, trench as per instructions.

J.W. Kimbrell, in Old Book Survey page 144, dated March 20, 1889, finds no remaining evidence of corner. Field notes state:

Set Stone 9x10x18 for 1/4 Sec. Cor bet. Sec 19 & 20.

In Survey Number 114-73, Jamez Voelz finds as unrecorded 1 1/2" pipe in a fence corner, origins unknown.

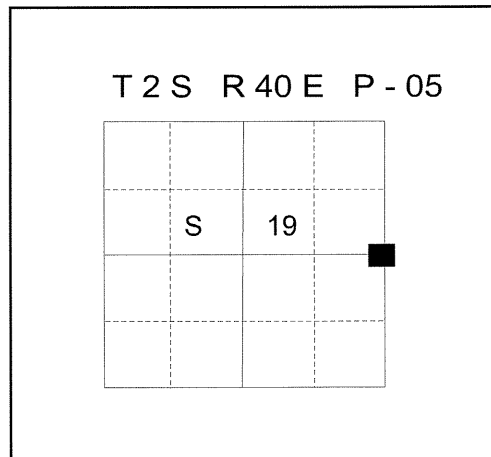

DESCRIPTION OF CORNER EVIDENCE FOUND:

Found a 1 1/2" iron pipe, 6" above ground, as described in Survey Number 114-73. Further excavation reveals a stone, 3"x8"x15" buried along the North side of the pipe with a visible "1/4" chiseled on a flat face. Stone appears to be broken and is most likely a remnant of the stone set by Kimbrell.

DESCRIPTION OF MONUMENT AND ACCESSORIES I ESTABLISHED

TO PERPETUATE THE ORIGINAL LOCATION OF THIS CORNER:

At the pipe position, I drive the pipe flush with the ground and place a 2 1/2"x30" aluminum pipe with 2 1/2" aluminum cap, marked as shown below, 28" in the ground, over top of the existing pipe, from which:

NEW BEARING OBJECTS:

- A 5/8" x 30" iron pin bears South 79°03' East, a distance of 12.38 feet, with a 1 1/2" aluminum cap marked UNION COUNTY SURVEYOR E RP.
- A 5/8" x 30" iron pin bears South 1°21' West, a distance of 15.90 feet, with a 1 1/2" aluminum cap marked UNION COUNTY SURVEYOR S RP. Pin falls on North side of fence line terminus.
- A 5/8" x 30" iron pin bears South 89°05' West, a distance of 13.80 feet, with a 1 1/2" aluminum cap marked UNION COUNTY SURVEYOR W RP. Pin falls on South side of E/W running fence.
- A 3" iron pipe fence corner in concrete bears North 79° West, a distance of 1.05 feet.

Corner falls on South side of irrigation ditch and 1 foot East of a fence corner, from which a fence runs Westerly. No practical place to set reference monument to North. I reburied the stone along the East side of the new monument.

I hereby certify that the corner was monumented on March 12, 2014.

**REGISTERED
PROFESSIONAL
LAND SURVEYOR**

Jeffrey S. Hsu
OREGON
June 2, 2010
JEFFREY S. HSU
83571

Renewal Date: June 30, 2015

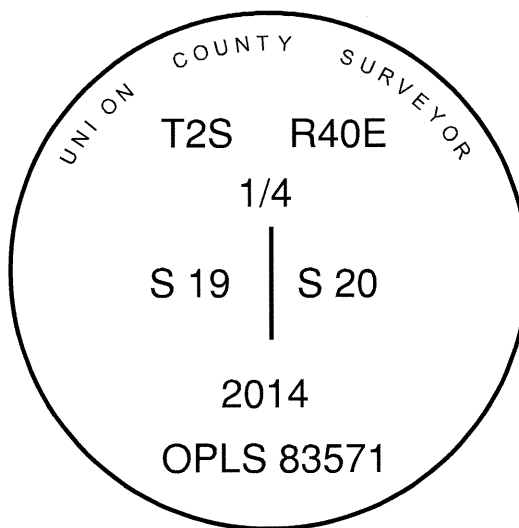

**UNION COUNTY
SURVEYOR**

Date Received 3/14/14

Date Filed 3/14/14

Filed By *Nil Klein*

File Number 002-2014R

I used a Leica GS15 RTK GPS in the establishment of new accessories. The Basis of Bearings is the same as that of Survey No. 008-2014 The bearings and distances are to the center of the aluminum caps.

HORIZONTAL CONTROL DATA
UNION COUNTY, OREGON
OREGON STATE PLANE, NORTH ZONE (3601)

STA NAME: 201403

1/4 SECTION CORNER COMMON TO SECTIONS 19 AND 20

TWP. 2 S. RGE. 40 E.

GEODETIC COORD: NAD 83(91)

DATE TIED: March 12, 2014

LAT: 45 ° 22 ' 36.66393 " N

SURVEYOR: RICK G. ROBINSON
OPLS 2219

LONG: 117 ° 50 ' 59.59274 " W

FIRM: BAGETT, GRIFFITH, & BLACKMAN
2006 ADAMS AVENUE
LAGRANDE, OR 97850
(541) 963-6092

SP. COOR: NAD 83(91)

N: 634654.443 INT FT.

E: 8882943.004 INT FT.

TYPE: GPS

THETA: 1 ° 52 ' 45.9234236 "

ORDER: SECOND CLASS: 1

SCALE FACTOR: 0.9999011654

ELEV: 2687.07 US FT.

ELEV: DATUM: NGVD 29

COMMENTS:

Corner falls on South side of drainage ditch
1 ft. East of fence corner
Monument is 2" above ground.

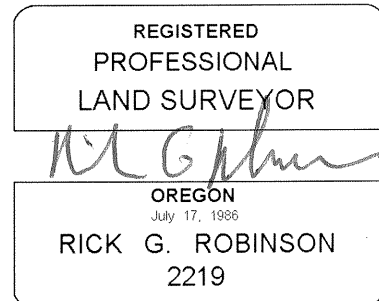
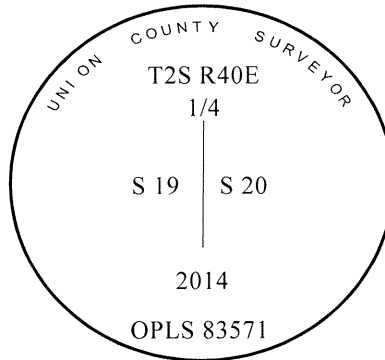

Renewal Date: December 31, 2014

1 METER = 3.2808333333... US FEET = 39.37 INCHES

1 METER = 3.280839895 INT'L FEET OR 1 INCH = 2.54 CM

TO CALCULATE ELEVATION FACTOR (IN THE NORTH AMERICAN CONTINENT)

DIVIDE 20,906,000 BY (20,906,000 + ELLIPSOID ELEV. IN FEET)