

Index File No. G 9 CORNER RECORD (SEARCH) (Ref. FSM 7151.4) Tract or Survey No. 1/4 cor sec 9  
 T 25 R. 40E R.D. Union County Baker  
 Merid. W-M N.F. W-W State OR

CORNER DIAGRAM

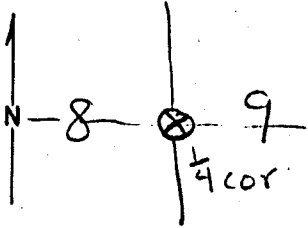

DESCRIBE CORNER MONUMENT FOUND

DESCRIBE BEARING TREES OR OTHER OFFICIAL ACCESSORIES FOUND

PP stump 4' high in sec. 8 w/scrib SW upper scar, lower scar grown over

PHOTO IDENTIFICATION DATA

Photo No. EWD 19-20  
 Filed At. \_\_\_\_\_  
 Object Ident. pin prick  
 Ident. By \_\_\_\_\_  
 Signature \_\_\_\_\_

DESCRIBE CORNER LOCATION RELATIVE TO NEAR-BY FEATURES, ALSO HOW TO REACH CORNER

Go North from gate on road shown on photo approx 725'  
 Sec. board on 8"  
 larch at this gate

PLANE COORDINATE POSITION DATA

State \_\_\_\_\_ Zone \_\_\_\_\_  
 X \_\_\_\_\_  
 Y \_\_\_\_\_  
 Estab. By \_\_\_\_\_  
 Agency \_\_\_\_\_

Signature [Signature] Title \_\_\_\_\_ Division \_\_\_\_\_ Headquarters \_\_\_\_\_ Date 9-8-77 7100-52-13/68

**UNION COUNTY SURVEYOR**

---

Date Received \_\_\_\_\_

Date Filed 12-18-87

By G. LANSLITZ, DEPUTY

File No. 214-87R

G-9

**CERTIFIED RECORD OF LAND CORNER MONUMENTATION**

**HISTORY OF ORIGINAL CORNER ESTABLISHMENT:**

Corner established by Henry Meldrum under GLO Contract number 450, dated June 11, 1882. Surveyor General record states: Set post for 1/4 sec cor from which:

A Pine 15 in dia bears N84W 50 lks

A Larch 6 in dia bears N61E 68 lks

Union County monumentation record number 214-87R calls finding a "PP stump 4' high in sec. 8 w/scrib S in upper scar, lower scar grown over." Record is dated 9-8-77.

No record of subsequent monumentation found in UNION COUNTY survey records.

**DESCRIPTION OF CORNER EVIDENCE FOUND:**

Found a rotted 4 ft. high 12-14" diameter Ponderosa Pine stump, badly decayed, down with faint scribe visible on lower scar.

**DESCRIPTION OF MONUMENT AND ACCESSORIES I ESTABLISHED**

**TO PERPETUATE THE ORIGINAL LOCATION OF THIS CORNER:**

At record position from the found bearing tree, I set a 2 1/2" x 30" monument with aluminum cap marked as shown below, 28" in the ground, from which:

**NEW BEARING TREES:**

A 6" diameter White Fir bears S70°W, a distance of 46.97 feet, marked "X BT"

A 6" diameter Ponderosa Pine bears S18°W, a distance of 38.87 feet, marked "X BT"

A 9" diameter Western Larch bears N38°W, a distance of 61.90 feet, marked "1/4 S8 BT"

A 5/8"x30" iron pin with aluminum cap marked "UNION COUNTY SURVEYOR S8 RP" bears N 5°33'W, a distance of 24.56 feet,

Raised small mound of stone around monument.

I hereby certify that the corner was monumented on July 8, 2004.

Witness: Mike Spicer

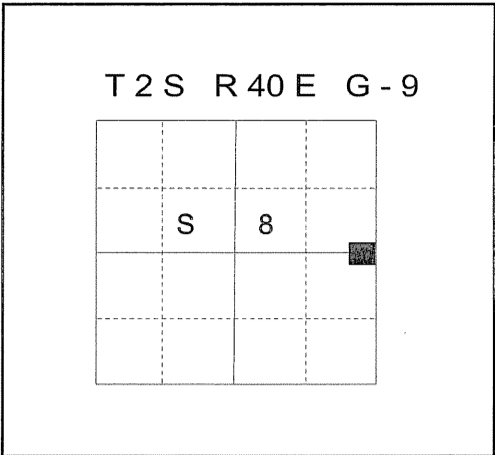

REGISTERED  
PROFESSIONAL  
LAND SURVEYOR

*Rick G. Robinson*

OREGON  
July 17, 1986  
RICK G. ROBINSON  
2219

Renewal Date December 31, 2004

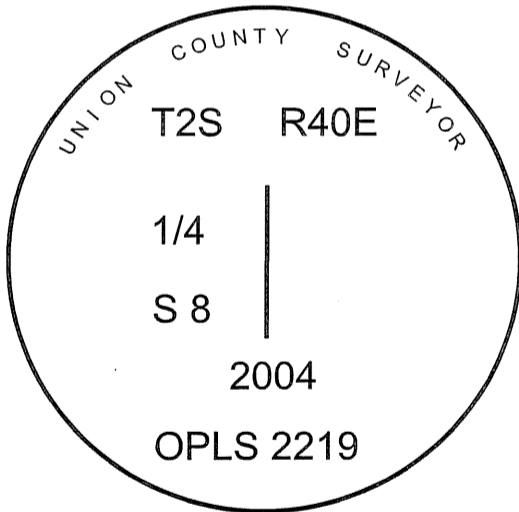

**UNION COUNTY  
SURVEYOR**

Date Received 7-15-04

Date Filed 7-17-04

Filed By *H. G. Tolson*

File Number 036-2004R

I used a steel tape and magnetic compass in the establishment of new bearing trees. The magnetic declination used was 18° East. The distance to the bearing tree is to a 50d spike driven on the right side of the tree at the root crown. I attached a brass washer marked OPLS 2219 to the BT blaze. The bearing and distance to the iron pin was determined by a GPS observation using a Leica 500 base and receiver. The basis of bearing is that of survey number 041-2003.

# HORIZONTAL CONTROL DATA

## UNION COUNTY, OREGON

### OREGON STATE PLANE, NORTH ZONE (3601)

STA NAME: 200410

EAST 1/4 CORNER OF SECTION 8 ONLY

TWP. 2 S. RGE. 40 E.

GEODETIC COORD: NAD 83(91)

DATE TIED: JULY, 2004

LAT: 45 ° 24 ' 21.53455 " N

SURVEYOR: RICK G. ROBINSON  
OPLS 2219

LONG: 117 ° 49 ' 46.30753 " W

FIRM: BAGETT, GRIFFITH, & BLACKMAN  
2006 ADAMS AVENUE  
LAGRANDE, OR 97850  
(541) 963-6092

SP. COOR: NAD 83(91)

N: 645441.770 INT FT.

E: 8887820.044 INT FT.

TYPE: GPS

THETA: 1 ° 53 ' 37.8962714 "

ORDER: SECOND CLASS: 1

SCALE FACTOR: 0.9999031387

ELEV: 4453.09 US FT.

ELEV: DATUM: NGVD 29

#### COMMENTS:

Corner is 2 1/2" aluminum monument  
Approximately 300 feet East of Road  
Near North-South Fence line

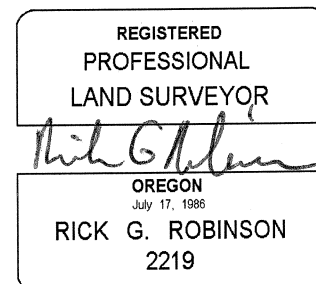
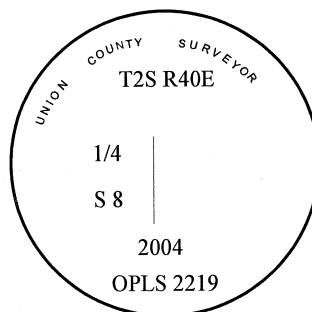

Renewal Date December 31, 2004

1 METER = 3.2808333333... US FEET = 39.37 INCHES

1 METER = 3.280839895 INT'L FEET OR 1 INCH = 2.54 CM

TO CALCULATE ELEVATION FACTOR ( IN THE NORTH AMERICAN CONTINENT)

DIVIDE 20,906,000 BY (20,906,000 + ELLIPSOID ELEV. IN FEET)