

# CERTIFIED RECORD OF LAND CORNER MONUMENT

## HISTORY OF ORIGINAL CORNER ESTABLISHMENT:

Corner originally established by D. Thompson under GLO Contract Number 103, with an accepted date of January 20th, 1864. Surveyor General record states:

Set post for section corner in mound of earth, with charred stake, pits, trench as per instructions.

## DESCRIPTION OF CORNER EVIDENCE FOUND:

SEARCHED FOR BUT NO MONUMENT FOUND.  
USED EXISTING FENCE CORNER POSITION FOR BEST EVIDENCE OF CORNER LOCATION.

## DESCRIPTION OF MONUMENT AND ACCESSORIES THAT I ESTABLISHED TO PERPETUATE THE ORIGINAL LOCATION OF THIS CORNER:

SET 30" LONG #6 REBAR WITH 3-1/4" DIAMETER ALUMINUM CAP AT FENCE CORNER FLUSH WITH GROUND.

## ACCESSORIES (BEARING OBJECTS):

Set 60d Nail 3' above ground in west face of an existing wood fence post, that bears N00°E from set monument, 7.3 feet.

Set 60d Nail 3' above ground in south face of an existing wood fence post, that bears N90°E from set monument, 7.1 feet.

Set 7' long steel "U" Channel Post with white Sign attached, 0.2' west of set monument.

Set 7' long steel "U" Channel Post with white Sign attached, 1.5' north of set monument.

I hereby certify that the corner was set on July 17th, 2019.  
Witnessed by: Kevin Kenna & Seth Gould

REGISTERED  
PROFESSIONAL  
LAND SURVEYOR

OREGON  
NOVEMBER 7, 2011  
VERNEN KALANI LEE  
85504

EXPIRES: 12/31/2020

UNION COUNTY  
SURVEYOR

DATE RECEIVED: 9/20/19  
DATE FILED: 9/24/19  
FILED BY: *Rich G. Niman*  
FILE NUMBER: 060-2619R

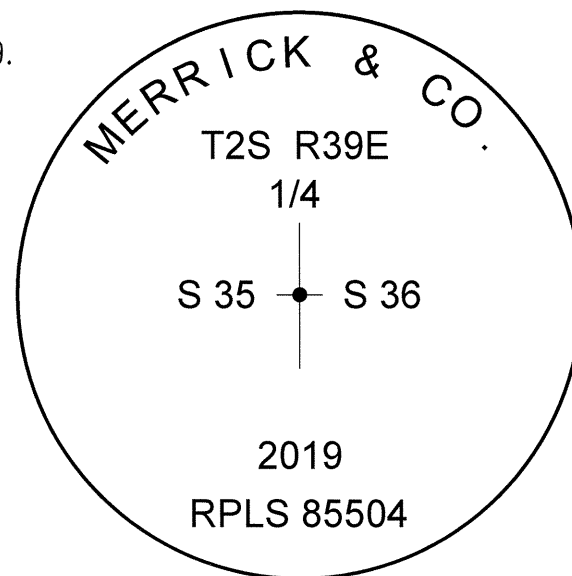
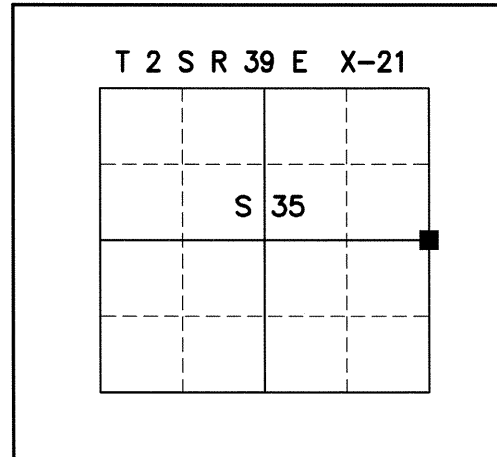

FIELD CREW USED A COMPASS OR GPS WITH STEEL TAPE FOR ESTABLISHMENT OF THE NEW ACCESSORIES. ALL DISTANCES STATED ARE HORIZONTAL DISTANCES FROM CENTER OF SET ALUMINUM CAP TO THE STATED ACCESSORY.

X-21

# HORIZONTAL CONTROL DATA

## UNION COUNTY, OREGON

### OREGON STATE PLANE, NORTH ZONE (3601)

STA NAME: 2020008

QUARTER CORNER COMMON TO SECTIONS 35 AND 36

TWP. 2 S RGE. 39 E.

GEODETIC COORD: NAD 83(91)

DATE TIED: JANUARY 8, 2019

LAT: 45 ° 20 ' 51.77444 " N

SURVEYOR: RICK G. ROBINSON  
OPLS 2219

LONG: 117 ° 53 ' 27.62768 " W

FIRM: BAGETT, GRIFFITH, & BLACKMAN  
2006 ADAMS AVENUE  
LAGRANDE, OR 97850  
(541) 963-6092

SP. COOR: NAD 83(91)

N: 623693.380 INT FT.

E: 8872725.298 INT FT.

TYPE: GPS

THETA: 1 ° 51 ' 0.93911765 "

ORDER: SECOND CLASS: 1

SCALE FACTOR: 0.9998994505

ELEV: 2688.77 US FT.

ELEV: DATUM: NGVD 29

**COMMENTS:**

5/8" iron pin with 3 1/4" aluminum cap  
flush with ground, marked as shown

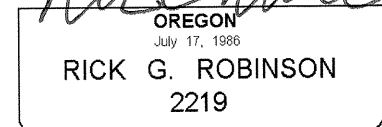
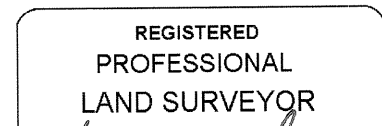
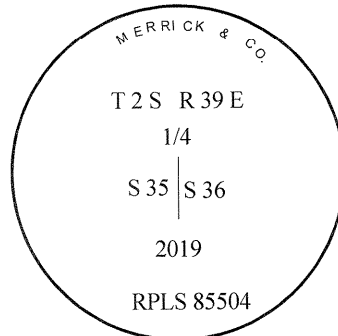

Renewal Date: December 31, 2020

1 METER = 3.280833333... US FEET = 39.37 INCHES

1 METER = 3.280839895 INT'L FEET OR 1 INCH = 2.54 CM

TO CALCULATE ELEVATION FACTOR ( IN THE NORTH AMERICAN CONTINENT)

DIVIDE 20,906,000 BY (20,906,000 + ELLIPSOID ELEV. IN FEET)