

CERTIFIED RECORD OF LAND CORNER MONUMENT

HISTORY OF ORIGINAL CORNER ESTABLISHMENT:

Corner originally established by D. Thompson under GLO Contract Number 103, with an accepted date of January 20th, 1864. Surveyor General record states:

Set post for section corner in mound of earth, with charred stake, pits, trench as per instructions.

DESCRIPTION OF CORNER EVIDENCE FOUND:

SEARCHED FOR BUT NO MONUMENT FOUND.

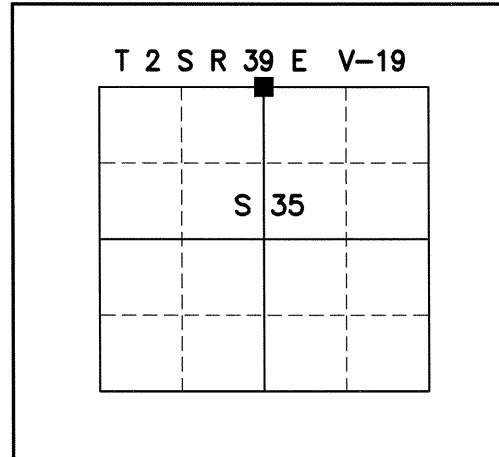

DESCRIPTION OF MONUMENT AND ACCESSORIES THAT I ESTABLISHED TO PERPETUATE THE ORIGINAL LOCATION OF THIS CORNER:

SET 30" LONG #6 REBAR WITH 3-1/4" DIAMETER ALUMINUM CAP 0.5' BELOW GROUND SURFACE ON LINE WITH FENCE LINE RUNNING SOUTHERLY.

ACCESSORIES (BEARING OBJECTS):

- Set 60d Nail 3' above ground in north face of an existing power pole, that bears S86°E from set monument, 121.0 feet.
- Set 5/8" dia. rebar with 2" alum. cap at fence corner as offset to easement, that bears S01°E from set monument, 27.4 feet.
- Set 5/8" dia. rebar with 2" alum. cap stamped "RM" flush with ground, that bears N16°W from set monument, 27.8 feet.
- Center Top of an existing Water Well, that bears S44°W from set monument, 30.2 feet.

I hereby certify that the corner was set on July 17th, 2019.
Witnessed by: Kevin Kenna & Seth Gould

REGISTERED
PROFESSIONAL
LAND SURVEYOR

OREGON
NOVEMBER 7, 2011
VERNEN KALANI LEE
85504

EXPIRES: 12/31/2020

UNION COUNTY
SURVEYOR

DATE RECEIVED: 9/20/19
DATE FILED: 9/24/19
FILED BY: *Neil Gillman*
FILE NUMBER: 056-2019R

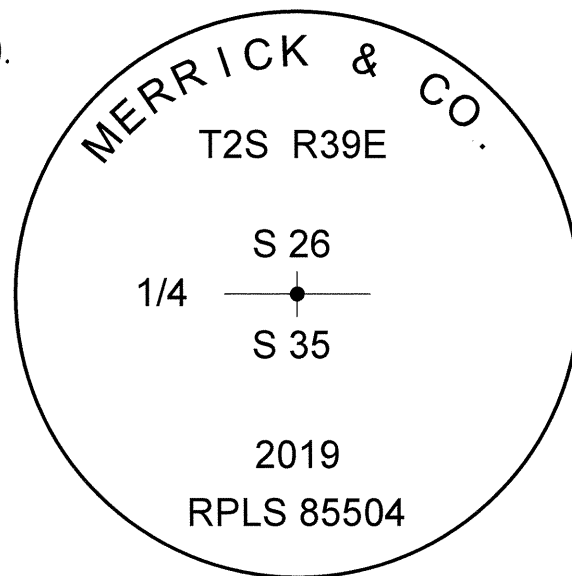

FIELD CREW USED A COMPASS OR GPS WITH STEEL TAPE FOR ESTABLISHMENT OF THE NEW ACCESSORIES. ALL DISTANCES STATED ARE HORIZONTAL DISTANCES FROM CENTER OF SET ALUMINUM CAP TO THE STATED ACCESSORY.

HORIZONTAL CONTROL DATA

UNION COUNTY, OREGON

OREGON STATE PLANE, NORTH ZONE (3601)

STA NAME: 2020006

QUARTER CORNER COMMON TO SECTIONS 26,35

TWP. 2 S RGE. 39 E.

GEODETIC COORD: NAD 83(91)

DATE TIED: JANUARY 8, 2019

LAT: 45 ° 21 ' 17.71384 " N

SURVEYOR: RICK G. ROBINSON
OPLS 2219

LONG: 117 ° 54 ' 5.69534 " W

FIRM: BAGETT, GRIFFITH, & BLACKMAN
2006 ADAMS AVENUE
LAGRANDE, OR 97850
(541) 963-6092

SP. COOR: NAD 83(91)

N: 626231.447 INT FT.

E: 8869923.688 INT FT.

TYPE: GPS

THETA: 1 ° 50 ' 33.9420622 "

ORDER: SECOND CLASS: 1

SCALE FACTOR: 0.9998998505

ELEV: 2681.91 US FT.

ELEV: DATUM: NGVD 29

COMMENTS:

5/8" iron pin with 3 1/4" aluminum cap
0.5' below ground, marked as shown

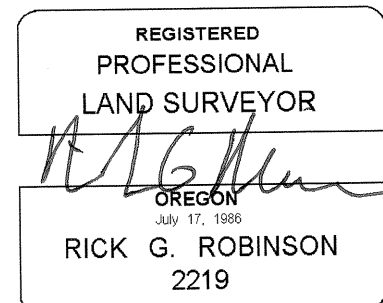
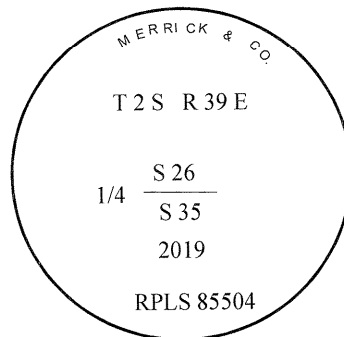

Renewal Date: December 31, 2020

1 METER = 3.2808333333... US FEET = 39.37 INCHES

1 METER = 3.280839895 INT'L FEET OR 1 INCH = 2.54 CM

TO CALCULATE ELEVATION FACTOR (IN THE NORTH AMERICAN CONTINENT)

DIVIDE 20,906,000 BY (20,906,000 + ELLIPSOID ELEV. IN FEET)