

# CERTIFIED RECORD OF LAND CORNER MONUMENT

## HISTORY OF ORIGINAL CORNER ESTABLISHMENT:

Corner originally established by D. Thompson under GLO Contract Number 103, with an accepted date of January 20th, 1864. Surveyor General record states:

Set post for section corner in mound of earth, with charred stake, pits, trench as per instructions.

## DESCRIPTION OF CORNER EVIDENCE FOUND:

SEARCHED FOR BUT NO MONUMENT FOUND.

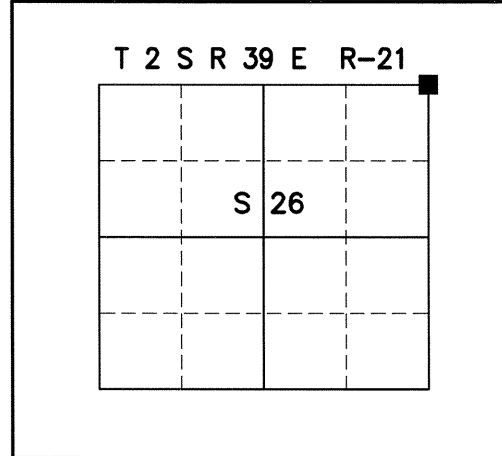

## DESCRIPTION OF MONUMENT AND ACCESSORIES THAT I ESTABLISHED TO PERPETUATE THE ORIGINAL LOCATION OF THIS CORNER:

SET 30" LONG #6 REBAR WITH 3-1/4" DIAMETER ALUMINUM CAP 0.5' BELOW GROUND ON LINE WITH FENCE LINE RUNNING EASTERLY & ON LINE WITH ROAD CENTERLINES RUNNING NORTHERLY AND WESTERLY.

## ACCESSORIES (BEARING OBJECTS):

- Set 60d Nail 3' above ground in west face of an existing pole next to fence line, that bears N41°E from set monument, 36.6 feet.
- Set 60d Nail 3' above ground in east face of an existing power pole, that bears S46°W from set monument, 41.1 feet.
- Set 5/8" dia. rebar with 2" alum. cap stamped "RM" flush with ground, that bears N09°E from set monument, 141.8 feet.
- Found brake cable rod at west edge of existing steel car frame fence corner, that bears N88°E from set monument, 30.3 feet.

I hereby certify that the corner was set on July 18th, 2019.  
Witnessed by: Kevin Kenna & Seth Gould

REGISTERED  
PROFESSIONAL  
LAND SURVEYOR

*Vern Kalani Lee*  
OREGON  
NOVEMBER 7, 2011  
VERNEN KALANI LEE  
85504

EXPIRES: 12/31/2020

UNION COUNTY  
SURVEYOR

---

DATE RECEIVED: 9/20/19  
DATE FILED: 9/24/19  
FILED BY: *Rel. G. Min*  
FILE NUMBER: 052-2019R

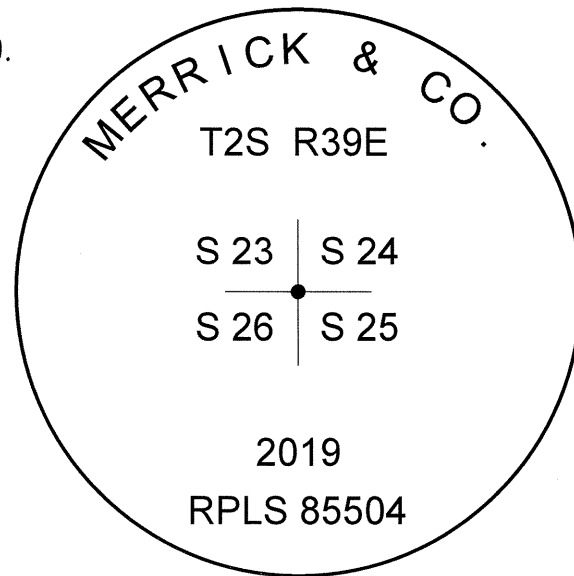

FIELD CREW USED A COMPASS OR GPS WITH STEEL TAPE FOR ESTABLISHMENT OF THE NEW ACCESSORIES. ALL DISTANCES STATED ARE HORIZONTAL DISTANCES FROM CENTER OF SET ALUMINUM CAP TO THE STATED ACCESSORY.

# HORIZONTAL CONTROL DATA

## UNION COUNTY, OREGON

### OREGON STATE PLANE, NORTH ZONE (3601)

STA NAME: 2020005

SECTION CORNER COMMON TO SECTIONS 23, 24, 25, AND 26

TWP. 2 S RGE. 39 E.

GEODETIC COORD: NAD 83(91)

DATE TIED: December 31, 2019

LAT: 45 ° 22 ' 10.83229 " N

SURVEYOR: RICK G. ROBINSON  
OPLS 2219

LONG: 117 ° 53 ' 27.90669 " W

FIRM: BAGETT, GRIFFITH, & BLACKMAN  
2006 ADAMS AVENUE  
LAGRANDE, OR 97850  
(541) 963-6092

SP. COOR: NAD 83(91)

N: 631695.193 INT FT.

E: 8872446.876 INT FT.

TYPE: GPS

THETA: 1 ° 51 ' 0.7412435 "

ORDER: SECOND CLASS: 1

SCALE FACTOR: 0.9999007191

ELEV: 2683.64 US FT.

ELEV: DATUM: NGVD 29

**COMMENTS:**

5/8" iron pin with 3 1/4" aluminum cap  
0.5' below ground, marked as shown

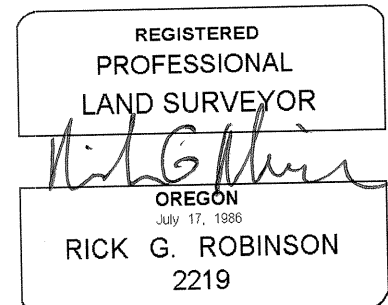
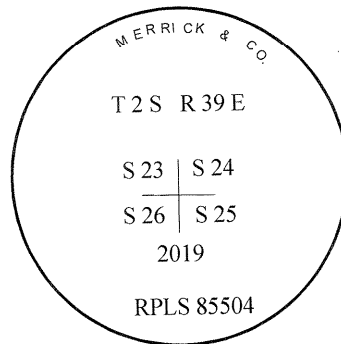

Renewal Date: December 31, 2020

1 METER = 3.2808333333... US FEET = 39.37 INCHES

1 METER = 3.280839895 INT'L FEET OR 1 INCH = 2.54 CM

TO CALCULATE ELEVATION FACTOR ( IN THE NORTH AMERICAN CONTINENT)

DIVIDE 20,906,000 BY (20,906,000 + ELLIPSOID ELEV. IN FEET)