

**CERTIFIED RECORD OF LAND CORNER MONUMENTATION**

**HISTORY OF ORIGINAL CORNER ESTABLISHED:**

Corner originally established by David P. Thompson under GLO contract number 103 dated September 3rd, 1863. Surveyor General field notes state:  
Set post for corner to secs. 8,9,16,&17 in mound of earth with charred stake, pits, trench, as per instructions

In 1888, in performance of Union County Old Book Survey No. 65, Pg. 136, and in 1889, in performance of Old Book Survey No. 90, Page 189, County Surveyor J.W. Kimbrell found the original corner. No description of monument.

Union County Survey Record for subdivision "Alicel Orchard Tracts" states the initial point of the subdivision being the Southeast corner of Section 8 being a stone 6 in. x 6 in. x 12 in.

T 2 S R 39 E J-09

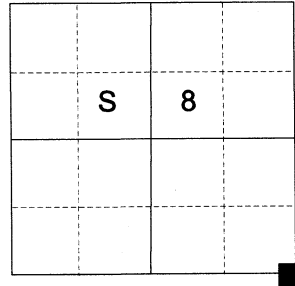

**DESCRIPTION OF CORNER EVIDENCE FOUND:**

Found a 6"x6"x12" stone in a small mound of stone with steel channel iron and sheared off fence post alongside, at the intersection of North, East, and West running crop edges.

SEE SURVEY NUMBER 009-2022

**DESCRIPTION OF MONUMENT AND ACCESSORIES I ESTABLISHED TO MONUMENT THE ORIGINAL LOCATION OF THIS CORNER:**

At position of stone, I set a 2 1/2" aluminum pipe, 28" in the ground, with 2 1/2" aluminum cap marked as shown below with a 1 1/2" collar of stone, from which:

**NEW BEARING OBJECTS:**

A 5/8" x 30" iron pin bears North 12°40' East a dist. of 14.26 ft., with 1 1/2" aluminum cap marked BGB SURVEYORS NE RP.

A 5/8" x 30" iron pin bears South 77°39' East a dist. of 10.22 ft., with 1 1/2" aluminum cap marked BGB SURVEYORS SE RP.

A 5/8" x 30" iron pin bears South 76°16' West a dist. of 12.16 ft., with 1 1/2" aluminum cap marked BGB SURVEYORS SW RP.

A 5/8" x 30" iron pin bears North 47°11' West a dist. of 11.76 ft., with 1 1/2" aluminum cap marked BGB SURVEYORS NW RP.

Old steel fenceposts bear approx. 1 ft. East and West

I hereby certify that the corner was monumented on March 30, 2022.  
Witness: Kyle A. Tucker

REGISTERED  
PROFESSIONAL  
LAND SURVEYOR

OREGON  
June 2, 2010  
JEFFREY S. HSU  
83571

Renewal Date: June 30, 2023

UNION COUNTY  
SURVEYOR  
Date Received 4/8/22  
Date Filed 4/8/22  
Filed By [Signature]  
File Number 007-2022R

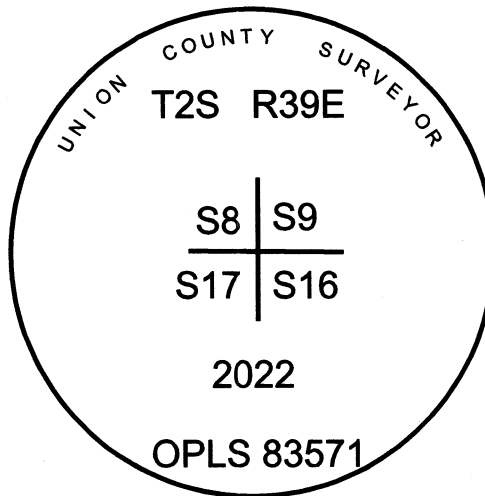

I used a Leica GS18 with RTK in the establishment of the new accessories. Basis of Bearing is as per Survey 009-2022. Bearings and distances are to the center of the aluminum caps.

# HORIZONTAL CONTROL DATA

## UNION COUNTY, OREGON

### OREGON STATE PLANE, NORTH ZONE (3601)

STA NAME: 20220013

SECTION CORNER COMMON TO SECTIONS 8, 9, 16 AND 17

TWP. 2 S RGE. 39 E.

GEODETIC COORD: NAD 83(91)

DATE TIED: April 5, 2022

LAT: 45 ° 23 ' 55.50879 " N

SURVEYOR: JEFFREY S. HSU  
OPLS 83571

LONG: 117 ° 57 ' 10.91261 " W

FIRM: BAGETT, GRIFFITH, & BLACKMAN  
2006 ADAMS AVENUE  
LAGRANDE, OR 97850  
(541) 963-6092

SP. COOR: NAD 83(91)

N: 641783.278 INT FT.

E: 8856201.334 INT FT.

TYPE: GPS

THETA: 1 ° 48 ' 22.59 "

ORDER: SECOND CLASS: 1

SCALE FACTOR: 0.999902624853

ELEV: 2723.09 US FT.

ELEV: DATUM: NGVD 29

**COMMENTS:**

2 ½" aluminum cap 2" above ground surface  
with surrounding mound of stone.

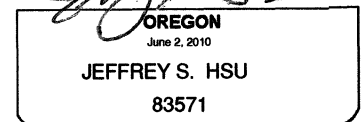
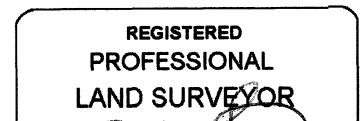
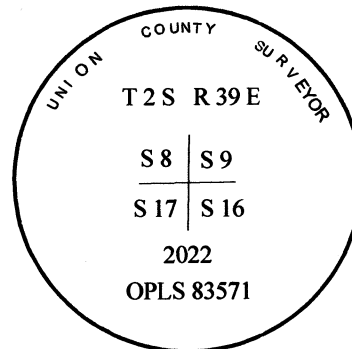

Renewal Date: June 30, 2023

1 METER = 3.2808333333... US FEET = 39.37 INCHES

1 METER = 3.280839895 INT'L FEET OR 1 INCH = 2.54 CM

TO CALCULATE ELEVATION FACTOR ( IN THE NORTH AMERICAN CONTINENT)

DIVIDE 20,906,000 BY (20,906,000 + ELLIPSOID ELEV. IN FEET)

GEOID MODEL : 2012B