

CERTIFIED RECORD OF LAND CORNER MONUMENTATION

HISTORY OF ORIGINAL CORNER ESTABLISHED:

Corner originally established by David P. Thompson under GLO contract number 103 dated September 3rd, 1863. Surveyor General field notes state:
Set post for 1/4 sec. corner in mound of earth with charred stake, pits, trench, as per instructions

In 1888, County Surveyor J.W. Kimbrell found no corner. Union County Old Book Survey No. 65, Pg. 136 states "set post for 1/4 sec. corner"

In Union County Old Book Survey No. 90, Pg. 189, J.W. Kimbrell recovers corner. No description of monument.

T 2 S R 39 E J-07

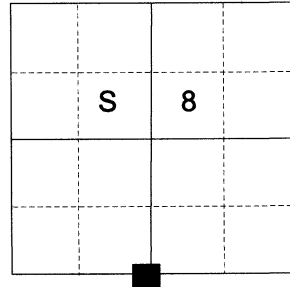

DESCRIPTION OF CORNER EVIDENCE FOUND:

None found. Wood remnants of a post, which could not be definitively identified as the original post due to the amount of decay, were found at 40" beneath the surface.

SEE SURVEY NUMBER 009-2022

DESCRIPTION OF MONUMENT AND ACCESSORIES I ESTABLISHED TO MONUMENT THE ORIGINAL LOCATION OF THIS CORNER:

At position by survey I set a 2 1/2" aluminum pipe, 48" in the ground, with 2 1/2" aluminum cap marked as shown below, from which:

NEW BEARING OBJECTS:

A 5/8" x 30" iron pin bears North 55°29' East a dist. of 15.73 ft., with 1 1/2" aluminum cap marked UNION COUNTY SURVEYOR NE RP.

A 5/8" x 30" iron pin bears South 52°15' East a dist. of 13.52 ft., with 1 1/2" aluminum cap marked BGB SURVEYORS SE RP.

A 5/8" x 30" iron pin bears South 54°28' West a dist. of 12.55 ft., with 1 1/2" aluminum cap marked BGB SURVEYORS SW RP.

A 5/8" x 30" iron pin bears North 50°16' West a dist. of 8.30 ft., with 1 1/2" aluminum cap marked UNION COUNTY SURVEYOR NW RP.

Set steel fencepost approx. 0.5 West

I hereby certify that the corner was monumented on March 30, 2022.

Witness: Kyle A. Tucker

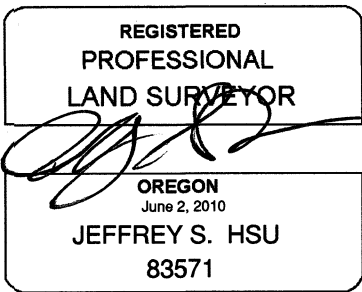

Renewal Date: June 30, 2023

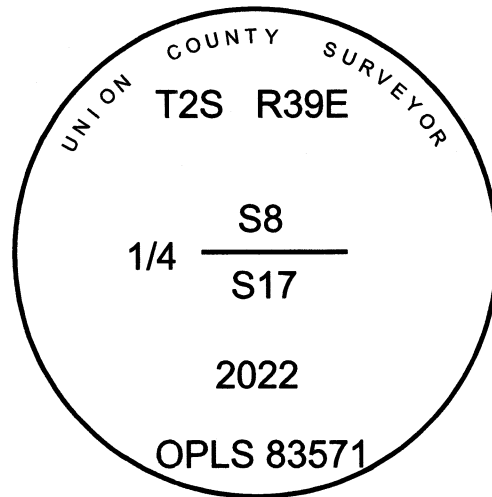

UNION COUNTY SURVEYOR
Date Received 4/8/22
Date Filed 4/8/22
Filed By [Signature]
File Number 006-2022R

I used a Leica GS18 with RTK in the establishment of the new accessories. Basis of Bearing is as per Survey 009-2022. Bearings and distances are to the center of the aluminum caps.

HORIZONTAL CONTROL DATA

UNION COUNTY, OREGON

OREGON STATE PLANE, NORTH ZONE (3601)

STA NAME: 20220015

1/4 SECTION CORNER COMMON TO SECTIONS 8 AND 17

TWP. 2 S RGE. 39 E.

GEODETIC COORD: NAD 83(91)

DATE TIED: April 5, 2022

LAT: 45 ° 23 ' 55.50709 " N

SURVEYOR: JEFFREY S. HSU
OPLS 83571

LONG: 117 ° 57 ' 47.84793 " W

FIRM: BAGETT, GRIFFITH, & BLACKMAN
2006 ADAMS AVENUE
LAGRANDE, OR 97850
(541) 963-6092

SP. COOR: NAD 83(91)

N: 641700.208 INT FT.

E: 8853567.326 INT FT.

TYPE: GPS

THETA: 1 ° 47 ' 56.39 "

ORDER: SECOND CLASS: 1

SCALE FACTOR: 0.99990262482

ELEV: 2735.15 US FT.

ELEV: DATUM: NGVD 29

COMMENTS:

2 1/2" aluminum cap 18" below ground surface
with steel fence post 0.5 feet West of monument.

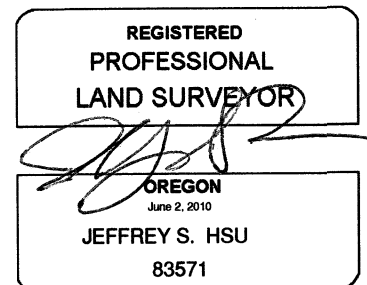
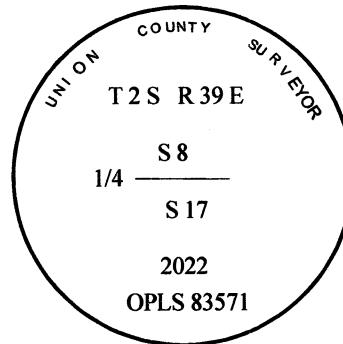

Renewal Date: June 30, 2023

1 METER = 3.280833333... US FEET = 39.37 INCHES

1 METER = 3.280839895 INT'L FEET OR 1 INCH = 2.54 CM

TO CALCULATE ELEVATION FACTOR (IN THE NORTH AMERICAN CONTINENT)

DIVIDE 20,906,000 BY (20,906,000 + ELLIPSOID ELEV. IN FEET)

GEOID MODEL : 2012B