

CERTIFIED RECORD OF LAND CORNER MONUMENTATION

HISTORY OF ORIGINAL CORNER ESTABLISHED:

Corner originally established by David P. Thompson under GLO contract number 103 dated September 3rd, 1863. Surveyor General field notes state:
Set post for 1/4 sec. corner in mound of earth with charred stake, pits, trench as per inst.

In 1889, County Surveyor J.W. Kimbrell found no trace of the original corner. Union County Old Book Survey No. 90, Pg. 189 states "Set stone 6x9x20 for 1/4 sec. cor. bet. secs. 8 & 9"

T 2 S R 39 E G-09

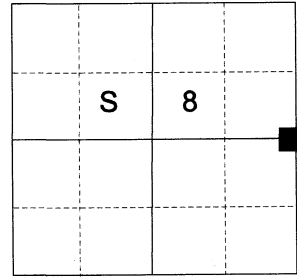

DESCRIPTION OF CORNER EVIDENCE FOUND:

None Found

SEE SURVEY NUMBER 009-2022

DESCRIPTION OF MONUMENT AND ACCESSORIES I ESTABLISHED TO MONUMENT THE ORIGINAL LOCATION OF THIS CORNER:

At position by survey, I set a 2 1/2" aluminum pipe, 54" in the ground, with 2 1/2" aluminum cap marked as shown below, from which:

NEW BEARING OBJECTS:

A 5/8" x 30" iron pin bears North 62°13' East a dist. of 14.29 ft., with 1 1/2" aluminum cap marked BGB SURVEYORS NE RP.

A 3/4" bolt in the Northwestern corner of a pivot sprinkler concrete base bears South 29°07' East a dist. of 11.90 ft., marked SE + RP in the top of the bolt.

A 5/8" x 30" iron pin bears South 21°28' West a dist. of 10.55 ft., with 1 1/2" aluminum cap marked BGB SURVEYORS SW RP.

A 5/8" x 30" iron pin bears North 2°29' West a dist. of 16.17 ft., with 1 1/2" aluminum cap marked BGB SURVEYORS NW RP.

Monument falls Northwest of concrete pivot pad

I hereby certify that the corner was monumented on March 30, 2022.
Witness: Kyle A. Tucker

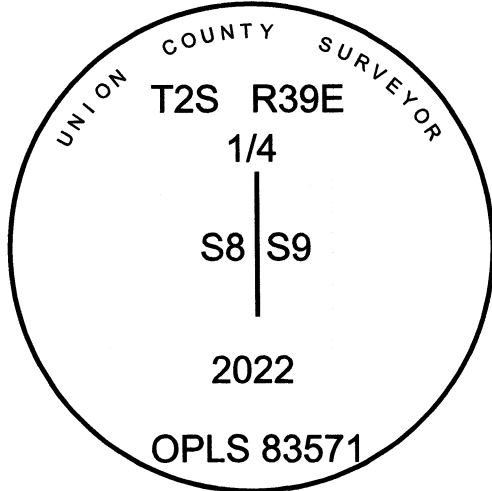

UNION COUNTY SURVEYOR
Date Received 4/8/22
Date Filed 4/8/22
Filed By [Signature]
File Number 005-2022R

I used a Leica GS18 with RTK in the establishment of the new accessories. Basis of Bearing is as per Survey 009-2022. Bearings and distances are to the center of the aluminum caps or the + in the top of the bolt.

HORIZONTAL CONTROL DATA
UNION COUNTY, OREGON
OREGON STATE PLANE, NORTH ZONE (3601)

STA NAME: 20220014

1/4 SECTION CORNER COMMON TO SECTIONS 8 AND 9

TWP. 2 S RGE. 39 E.

GEODETIC COORD: NAD 83(91)

DATE TIED: April 5, 2022

LAT: 45 ° 24 ' 21.68369 " N

SURVEYOR: JEFFREY S. HSU
OPLS 83571

LONG: 117 ° 57 ' 10.42550 " W

FIRM: BAGETT, GRIFFITH, & BLACKMAN
2006 ADAMS AVENUE
LAGRANDE, OR 97850
(541) 963-6092

SP. COOR: NAD 83(91)

N: 644433.963 INT FT.

E: 8856152.510 INT FT.

TYPE: GPS

THETA: 1 ° 48 ' 22.93 "

ORDER: SECOND CLASS: 1

SCALE FACTOR: 0.999903141672

ELEV: 2720.52 US FT.

ELEV: DATUM: NGVD 29

COMMENTS:

2 ½" aluminum cap 24" below ground surface
approximately 12 ft Northwest of concrete
pivot pad.

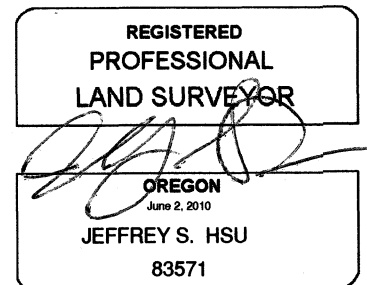
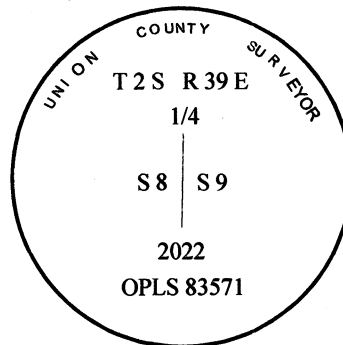

Renewal Date: June 30, 2023

1 METER = 3.2808333333... US FEET = 39.37 INCHES

1 METER = 3.280839895 INT'L FEET OR 1 INCH = 2.54 CM

TO CALCULATE ELEVATION FACTOR (IN THE NORTH AMERICAN CONTINENT)

DIVIDE 20,906,000 BY (20,906,000 + ELLIPSOID ELEV. IN FEET)

GEOID MODEL : 2012B