

CERTIFIED RECORD OF LAND CORNER MONUMENTATION

History of original corner establishment:

Original corner established in 1863 by T. Davenport under Contract No. 102.

Set post in mound of earth with charred stake pits trench.

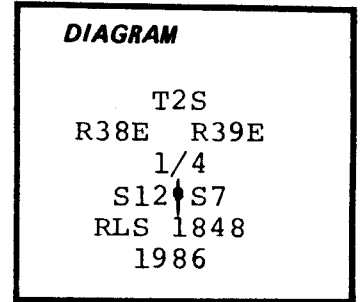

Description of corner evidence found:

No original evidence was recovered. County Road notes for County Road No. 130 indicated they surveyed in 1/4, 1/2, 3/4, and mile increments so one must assume they were retracing the section and subdivisional lines of the sections for the County road surveys. County road notes for Road No. 123 started at the SE corner of the NE 1/4 Section 25, T2S, R38E and went due North along the Township line (? Range line) 5 1/2 miles.

Description of monument and accessories I established to perpetuate the original location of this corner:

At the centerline intersection of County Roads No. 123 and 130 I set a 5/8 inch by 30 inch iron rod with a 1 1/2 inch diameter aluminum cap 4 inches below the gravel surface of the road and stamped it as shown in the above diagram.

I hereby certify the above corner point was perpetuated as hereon described on April 20, 1986.

UNION COUNTY SURVEYOR

Date Received 5-1-86

Date Filed 5-2-86

By G. LANGLITZ DEPUTY

File No. 25-86 R

REGISTERED PROFESSIONAL LAND SURVEYOR

B. A. Sutton

OREGON
JULY 13, 1979
B. A. SUTTON
1848

SEE SURVEY 16-86

Office of..... County of.....

State of....., I hereby certify that the within instrument was filed in this office for record on the..... day of....., 19.....

..... by

(COUNTY OFFICIAL) (DEPUTY)

HORIZONTAL CONTROL DATA

UNION COUNTY, OREGON
OREGON STATE PLANE, NORTH ZONE (3601)

STA. NAME: 9208

QUARTER SECTION: E 1/4 COR

SEC. 12 TWP 2 S RGE 38 E

DATE SURVEYED: MAY, 19, 1992

SURVEYOR: WALTER L. CASWELL
PLS 737

FIRM: EAGLE GPS SURVEY CORP
13545 NW SCIENCE PARK DR
PORTLAND, OR. 97229
(503) 643-1073

TYPE: GPS

ORDER: SECOND CLASS: 1

GEODETIC COOR: NAD 83(91)

LAT: 45 24'21.22153" N

LONG: 117 59'37.54443" W

SP. COOR: NAD 83(91)

N: 644058.994 Int.Ft.

E: 8845663.570 Int.Ft.

THETA: 1 46'38.599"

SCALE FACTOR: 0.999903132

ELEV: 2771.84 US.Ft.

ELEV. DATUM: NGVD 29

DIRECTIONS "TO REACH"

From Island City, at the Intersection of First and McAlister, take Highway 82 heading North towards Elgin. Shortly after leaving the intersection of First and McAlister you will cross a bridge over the Grande Ronde River. From this bridge travel out Highway 82 about 5.20 miles to where Stanley Lane takes off to the left and Alicel Lane takes off to the right. From this intersection, take Stanley Lane and travel West about 0.55 miles to the intersection of Stanley Lane and Sand Ridge Road. The corner is in the middle of this intersection in a water valve box.

GEODETIC CONTROL DATA

OREGON STATE PLANE, NORTH ZONE (3601)
UNION COUNTY, OREGON

STA. NAME: 9208

QUARTER CORNER
T2S SEC.12 | 6 T2S
R38E R39E
UNION COUNTY, OREGON
DATE TIED: JULY, 1999

GEODETIC COOR: NAD 83(91)

LAT: 45:24'21.22153" N

LONG: 117:59'37.54443" W

SURVEYOR: WALTER L. CASWELL
PLS 737

SP. COOR: NAD 83(91)

N: 644058.994 INT.FT

FIRM: EAGLE GPS SURVEY CORP
6110 SW LOMBARD AVE.
BEAVERTON, OR. 97008-4736
(503) 643-1073

E: 8845663.570 INT.FT.

THETA: 1:46'38.599"

TYPE: GPS

SCALE FACTOR: 0.999903132

ORDER: SECOND CLASS: 1

ELEV: 2771.84 U.S.FT.

ELEV. DATUM: NGVD 1929(1947)

DIRECTIONS "TO REACH":

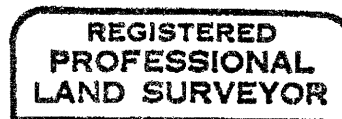

Albert Hertel 10-14-99

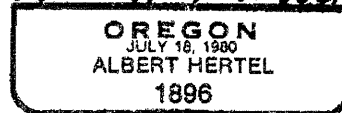

EXPIRES: 06/30/01

1 METER = 3.280833... U.S. FEET = 39.37 INCHES EXACTLY
1 METER = 3.280839895 INTL. FEET OR 1 INCH = 2.54CM. EXACTLY
TO CALCULATE ELEVATION FACTOR (IN THE NORTH AMERICAN CONTINENT)
DIVIDE 20,906,000 BY (20,906,000 + ELLIPSOID ELEV. IN FEET)

JOB 99-005
SHEET 7 OF 63