

CERTIFIED RECORD OF LAND CORNER MONUMENTATION

HISTORY OF ORIGINAL CORNER ESTABLISHED:

Corner originally established by David P. Thompson under GLO contract number 103 dated September 3rd, 1863. Surveyor General field notes state:
Set post for corner to secs. 4,5,8,&9 in mound of earth with charred stake pits, trench, as per instructions

T 2 S R 39 E E-09

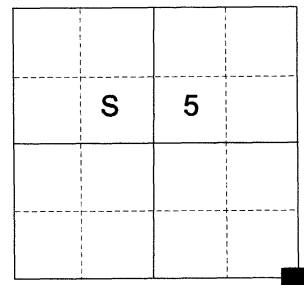

In 1889 County Surveyor J.W. Kimbrell, in performance of Union County Old Book Survey No. 90, Pg. 186 found the original corner. No description of the corner stated.

DESCRIPTION OF CORNER EVIDENCE FOUND:

None found.

SEE SURVEY NUMBER 009-2022

DESCRIPTION OF MONUMENT AND ACCESSORIES I ESTABLISHED TO MONUMENT THE ORIGINAL LOCATION OF THIS CORNER:

At position by survey, I set a 2 1/2" aluminum pipe, 48" in the ground, with 2 1/2" aluminum cap marked as shown below, from which:

NEW BEARING OBJECTS:

A 5/8" x 30" iron pin bears North 56°36' East a dist. of 17.42 ft., with 1 1/2" aluminum cap marked Union County Surveyor NE RP.

A 5/8" x 30" iron pin bears South 51°05' East a dist. of 15.13 ft., with 1 1/2" aluminum cap marked Union County Surveyor SE RP.

A 5/8" x 30" iron pin bears South 61°41' West a dist. of 22.92 ft., with 1 1/2" aluminum cap marked Union County Surveyor SW RP.

A 6" x 6" x 6' galvanized steel post bears North 79°56' West a dist. of 19.99 ft., marked NW + RP on East face of Southerly post of pivot sprinkler stop.

A North/South fence bears West approx. 18 ft.

I hereby certify that the corner was monumented on March 29, 2022.
Witness: Kyle A. Tucker

REGISTERED
PROFESSIONAL
LAND SURVEYOR
[Signature]
OREGON
June 2, 2010
JEFFREY S. HSU
83571

Renewal Date: June 30, 2023

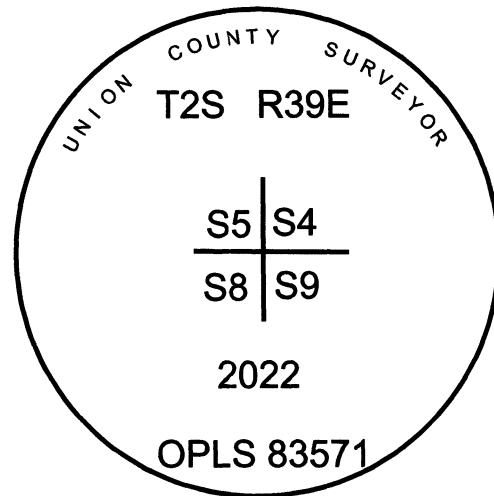

UNION COUNTY
SURVEYOR
Date Received 4/8/22
Date Filed 4/8/22
Filed By *[Signature]*
File Number 004-2022R

I used a Leica GS18 with RTK in the establishment of the new accessories. Basis of Bearing is as per Survey 009-2022. Bearings and distances are to the center of the aluminum caps or the + in the steel post.

HORIZONTAL CONTROL DATA
UNION COUNTY, OREGON
OREGON STATE PLANE, NORTH ZONE (3601)

STA NAME: 20220010

SECTION CORNER COMMON TO SECTIONS 4, 5, 8 AND 9

TWP. 2 S RGE. 39 E.

GEODETIC COORD: NAD 83(91)

DATE TIED: April 5, 2022

LAT: 45 ° 24 ' 47.85816 " N

SURVEYOR: JEFFREY S. HSU
OPLS 83571

LONG: 117 ° 57 ' 9.93812 " W

FIRM: BAGETT, GRIFFITH, & BLACKMAN
2006 ADAMS AVENUE
LAGRANDE, OR 97850
(541) 963-6092

SP. COOR: NAD 83(91)

N: 647084.609 INT FT.

E: 8856103.697 INT FT.

TYPE: GPS

THETA: 1 ° 48 ' 23.28 "

ORDER: SECOND CLASS: 1

SCALE FACTOR: 0.999903674599

ELEV: 2715.58 US FT.

ELEV: DATUM: NGVD 29

COMMENTS:

2 ½" aluminum cap 18" below surface with N-S
fenceline approximately 18 ft. West of monument.

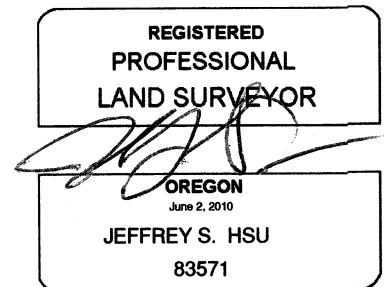
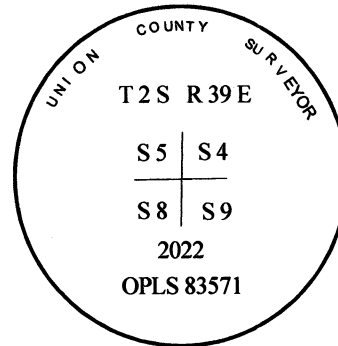

Renewal Date: June 30, 2023

1 METER = 3.280833333... US FEET = 39.37 INCHES

1 METER = 3.280839895 INT'L FEET OR 1 INCH = 2.54 CM

TO CALCULATE ELEVATION FACTOR (IN THE NORTH AMERICAN CONTINENT)

DIVIDE 20,906,000 BY (20,906,000 + ELLIPSOID ELEV. IN FEET)

GEOID MODEL : 2012B