

**CERTIFIED RECORD OF LAND CORNER MONUMENTATION**

**HISTORY OF ORIGINAL CORNER ESTABLISHED:**

Corner originally established by David P. Thompson under GLO contract number 103 dated September 3rd, 1863. Surveyor General field notes state:  
Set post for 1/4 sec. corner in mound of earth with charred stake, pits, trench, as per instructions

In 1889 County Surveyor J.W. Kimbrell found no trace of the original corner. Union County Old Book Survey No. 90, Pg. 186 states "Found no 1/4 sec. corner, Set stake for 1/4 sec. cor. bet. secs. 5 & 8"

T 2 S R 39 E E-07

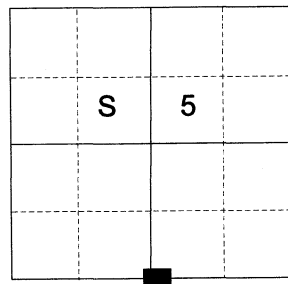

**DESCRIPTION OF CORNER EVIDENCE FOUND:**

None found. Position falls in a concrete pivot pad.

SEE SURVEY NUMBER 009-2022

**DESCRIPTION OF MONUMENT AND ACCESSORIES I ESTABLISHED TO MONUMENT THE ORIGINAL LOCATION OF THIS CORNER:**

At position by survey, I set a 5/8" x 30" iron pin, 30" in the concrete pivot sprinkler pad, with 2" aluminum cap flush with the concrete and marked as shown below, from which:

**NEW BEARING OBJECTS:**

A 5/8" x 30" iron pin bears North 26°37' East a dist. of 16.56 ft., with 1 1/2" aluminum cap marked UNION COUNTY SURVEYOR NE RP.

A 5/8" x 30" iron pin bears South 44°55' East a dist. of 10.55 ft., with 1 1/2" aluminum cap marked UNION COUNTY SURVEYOR SE RP.

A 5/8" x 30" iron pin bears South 34°34' West a dist. of 9.92 ft., with 1 1/2" aluminum cap marked UNION COUNTY SURVEYOR SW RP.

A 5/8" x 30" iron pin bears North 23°32' West a dist. of 10.60 ft., with 1 1/2" aluminum cap marked UNION COUNTY SURVEYOR NW RP (falls on North edge approx. 1 ft. East of Northwest corner of concrete pivot sprinkler pad).

I hereby certify that the corner was monumented on March 29, 2022.  
Witness: Kyle A. Tucker



Renewal Date: June 30, 2023

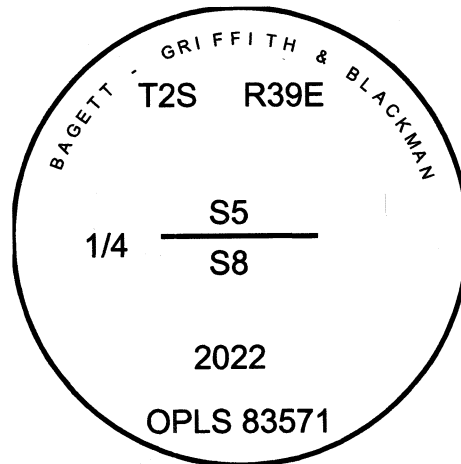
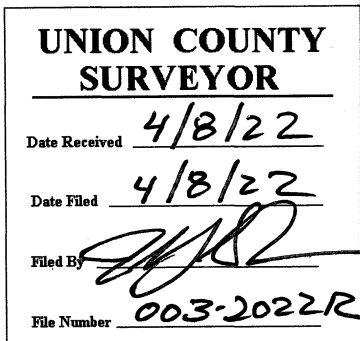

I used a Leica GS18 with RTK in the establishment of the new accessories. Basis of Bearing is as per Survey 009-2022. Bearings and distances are to the center of the aluminum caps.

**HORIZONTAL CONTROL DATA**  
**UNION COUNTY, OREGON**  
**OREGON STATE PLANE, NORTH ZONE (3601)**

STA NAME: 20220009

1/4 SECTION CORNER COMMON TO SECTIONS 5 AND 8

TWP. 2 S RGE. 39 E.

GEODETIC COORD: NAD 83(91)

DATE TIED: April 5, 2022

LAT: 45 ° 24 ' 47.86130 " N

SURVEYOR: JEFFREY S. HSU  
OPLS 83571

LONG: 117 ° 57 ' 47.26494 " W

FIRM: BAGETT, GRIFFITH, & BLACKMAN  
2006 ADAMS AVENUE  
LAGRANDE, OR 97850  
(541) 963-6092

SP. COOR: NAD 83(91)

N: 647001.164 INT FT.

E: 8853442.435 INT FT.

TYPE: GPS

THETA: 1 ° 47 ' 56.81 "

ORDER: SECOND CLASS: 1

SCALE FACTOR: 0.999903674664

ELEV: 2732.86 US FT.

ELEV: DATUM: NGVD 29

**COMMENTS:**

5/8" iron pin with 2" aluminum cap in abandoned concrete pivot pad, marked as shown, set flush with said pad.

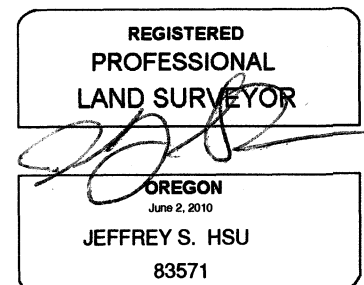
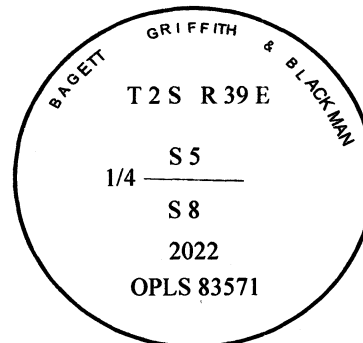

Renewal Date: June 30, 2023

1 METER = 3.2808333333... US FEET = 39.37 INCHES

1 METER = 3.280839895 INT'L FEET OR 1 INCH = 2.54 CM

TO CALCULATE ELEVATION FACTOR ( IN THE NORTH AMERICAN CONTINENT)

DIVIDE 20,906,000 BY (20,906,000 + ELLIPSOID ELEV. IN FEET)

GEOID MODEL : 2012B