

**CERTIFIED RECORD OF LAND CORNER MONUMENTATION**

**HISTORY OF ORIGINAL CORNER ESTABLISHMENT:**

Corner originally established by David P. Thompson under GLO contract number 103, dated September 3, 1863. Surveyor General records states:  
Set post in mound of earth with charcoal stakes and pits as per instructions.

Old Book Survey 118, Page 261, dated 1890, calls monument 947.4 ft. an angle of 75°05' off railroad tracks

James G. Voelz found unmarked stone with Survey No. 9-74 and did not accept it as a section corner.

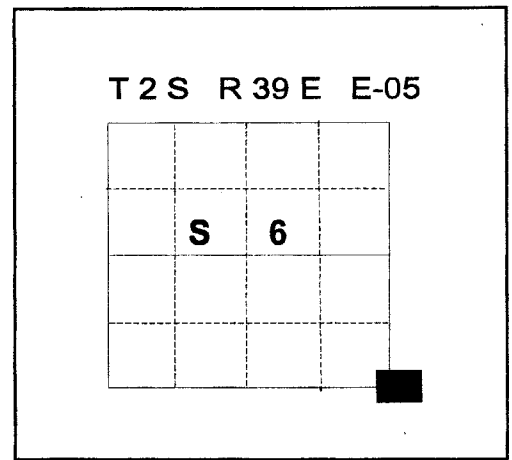

**DESCRIPTION OF CORNER EVIDENCE FOUND:**

Found 5"x 7"x 12" stone 4 feet deep with chisel marks, at position of stone found by Survey No. 9-74, 947.44 feet from centerline of RR tracks, which is very harmonious with Old Book Page 261 tie of 947.40 feet.

See Survey 011-2000

**DESCRIPTION OF MONUMENT AND ACCESSORIES I ESTABLISHED**

**TO PERPETUATE THE ORIGINAL LOCATION OF THIS CORNER:**

At the position of found stone, I set a 2 ½ x 30" aluminum monument with cap marked as shown below, 36" in the ground. Stone is buried North of monument from which;

**NEW BEARING OBJECTS:**

A 5/8"x 30" Iron rebar with aluminum cap bears N60°31'03"E, 20.83 feet, marked NE RP, 12" below surface.

A 5/8"x 30" Iron rebar with aluminum cap bears S50°36'56"E, 20.03 feet, marked SE RP, 12" below surface.

A 5/8"x 30" Iron rebar set by Survey No. 9-74 bears S89°36'33"W, 22.60 feet.

A P.K. nail 1 foot above ground in Power Pole #036079999 bears N27°37'33"W, 37.30 feet,

I hereby certify that the corner was monumented on March 21, 2000.  
Witness: Norbert Volny and Greg T. Blackman Jr.

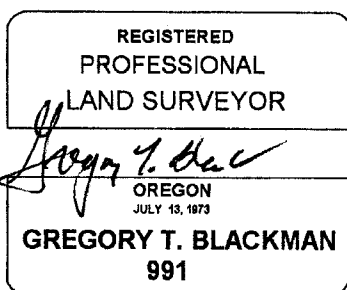

Renewal Date: Dec. 31, 2001

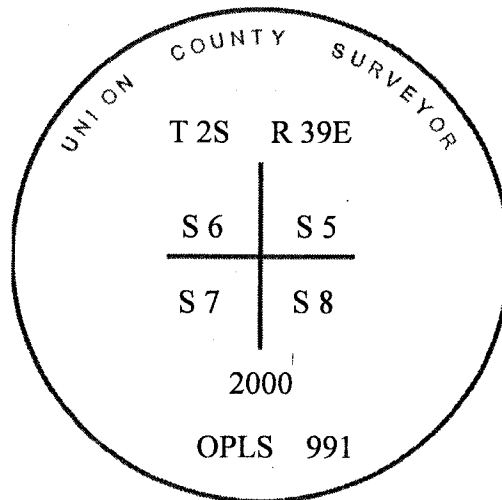

**UNION COUNTY SURVEYOR**

Date Received 7/13/00

Date Filed 7/15/00

Filed By R. ROBINSON, DEPUTY

File Number 007-2000 R

I used a Leica TCA 1100 total station and circular prism in the establishment of the new accessories. The basis of bearing is the same as that used in Survey Number 011-2000, the distances are to center of aluminum cap, unless otherwise noted.

**CONFIRMED RECORD OF LAND CORNER MONUMENTATION**

**HISTORY OF ORIGINAL CORNER ESTABLISHMENT:**

Corner originally established by David P. Thompson under GLO contract number 103, dated September 3, 1863. Surveyor General records states: Set post in mound of earth with charcoal stakes and pits as per instructions.

Old Book Survey 118, Page 261, dated 1890, calls monument 947.4 ft. an angle of 75 05' off railroad tracks

James G. Voelz found unmarked stone with Survey No. 9-74 and did not accept it as a section corner.

See Survey 011-2000

Greg T. Blackman Found 5"x 7"x 12" stone 4 feet deep with chisel marks with Survey 011-2000, at position of stone found by Survey No. 9-74, 947.44 feet from centerline of RR tracks, which is very harmonious with Old Book Page 261 tie of 947.40 feet. At the found stone position, a 2 1/2" aluminum monument with cap marked as shown below, was set 36" in the ground from which;

A 5/8"x 30" Iron rebar with aluminum cap bears N60°31'03"E, 20.83 feet, marked NE RP, 12" below surface.

A 5/8"x 30" Iron rebar with aluminum cap bears S50°36'56"E, 20.03 feet, marked SE RP, 12" below surface.

A 5/8"x 30" Iron rebar set by Survey No. 9-74 bears S89°36'33"W, 22.60 feet.

A P.K. nail 1 foot above ground in Power Pole #036079999 bears N27°37'33"W, 37.30 feet (Not found)

**DESCRIPTION OF CORNER EVIDENCE FOUND:**

Found 2 1/2" aluminum monument with cap marked as shown, 36" in the ground along with three references monuments as follows;

A 5/8"x 30" Iron rebar with aluminum cap bears N60°31'03"E, 20.83 feet, marked NE RP, 12" below surface.

A 5/8"x 30" Iron rebar with aluminum cap bears S50°36'56"E, 20.03 feet, marked SE RP, 12" below surface.

A 5/8"x 30" Iron rebar set by Survey No. 9-74 bears S89°36'33"W, 22.60 feet.

**DESCRIPTION OF MONUMENT AND ACCESSORIES I ESTABLISHED TO PERPETUATE THE ORIGINAL LOCATION OF THIS CORNER:**

Using the monument set by Survey 011-2000 I set new bearing objects.

**NEW BEARING OBJECTS:**

A P.K. nail 1 foot above ground in Power Pole #036079998 bears S15°W, 85.80 feet,

I hereby certify that the corner was monumented on October 3, 2011.

Witness: Jeff Hsu and Greg T. Blackman Jr.

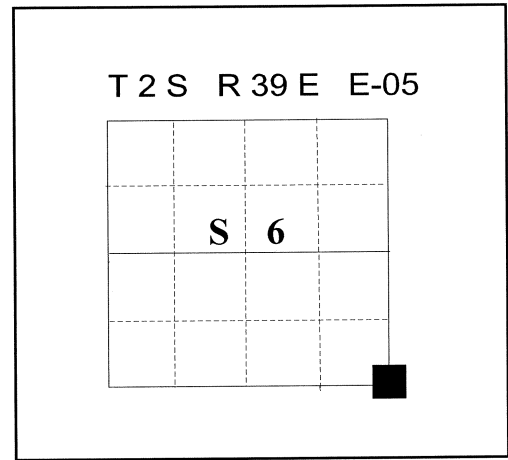

REGISTERED  
PROFESSIONAL  
LAND SURVEYOR

*Rick G. Robinson*  
OREGON  
July 17, 1986  
RICK G. ROBINSON  
2219

Renewal Date: December 31, 2012

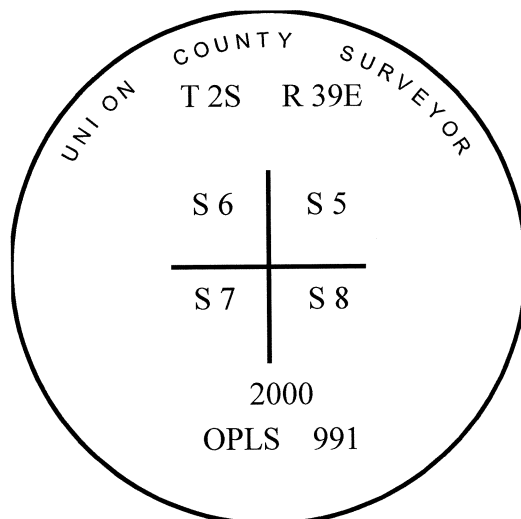

**UNION COUNTY  
SURVEYOR**

Date Received 11/17/2011  
Date Filed 11/17/11  
Filed By *Greg T. Blackman*  
File Number 042-2011R

I used a steel tape and magnetic compass in the establishment of the new accessories. I used 16° East declination, the distances are to center of aluminum cap, unless otherwise noted.

# HORIZONTAL CONTROL DATA

## UNION COUNTY, OREGON

### OREGON STATE PLANE, NORTH ZONE (3601)

STA NAME: 201107

SECTION CORNER COMMON TO SECTIONS: 5, 6, 7 and 8

TWP. 2 S. RGE. 39 E.

GEODETIC COORD: NAD 83(91)

DATE TIED: October 3, 2011

LAT: 45 ° 24 ' 47.86142 " N

SURVEYOR: RICK G. ROBINSON  
OPLS 2219

LONG: 117 ° 58 ' 24.59105 " W

FIRM: BAGETT, GRIFFITH, & BLACKMAN  
2006 ADAMS AVENUE  
LAGRANDE, OR 97850  
(541) 963-6092

SP. COOR: NAD 83(91)

N: 646917.757 INT FT.

E: 8850781.222 INT FT.

TYPE: GPS

THETA: 1 ° 47 ' 30.3368442 "

ORDER: SECOND CLASS: 1

SCALE FACTOR: 0.9999036747

ELEV: 2744.17 US FT.

ELEV: DATUM: NGVD 29

**COMMENTS:**

Corner is 2 1/2"x30" aluminum pipe with  
2 1/2" aluminum cap marked as shown:  
Monument is set 36" in the ground in  
the center of Ingle-Case Road

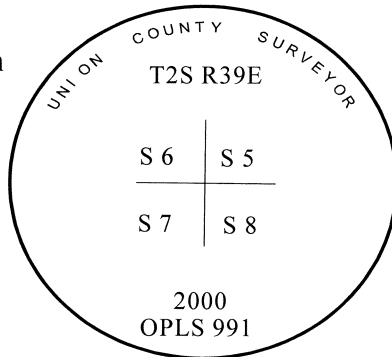

REGISTERED  
PROFESSIONAL  
LAND SURVEYOR

*R.G. Robinson*  
OREGON  
July 17, 1986  
RICK G. ROBINSON  
2219

Renewal Date: December 31, 2012

1 METER = 3.2808333333... US FEET = 39.37 INCHES

1 METER = 3.280839895 INT'L FEET OR 1 INCH = 2.54 CM

TO CALCULATE ELEVATION FACTOR ( IN THE NORTH AMERICAN CONTINENT)

DIVIDE 20,906,000 BY (20,906,000 + ELLIPSOID ELEV. IN FEET)