

CERTIFIED RECORD OF LAND CORNER MONUMENTATION

HISTORY OF ORIGINAL CORNER ESTABLISHMENT:

Corner originally established by David P. Thompson under GLO contract number 103, dated September 3, 1863. Surveyor General records states:

Set a post in mound of earth with charcoal stakes and pits as per instruction.

Old Survey book Page 185 County Surveyor J. Kimbrell on October 7, 1889 set a 5x14x25 stone for the 1/4 corner.

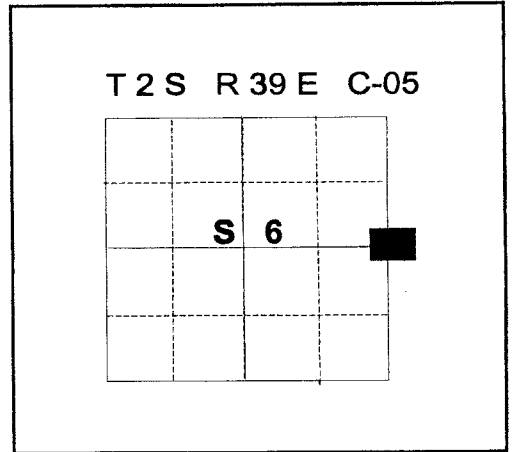

DESCRIPTION OF CORNER EVIDENCE FOUND:

No evidence found

See Survey No.011-2000

DESCRIPTION OF MONUMENT AND ACCESSORIES I ESTABLISHED TO PERPETUATE THE ORIGINAL LOCATION OF THIS CORNER:

At the proportionate position I set a 2 1/2 x 30" aluminum monument with cap marked as shown below, 36" in the ground, from which;

NEW BEARING OBJECTS:

A 5/8x 30" Iron pin with aluminum cap bears N48°E, 25.40 feet, marked NE RP.

A 5/8x 30" Iron pin with aluminum cap bears S61°E, 21.15 feet, marked SE RP.

A 5/8x 30" Iron pin with aluminum cap bears S40°W, 12.87 feet, marked SW RP.

A P.K. nail 1 foot above ground in Power Pole # 036069948 bears N19°W, 50.15 feet,

I hereby certify that the corner was monumented on March 22, 2000.

Witness: Norbert Volny and Greg T. Blackman Jr.

REGISTERED
PROFESSIONAL
LAND SURVEYOR

OREGON
JULY 13, 1973
GREGORY T. BLACKMAN
991

Renewal Date: Dec. 31, 2001

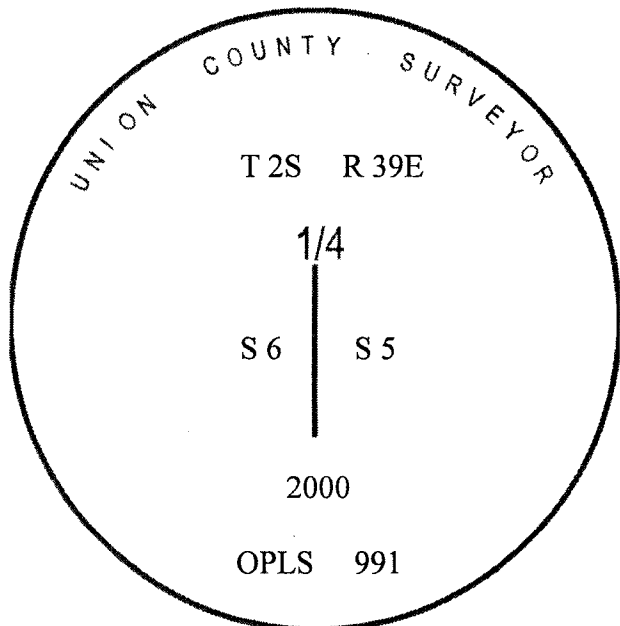

**UNION COUNTY
SURVEYOR**
Date Received 7/13/00
Date Filed 7/15/00
Filed By R. Robinson, Deputy
File Number 005-2000R

I used a compass and steel tape in the establishment of the new accessories. I used 18° East declination, distances are to center of aluminum cap unless otherwise noted.

CONFIRMED RECORD OF LAND CORNER MONUMENTATION

HISTORY OF ORIGINAL CORNER ESTABLISHMENT:

Corner originally established by David P. Thompson under GLO contract number 103, dated September 3, 1863. Surveyor General records states: Set a post in mound of earth with charcoal stakes and pits as per instruction. Old Survey book Page 185 County Surveyor J. Kimbrell on October 7, 1889 set a 5x14x25 stone for the 1/4 corner.

Monumentation record 005-2000R by Greg Blackman states: Set 2 1/2"x30" aluminum monument with cap marked as shown below, 36" in the ground from which:

- A 5/8"x 30" Iron pin with aluminum cap bears N48°E, 25.40 feet, marked NE RP.
- A 5/8"x 30" Iron pin with aluminum cap bears S61°E, 21.15 feet, marked SE RP.
- A 5/8"x 30" Iron pin with aluminum cap bears S40°W, 12.87 feet, marked SW RP.
- A P.K. nail 1 foot above ground in Power Pole #036069948 bears N19°W, 50.15 feet

DESCRIPTION OF CORNER EVIDENCE FOUND:

Found 2 1/2" aluminum monument at corner position
Found 5/8" pin RPs at record position. Power pole in Northwest quadrant has been removed.

See Survey No. 011-2000

DESCRIPTION OF MONUMENT AND ACCESSORIES I ESTABLISHED TO PERPETUATE THE ORIGINAL LOCATION OF THIS CORNER:

From the found a 2 1/2 x 30" aluminum monument;

NEW BEARING OBJECT:

Southeast corner of Seed building #5 bears N45°W, 75.40 feet,

I hereby certify that the corner was recovered on October 3, 2011.

Witness: Jeff Hsu and Greg T. Blackman Jr.

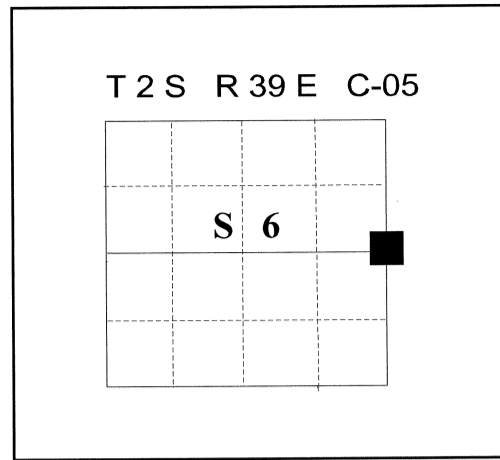

REGISTERED
PROFESSIONAL
LAND SURVEYOR

OREGON
July 17, 1986
RICK G. ROBINSON
2219

Renewal Date: December 31, 2012

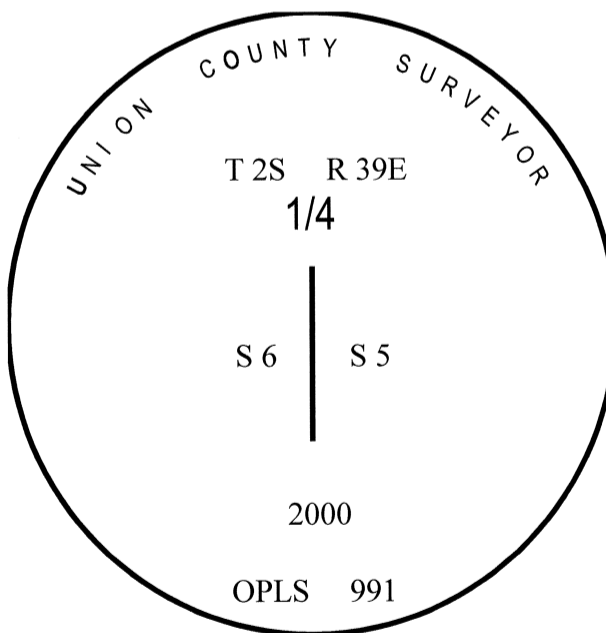

UNION COUNTY SURVEYOR

Date Received 11/17/2011

Date Filed 11/17/11

Filed By Greg T. Blackman

File Number 041-2011R

I used a compass and steel tape in the establishment of the new accessories. I used 16° East declination, distances are to center of aluminum cap unless otherwise noted.

HORIZONTAL CONTROL DATA

UNION COUNTY, OREGON

OREGON STATE PLANE, NORTH ZONE (3601)

STA NAME: 201108

1/4 SECTION CORNER COMMON TO SECTIONS: 5 and 6

TWP. 2 S. RGE. 39 E.

GEODETIC COORD: NAD 83(91)

DATE TIED: October 3, 2011

LAT: 45 ° 25 ' 13.98024 " N

SURVEYOR: RICK G. ROBINSON
OPLS 2219

LONG: 117 ° 58 ' 24.15356 " W

FIRM: BAGETT, GRIFFITH, & BLACKMAN
2006 ADAMS AVENUE
LAGRANDE, OR 97850
(541) 963-6092

SP. COOR: NAD 83(91)

N: 649562.675 INT FT.

E: 8850729.701 INT FT.

TYPE: GPS

THETA: 1 ° 47 ' 30.6471071 "

ORDER: SECOND CLASS: 1

SCALE FACTOR: 0.9999042225

ELEV: 2749.29 US FT.

ELEV: DATUM: NGVD 29

COMMENTS:

Corner is 2 1/2"x30" aluminum pipe with
2 1/2" aluminum cap marked as shown:
Monument is set 36" in the ground

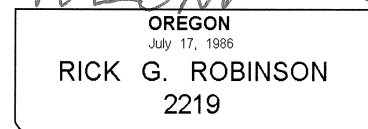
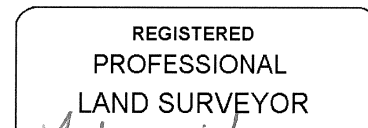
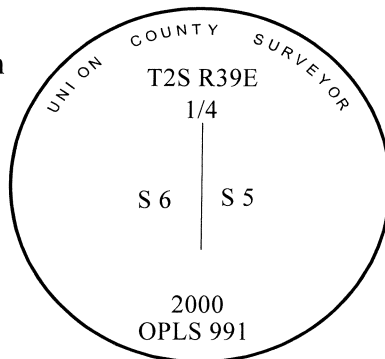

Renewal Date: December 31, 2012

1 METER = 3.2808333333... US FEET = 39.37 INCHES

1 METER = 3.280839895 INT'L FEET OR 1 INCH = 2.54 CM

TO CALCULATE ELEVATION FACTOR (IN THE NORTH AMERICAN CONTINENT)

DIVIDE 20,906,000 BY (20,906,000 + ELLIPSOID ELEV. IN FEET)