

CERTIFIED RECORD OF LAND CORNER MONUMENTATION

HISTORY OF ORIGINAL CORNER ESTABLISHED:

Corner originally established by Timothy Davenport under GLO contract number 102 dated July 20th, 1863. Surveyor General field notes state:
Set qr. sec. post, made mound of earth and drove charred stake as per inst.

In 1889 County Surveyor J.W. Kimbrell found no trace of the original corner. Union County Old Book Survey No. 90, Pg. 186 states "Set stone 8x12x32 for 1/4 sec. cor. bet. sec. 5 & 32"

T 2 S R 39 E A-07

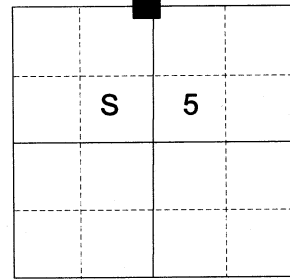

DESCRIPTION OF CORNER EVIDENCE FOUND:

No original monument found. The position falls in the intersection of Janson Ln. and Imbler Rd. Wood remnants of a post, which could not be definitively identified as the original post due to the amount of decay, were found at 34" beneath the surface.

SEE SURVEY NUMBER 009-2022

DESCRIPTION OF MONUMENT AND ACCESSORIES I ESTABLISHED TO MONUMENT THE ORIGINAL LOCATION OF THIS CORNER:

At position by survey, I set a 2 1/2" aluminum pipe, 36" in the ground, with 2 1/2" aluminum cap 6" below the road surface marked as shown below, from which:

NEW BEARING OBJECTS:

A 5/8" x 30" iron pin bears North 32° East a dist. of 44.95 ft., with 1 1/2" aluminum cap marked UNION COUNTY SURVEYOR NE RP.

A power pole bears South 48° East a dist. of 35.40 ft., marked 036055 99.

A power pole bears South 68° West a dist. of 75.75 ft., marked 036055099.

The Southwest corner of a 4" x 4" x 3' telecommunications junction box bears North 24° West a dist. of 64.40 ft., marked L156 ZP8.

I hereby certify that the corner was monumented on March 29, 2022.

Witness: Kyle A. Tucker



Renewal Date: June 30, 2023

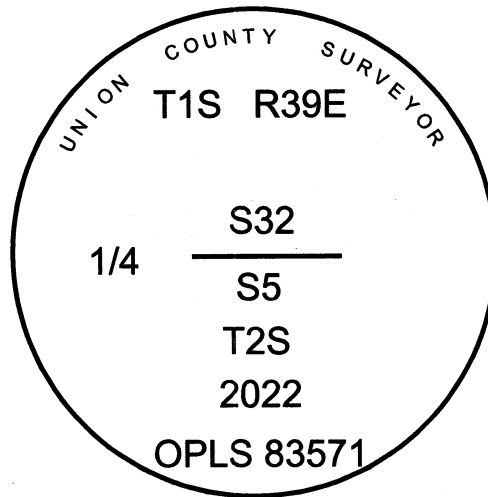

UNION COUNTY SURVEYOR
Date Received 4/8/22
Date Filed 4/8/22
Filed By [Signature]
File Number 001-2022R

I used a steel tape and magnetic compass in the establishment of the new accessories. I used 14° East declination, the distances are to a 60d spike driven into the right side of the power poles. Bearings are to a brass washer marked OPLS 83571 attached to the base of the power poles. Bearing and distance to the telecommunication box is to the most Southeasterly corner at the base. Bearing and distance to the iron pin is to the center of the aluminum cap.

HORIZONTAL CONTROL DATA
UNION COUNTY, OREGON
OREGON STATE PLANE, NORTH ZONE (3601)

STA NAME: 20220012

1/4 SECTION CORNER COMMON TO SECTIONS 5 AND 32

TWP. 1 & 2S RGE. 39 E.

GEODETIC COORD: NAD 83(91)

DATE TIED: April 5, 2022

LAT: 45 ° 25 ' 39.81933 " N

SURVEYOR: JEFFREY S. HSU
OPLS 83571

LONG: 117 ° 57 ' 46.65973 " W

FIRM: BAGETT, GRIFFITH, & BLACKMAN
2006 ADAMS AVENUE
LAGRANDE, OR 97850
(541) 963-6092

SP. COOR: NAD 83(91)

N: 652262.085 INT FT.

E: 8853320.366 INT FT.

TYPE: GPS

THETA: 1 ° 47 ' 57.24 "

ORDER: SECOND CLASS: 1

SCALE FACTOR: 0.99990478032

ELEV: 2737.81 US FT.

ELEV: DATUM: NGVD 29

COMMENTS:

2 ½" aluminum cap 6" below road surface in
centerline of Janson Lane and Imbler Road.

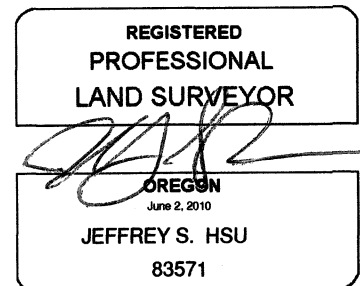
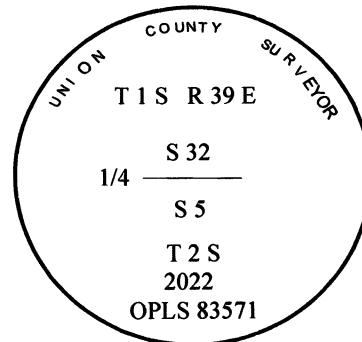

Renewal Date: June 30, 2023

1 METER = 3.2808333333... US FEET = 39.37 INCHES

1 METER = 3.280839895 INT'L FEET OR 1 INCH = 2.54 CM

TO CALCULATE ELEVATION FACTOR (IN THE NORTH AMERICAN CONTINENT)

DIVIDE 20,906,000 BY (20,906,000 + ELLIPSOID ELEV. IN FEET)

GEOID MODEL : 2012B