

CERTIFIED RECORD OF LAND CORNER MONUMENTATION

HISTORY OF ORIGINAL CORNER ESTABLISHMENT:

Corner originally established by Timothy Davenport under GLO contract number 102, dated January 12, 1863. Surveyor General records states: Set a post in mound of earth with charcoal stakes and pits as per instruction. Old Survey book page 185 shows county surveyor J. Kimbrell as finding the post originally established. Old book survey No. 118, page 261 dated 1890 by Curtis, calls the corner 347.3 feet at an angle of 75°34' from RR sta. 459+24

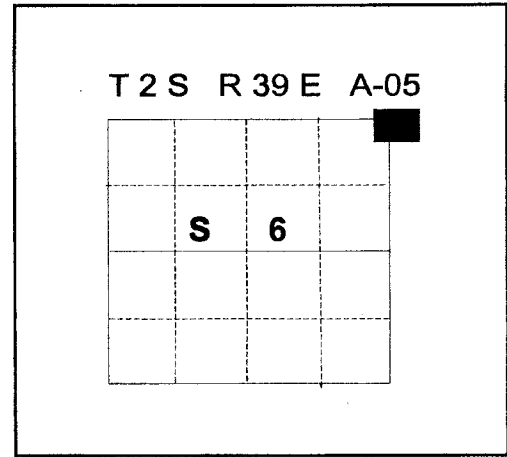

DESCRIPTION OF CORNER EVIDENCE FOUND:

No evidence found.

See Survey No.011-2000

DESCRIPTION OF MONUMENT AND ACCESSORIES I ESTABLISHED TO PERPETUATE THE ORIGINAL LOCATION OF THIS CORNER:

At the position established by Curtis in the old book survey on page 261 and the intersection of Hays road and Jansen Lane, I set a 2 ½ x 30" aluminum monument with cap marked as shown below, 40" in the ground from which;

NEW BEARING OBJECTS:

A 5/8"x 30" Iron rebar with aluminum cap bears N27°23'29"E, 45.89 feet, marked NE RP.

A P.K nail 1 foot above ground in Power Pole #036050199 bears S32°39'40"E, 40.43 feet.

A P.K nail 1 foot above ground in Power Pole #036069999 bears S22°43'49"W, 56.36 feet.

A 5/8"x 30" Iron rebar with aluminum cap bears N37°41'50"W, 22.97 feet, marked NW RP.

I hereby certify that the corner was monumented on March 21, 2000.

Witness: Norbert Volny and Greg T. Blackman Jr.

REGISTERED
PROFESSIONAL
LAND SURVEYOR

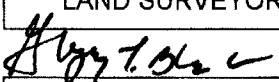

OREGON
JULY 13, 1973
GREGORY T. BLACKMAN
991

Renewal Date: Dec. 31, 2001

**UNION COUNTY
SURVEYOR**

Date Received 7/13/00

Date Filed 7/15/00

Filed By R. Robinson, Deputy

File Number 006-2000R

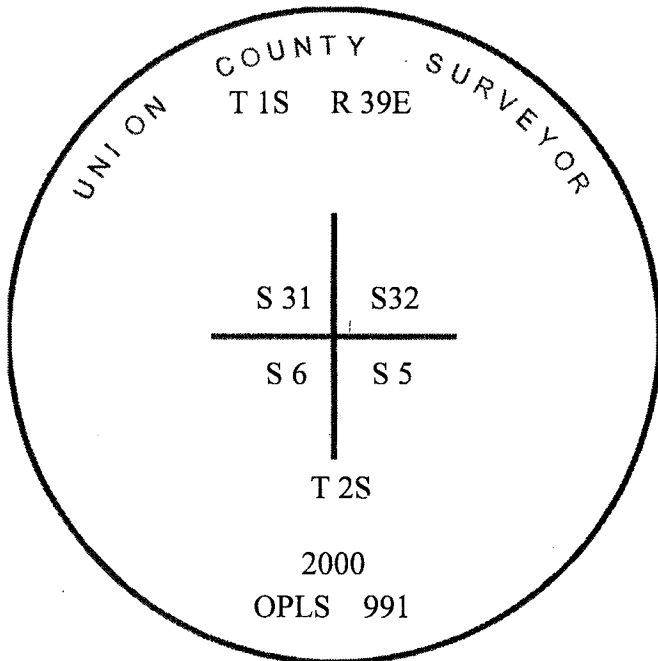

I used a Leica TCA 1100 total station and circular prism in the establishment of the new accessories. The basis of bearing is the same as that used in Old Book Survey page 261, the distances are to center of cap unless otherwise noted.

HORIZONTAL CONTROL DATA

UNION COUNTY, OREGON

OREGON STATE PLANE, NORTH ZONE (3601)

STA NAME: 200901

SECTION CORNER COMMON TO SECTIONS: 31, 32, 5 and 6

TWP. 1 S. RGE. 39 E.
& 2

GEODETIC COORD: NAD 83(91)

DATE TIED: February 11, 2009

LAT: 45 ° 25 ' 39.80419 " N

SURVEYOR: RICK G. ROBINSON
OPLS 2219

LONG: 117 ° 58 ' 23.71939 " W

FIRM: BAGETT, GRIFFITH, & BLACKMAN
2006 ADAMS AVENUE
LAGRANDE, OR 97850
(541) 963-6092

SP. COOR: NAD 83(91)

N: 652177.742 INT FT.

E: 8850678.869 INT FT.

TYPE: GPS

THETA: 1 ° 47 ' 30.9550145 "

ORDER: SECOND CLASS: 1

SCALE FACTOR: 0.99990478

ELEV: 2751.09 US FT.

ELEV: DATUM: NGVD 29

COMMENTS:

Corner is 2 1/2"x30" aluminum pipe with
2 1/2" aluminum cap marked as shown:
Monument is set 10" below surface of the
roadway.

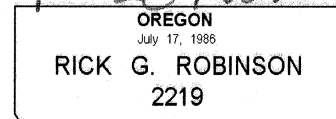
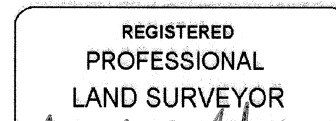
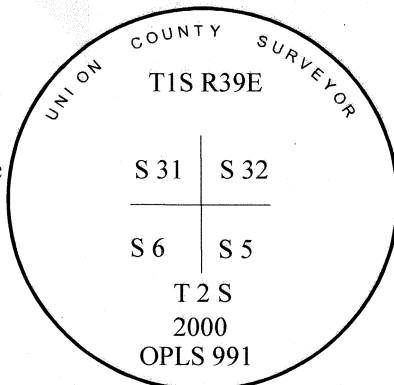

Renewal Date: December 31, 2010

1 METER = 3.2808333333... US FEET = 39.37 INCHES

1 METER = 3.280839895 INT'L FEET OR 1 INCH = 2.54 CM

TO CALCULATE ELEVATION FACTOR (IN THE NORTH AMERICAN CONTINENT)

DIVIDE 20,906,000 BY (20,906,000 + ELLIPSOID ELEV. IN FEET)